

Registration Statement

OF CLAIMANT OF RIGHT TO APPROPRIATE GROUND WATER

TO THE STATE ENGINEER OF OREGON:



I, Nelson Lee Gilmour

of Route 1, Corvallis County of Benton
(Mailing address)

State of Oregon, do hereby make application for a certificate of registration as evidence of a right to appropriate ground water.

1. Source from which water is withdrawn is pump well
(Flowing well, pump well, infiltration trench, or tunnel)

2. Location is: 4 miles northwest of Corvallis
(Approximate distance and direction from nearest city or town)

and is more particularly described as follows:

(a) 1206' S 16° 30' W from NE Corner N 1/4 (or N 1/4 corner)
(Give distance and bearing to corner of section or other legal subdivision)

being within NE 1/4 of N 1/4 of Sec. 29, Twp. 11 S, Rge. 4 W
(Smallest legal subdivision) (N. or S.) (E. or W.)

or (b) within limits of recorded platted property, town or city:

in Lot _____, Block _____ of _____
(Name of plat or addition)

County of Benton
(If within city or town, give name)

3. Construction Work was begun on 1948; was completed on 1948
(Date) (Date)

and the ground water claimed was first used for the purposes set out below on June, 1948
(Date)

since which time the water has been used continuously
(Continuously or intermittently)

from June to Sept.
(Date) (Date)

4. Quantity of water claimed and used is 500 intermittently gallons per minute; 100 acre feet per year.

5. Purpose or Purposes for which water is used irrigation

(Domestic, irrigation, municipal, manufacturing, industrial, etc.)

6. Description of Well: Depth 34 feet. Type drilled
(Dug or drilled)

diameter 10 inches. Elevation of ground at well site 205 feet, mean sea level.
(As near as known)

Depth to water table 16 feet.

7. Capacity of Well: 500 g.p.m. with 2 feet drawdown.

g.p.m. with feet drawdown.

Date of test 1948

If Flowing Well: Measured discharge g.p.m. on _____
(Date)

Shut-in pressure at ground surface _____ lbs. per sq. in. on _____
(Date)

Water is controlled by valves
(Cap, valve, etc.)

Township 11.5 Range 4.00 W.M.
North

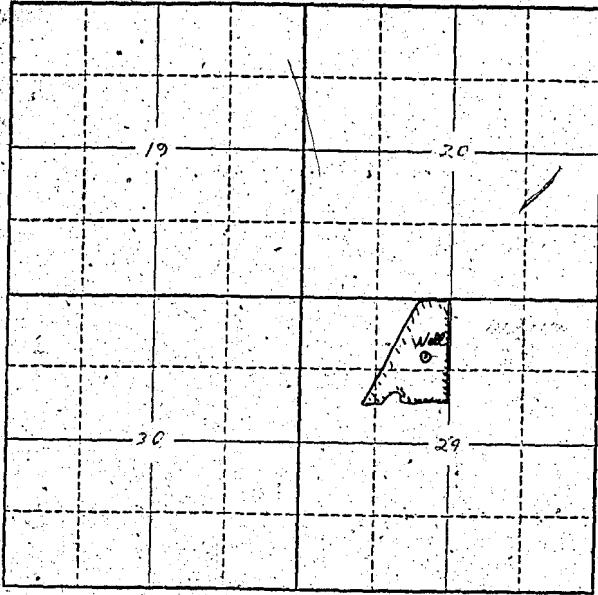

Locate well and acreage of irrigated land on plat.
Scale: 2" = 1 Mile

STATE OF OREGON

County of Marion } ss.

I, Melvin Lee Robinson, being first duly sworn, do hereby certify that I have read the foregoing Registration Statement and that all of the items therein contained are true to the best of my knowledge and belief.

Melvin Lee Robinson
(Signature of Registrant)

Subscribed and sworn to before me this 21st day of July, 1958

My commission expires 8-17-59 Harold Campbell
(Notary Public)

(SEAL)

CERTIFICATE OF REGISTRATION

STATE OF OREGON

County of Marion } ss.

This is to certify that the foregoing Registration Statement was received in the office of the State Engineer on the 31st day of July, 1958, at 8:00 o'clock A.M. and has been duly recorded in said office in Book No. 13 of Registration Statements on page GR-3092

Witness my hand this 16th day of June, 1959

Lewis A. Stanley
(State Engineer)

By _____
(Deputy)

\$16.50