

Registration Statement

OF CLAIMANT OF RIGHT TO APPROPRIATE GROUND WATER

TO THE STATE ENGINEER OF OREGON:

I, Clifford C. Kunkel
of Rt 3 Box 30 Milton-Freewater County of Washoula
(Mailing address)

State of Oregon, do hereby make application for a certificate of registration as evidence of a right to appropriate ground water.

1. Source from which water is withdrawn is Pump well
(Flowing well, pump well, infiltration trench, or tunnel)

2. Location is: 3 1/2 miles NW Milton-Freewater
(Approximate distance and direction from nearest city or town)

and is more particularly described as follows:

(a) 710 feet North + 610 feet East of SW Corner of Sec 27
(Give distance and bearing to corner of section or other legal subdivision)
being within NW 4 of SW 4 of SW 4 of Sec. 27, Twp. 6N, Rge. 3E
(Smallest legal subdivision) (N. or S.) (E. or W.)

or (b) within limits of recorded platted property, town or city:
in Lot , Block of
(Name of plat or addition)

County of
(If within city or town, give name)

3. Construction Work was begun on 1912; was completed on 1912
(Date) (Date)

and the ground water claimed was first used for the purposes set out below on 1912
(Date)

since which time the water has been used Continuously
(Continuously or Intermittently)

from June 1 to Oct 1st
(Date) (Date)

4. Quantity of water claimed and used is 500 gallons per minute; 45 acre feet per year.

5. Purpose or Purposes for which water is used Irrigation

(Domestic, irrigation, municipal, manufacturing, industrial, etc.)

6. Description of Well: Depth 75 feet. Type Dug & Drill 50'
(Dug or drilled)

diameter 72" Dug 8" Drill inches. Elevation of ground at well site 850 feet, mean sea level.
(As near as known)

Depth to water table 30 feet.

7. Capacity of Well: g.p.m. with feet drawdown.

 g.p.m. with feet drawdown.

Date of test No TEST

If Flowing Well: Measured discharge g.p.m. on (Date)

Shut-in pressure at ground surface lbs. per sq. in. on (Date)

Water is controlled by (Cap, valve, etc.)

If log of well is not available, give name and address of driller. Fletcher Smith (Deceased)

11. Infiltration Trench: Covered or open
Dimensions: Length ft. Minimum depth ft. Maximum depth ft.
Bottom width ft. Discharge g.p.m. Date of test

12. Tunnel: Type of lining
Dimensions:
(Length, course, and cross sectional size)
Position of water bearing stratum with reference to portal of tunnel

Log of tunnel: (Preceding table for log of well may be used, if desired. Give footage from portal and character of materials, as pertinent.)

13. Pumping Equipment:

(a) Pump 3" Berkeley Model 36PS Centrifugal Capacity 600 g.p.m.
(Make, type and size)

(b) Motor 3HP Electric
(Type and horsepower)

14. Location of area irrigated or to be irrigated, or place of use if for purposes other than irrigation.

Township North or South	Range E. or W. of Willamette Meridian	Section	Forty-acre Tract	Number Acres To Be Irrigated	Date of Reclamation
6N	35E	27	SW 4 of SW 4	10%	1912

15. If the ground water supply is supplemental to an existing water supply, identification of any application for a permit, permit, certificate or adjudicated right to appropriate water made or held by the registrant.
Surplus right Pleasant View Ditch

Township 6 N Range 35 E, W.M.
North

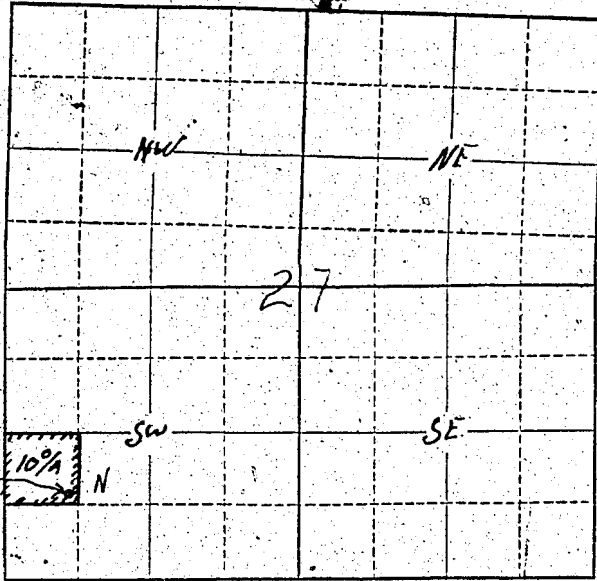

Well Location
710 feet North
& 610 feet East
of SW Corner
of Section 27

Locate well and acreage of irrigated land on plat.

Scale: $\frac{2''}{4''} = 1 \text{ Mile}$

STATE OF OREGON

County of Umatilla } ss.

I, Clifford C. Karker, being first duly sworn, do hereby certify that I have read the foregoing Registration Statement and that all of the items therein contained are true to the best of my knowledge and belief.

Clifford C. Karker
(Signature of Registrant)

Subscribed and sworn to before me this 29th day of July, 1958

My commission expires October 6th, 1960

[Signature]
(Notary Public) for Oregon

(SEAL)

CERTIFICATE OF REGISTRATION

STATE OF OREGON

County of Marion } ss.

This is to certify that the foregoing Registration Statement was received in the office of the State Engineer on the 31st day of July, 1958, at 2:00 o'clock A. M. and has been duly recorded in said office in Book No. 13 of Registration Statements on page GR 3101

Witness my hand this 16th day of June, 1959

[Signature]
(State Engineer)

By _____
(Deputy)

#15.00

GR - 3101