

Registration Statement

OF CLAIMANT OF RIGHT TO APPROPRIATE GROUND WATER

TO THE STATE ENGINEER OF OREGON:

I, Evelyn I. Whitmore

of Route 4, Box 429-B-1 Medford, County of Jackson

(Mailing address)

State of Oregon, do hereby make application for a certificate of registration as evidence of a right to appropriate ground water.

1. Source from which water is withdrawn is Pump Well
(Flowing well, pump well, infiltration trench, or tunnel)

2. Location is: 2 1/2 miles SW of Phoenix, Oregon
(Approximate distance and direction from nearest city or town)

and is more particularly described as follows:

(a) 115 feet North and 355 feet East from the S¹ corner Section 17
(Give distance and bearing to corner of section or other legal subdivision)

being within SW¹ SE¹ of Sec. 17, Twp. 38 S., Rge. 1 W.
(Smallest legal subdivision) (S or S.) (W or W.)

or (b) within limits of recorded platted property, town or city:

in Lot _____, Block _____ of _____
(Name of plat or addition)

County of _____
(If within city or town, give name)

3. Construction Work was begun on June 1951; was completed on June 1951
(Date) (Date)

and the ground water claimed was first used for the purposes set out below on June 1951
(Date)

since which time the water has been used continuously
(Continuously or intermittently)

from June 1951 to present
(Date) (Date)

4. Quantity of water claimed and used is 50 gallons per minute; 34 acre feet per year.

5. Purpose or Purposes for which water is used irrigation

(Domestic, irrigation, municipal, manufacturing, industrial, etc.)

6. Description of Well: Depth 72 feet. Type drilled
(Dug or drilled)

diameter 6.0 inches. Elevation of ground at well site 1750 feet, mean sea level.
(As near as known)

Depth to water table 30 feet.

7. Capacity of Well: _____ g.p.m. with _____ feet drawdown.

_____ g.p.m. with _____ feet drawdown.

Date of test _____

If Flowing Well: Measured discharge _____ g.p.m. on _____
(Date)

Shut-in pressure at ground surface _____ lbs. per sq. in. on _____
(Date)

Water is controlled by _____
(Cap, valve, etc.)

Township 38 S Range 1 W, W.M.

North

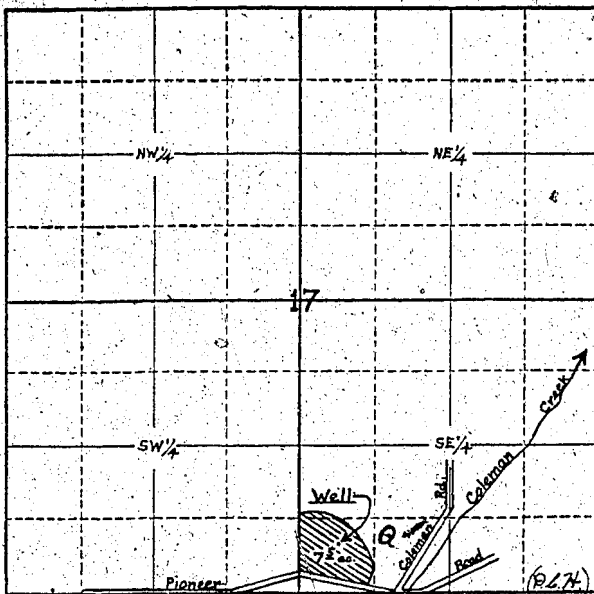

Locate well and acreage of irrigated land on plat.

Scale: 4" = 1 Mile

STATE OF OREGON

County of Jackson

ss.

I, Evelyn I. Whitmore, being first duly sworn, do hereby certify that I have read the foregoing Registration Statement and that all of the items therein contained are true to the best of my knowledge and belief.

Evelyn I. Whitmore
(Signature of Registrant)

Subscribed and sworn to before me this 30th day of July, 1958

My commission expires July 31, 1959

Edith Stewart
(Notary Public)

(SEAL)

CERTIFICATE OF REGISTRATION

STATE OF OREGON

County of Marion

ss.

This is to certify that the foregoing Registration Statement was received in the office of the State Engineer on the 31st day of July, 1958, at 2:00 o'clock A.M. and has been duly recorded in said office in Book No. 13 of Registration Statements on page GR-3110

Witness my hand this 16th day of June, 1959

Lewis A. Stanley
(State Engineer)

By _____ (Deputy)

GR - 3110

150