

# Registration Statement

## OF CLAIMANT OF RIGHT TO APPROPRIATE GROUND WATER

TO THE STATE ENGINEER OF OREGON:

I, Viggo Skou  
of 872 Head Road, Central Point, County of Jackson  
(Mailing address)

State of Oregon, do hereby make application for a certificate of registration as evidence of a right to appropriate ground water.

1. Source from which water is withdrawn is Sump, Ground Water  
(Flowing well, pump well, infiltration trench, or tunnel)

2. Location is: about 1/2 mile east of Central Point, Oregon  
(Approximate distance and direction from nearest city or town)

and is more particularly described as follows:

(a) 300 feet North and 2160 feet East from the SW corner of DLG #55  
(Give distance and bearing to corner of section or other legal subdivision)

being within SW 1/4 NW 1/4 SE 1/4 of Sec. 2, Twp. 37 S., Rge. 2 W.  
(Smallest legal subdivision) (N. or S.) (E. or W.)

or (b) within limits of recorded platted property, town or city:

in Lot \_\_\_\_\_, Block \_\_\_\_\_ of \_\_\_\_\_  
(Name of plat or addition)

County of \_\_\_\_\_  
(If within city or town, give name)

3. Construction Work was begun on April 10, 1946; was completed on Oct. 20, 1949  
(Date) (Date)

and the ground water claimed was first used for the purposes set out below on May 10, 1946  
(Date)

since which time the water has been used continuously  
(Continuously or intermittently)

from May 10, 1946 to present  
(Date) (Date)

4. Quantity of water claimed and used is about 175 gallons per minute; 90 acre feet per year.

5. Purpose or Purposes for which water is used irrigation  
(Domestic, irrigation, municipal, manufacturing, industrial, etc.)

6. Description of Well: Depth \_\_\_\_\_ feet. Type \_\_\_\_\_  
(Dug or drilled)

diameter \_\_\_\_\_ inches. Elevation of ground at well site \_\_\_\_\_ feet, mean sea level.  
(As near as known)

Depth to water table \_\_\_\_\_ feet.

7. Capacity of Well: \_\_\_\_\_ g.p.m. with \_\_\_\_\_ feet drawdown.

\_\_\_\_\_ g.p.m. with \_\_\_\_\_ feet drawdown.

Date of test \_\_\_\_\_

If Flowing Well: Measured discharge \_\_\_\_\_ g.p.m. on \_\_\_\_\_  
(Date)

Shut-in pressure at ground surface \_\_\_\_\_ lbs. per sq. in. on \_\_\_\_\_  
(Date)

Water is controlled by \_\_\_\_\_  
(Cap, valve, etc.)



If log of well is not available, give name and address of driller. ....

11. **Infiltration Trench:** Covered or open open .....

Dimensions: Length 60 ..... ft. Minimum depth 16 ..... ft. Maximum depth 16 ..... ft.

Bottom width 16 ..... ft. Discharge ..... g.p.m. Date of test .....

12. **Tunnel:** Type of lining .....

Dimensions: .....  
(Length, course, and cross sectional size)

Position of water bearing stratum with reference to portal of tunnel .....

Log of tunnel: (Preceding table for log of well may be used, if desired. Give footage from portal and character of materials, as pertinent.)

13. **Pumping Equipment:**

(a) Pump 2" centrifugal ..... Capacity about 200 g.p.m.  
(Make, type and size)

(b) Motor electric 7 1/2 H.P. .....  
(Type and horsepower)

14. Location of area irrigated or to be irrigated, or place of use if for purposes other than irrigation.

| Township North or South | Range E. or W. of Willamette Meridian | Section | Forty-acre Tract    | Number Acres To Be Irrigated | Date of Reclamation |
|-------------------------|---------------------------------------|---------|---------------------|------------------------------|---------------------|
| 37 S.                   | 2 W.                                  | 2       | E 1/2 NE 1/4 SW 1/4 | 4.0 acres                    | May 10, 1946        |
| "                       | "                                     | "       | NW 1/4 SE 1/4       | 16.0 acres                   | May 10, 1946        |
|                         |                                       |         | Total               | 20.0 acres                   |                     |
|                         |                                       |         |                     |                              |                     |
|                         |                                       |         |                     |                              |                     |
|                         |                                       |         |                     |                              |                     |
|                         |                                       |         |                     |                              |                     |
|                         |                                       |         |                     |                              |                     |
|                         |                                       |         |                     |                              |                     |
|                         |                                       |         |                     |                              |                     |
|                         |                                       |         |                     |                              |                     |
|                         |                                       |         |                     |                              |                     |
|                         |                                       |         |                     |                              |                     |
|                         |                                       |         |                     |                              |                     |
|                         |                                       |         |                     |                              |                     |
|                         |                                       |         |                     |                              |                     |
|                         |                                       |         |                     |                              |                     |
|                         |                                       |         |                     |                              |                     |
|                         |                                       |         |                     |                              |                     |
|                         |                                       |         |                     |                              |                     |
|                         |                                       |         |                     |                              |                     |

15. If the ground water supply is supplemental to an existing water supply, identification of any application for a permit, permit, certificate or adjudicated right to appropriate water made or held by the registrant.

none .....

Township 37 S. Range 2 W., W.M.  
North

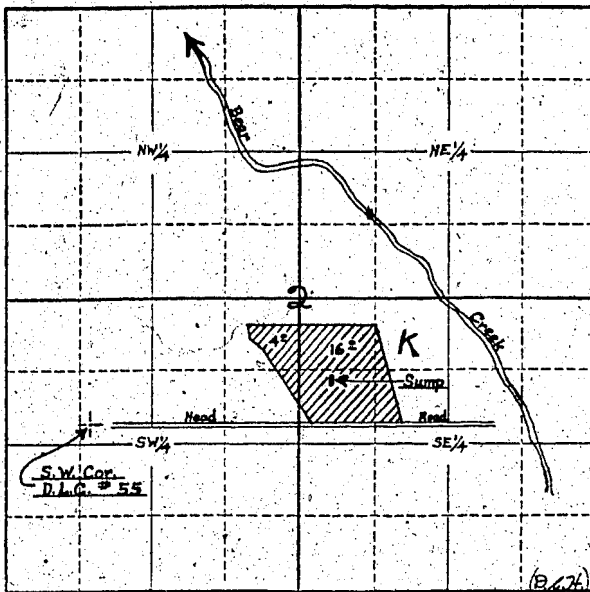

Locate well and acreage of irrigated land on plat.  
Scale: 4' = 1 Mile

STATE OF OREGON

County of Jackson

} ss.

I, Viggo Skou, being first duly sworn, do hereby certify that I have read the foregoing Registration Statement and that all of the items therein contained are true to the best of my knowledge and belief.

Viggo Skou  
(Signature of Registrant)

Subscribed and sworn to before me this 30th day of July, 1958.

My commission expires August 25, 1958.

Alfred R. [Signature]  
(Notary Public)

(SEAL)

**CERTIFICATE OF REGISTRATION**

STATE OF OREGON

County of Marion

} ss.

This is to certify that the foregoing Registration Statement was received in the office of the State Engineer on the 31<sup>st</sup> day of July, 1958, at 1:00 o'clock A. M. and has been duly recorded in said office in Book No. 13 of Registration Statements on page GR 3111.

Witness my hand this 16<sup>th</sup> day of June, 1959.

Lewis A. Stanley  
(State Engineer)

\$15.00

By \_\_\_\_\_  
(Deputy)