

Registration Statement

OF CLAIMANT OF RIGHT TO APPROPRIATE GROUND WATER

TO THE STATE ENGINEER OF OREGON:

I, Earl W. Hardin

of P. O. Box 387, Phoenix, County of Jackson

State of Oregon, do hereby make application for a certificate of registration as evidence of a right to appropriate ground water.

1. Source from which water is withdrawn is Infiltration trench (Sump)
(Flowing well, pump well, infiltration trench, or tunnel)

2. Location is: 1 1/2 miles south of Phoenix, Oregon
(Approximate distance and direction from nearest city or town)

and is more particularly described as follows:

(a) 1,360 feet South and 1,170 feet East from the NW corner of Section 22
(Give distance and bearing to corner of section or other legal subdivision)

being within NE 1/4 SW 1/4 NW 1/4 of Sec. 22, Twp. 38 S., Rge. 1 W.
(Smallest legal subdivision) (N. or S.) (E. or W.)

or (b) within limits of recorded platted property, town or city:

in Lot _____ Block _____ of _____
(Name of plat or addition)

County of _____
(If within city or town, give name)

3. Construction Work was begun on June 1955; was completed on June 1955
(Date) (Date)

and the ground water claimed was first used for the purposes set out below on June 1955
(Date)

since which time the water has been used intermittently
(Continuously or intermittently)

from June 1955 to present
(Date) (Date)

4. Quantity of water claimed and used is 100 gallons per minute; 45 acre feet per year.
plus sufficient for stock watering purposes

5. Purpose or Purposes for which water is used stock and irrigation purposes
(Domestic, irrigation, municipal, manufacturing, industrial, etc.)

6. Description of Well: Depth _____ feet. Type _____
(Dug or drilled)

diameter _____ inches. Elevation of ground at well site _____ feet, mean sea level.
(As near as known)

Depth to water table _____ feet.

7. Capacity of Well: _____ g.p.m. with _____ feet drawdown.

_____ g.p.m. with _____ feet drawdown.

Date of test _____

If Flowing Well: Measured discharge _____ g.p.m. on _____
(Date)

Shut-in pressure at ground surface _____ lbs. per sq. in. on _____
(Date)

Water is controlled by _____
(Cap. valve, etc.)

8. Casing: (Give diameter, commercial specifications and depth below ground surface of each casing size.)

..... inch diameter from to feet
..... inch diameter from to feet
..... inch diameter from to feet
..... inch diameter from to feet

Describe and show depth of shoe, plug, adapter, liner or other details:

9. Perforated Casings or Screens:

..... from to
(Number per foot and size of perforations, or describe screen)
..... from to
..... from to
..... from to

10. Log of Well: (Describe each stratum or formation clearly, indicate if water bearing, and give thickness and depth as indicated.)

MATERIAL	Thickness (Feet)	Depth to Bottom (Feet)
black dirt	16	0
gravel - water bearing	0	

If log of well is not available, give name and address of driller. Tru Mix Concrete Co.,
Medford, Oregon

11. Infiltration Trench: Covered or open open

Dimensions: Length 30 ft. Minimum depth 16 ft. Maximum depth 16 ft.

Bottom width 20 ft. Discharge 100 g.p.m. Date of test none

12. Tunnel: Type of lining

Dimensions: _____
(Length, course, and cross sectional size)

Position of water bearing stratum with reference to portal of tunnel _____

Log of tunnel: (Preceding table for log of well may be used, if desired. Give footage from portal and character of materials, as pertinent.)

13. Pumping Equipment:

(a) Pump Berkeley Pump -- 1 1/2 centrifugal Capacity 100 g.p.m.
(Make, type and size)

(b) Motor 3 H.P. Electric
(Type and horsepower)

14. Location of area irrigated or to be irrigated, or place of use if for purposes other than irrigation.

Township North or South	Range E. or W. of Willamette Meridian	Section	Forty-acre Tract	Number Acres To Be Irrigated	Date of Reclamation
<u>38 S.</u>	<u>1W.</u>	<u>22</u>	<u>W 1/2 NE 1/4 NW 1/4</u>	<u>1.2 acres</u>	<u>June 1955</u>
<u>"</u>	<u>"</u>	<u>"</u>	<u>E 3/4 NW 1/4 NW 1/4</u>	<u>6.4 acres</u>	<u>June 1955</u>
<u>"</u>	<u>"</u>	<u>"</u>	<u>NE 1/4 SW 1/4 NW 1/4</u>	<u>2.3 acres</u>	<u>June 1955</u>
<u>"</u>	<u>"</u>	<u>"</u>	<u>NW 1/4 SE 1/4 NW 1/4</u>	<u>0.3 acre</u>	<u>June 1955</u>
			<u>Total</u>	<u>10.2 acres</u>	<u>"</u>

15. If the ground water supply is supplemental to an existing water supply, identification of any application for a permit, permit, certificate or adjudicated right to appropriate water made or held by the registrant. none

Township 38 S. Range 1 W. W.M.
North

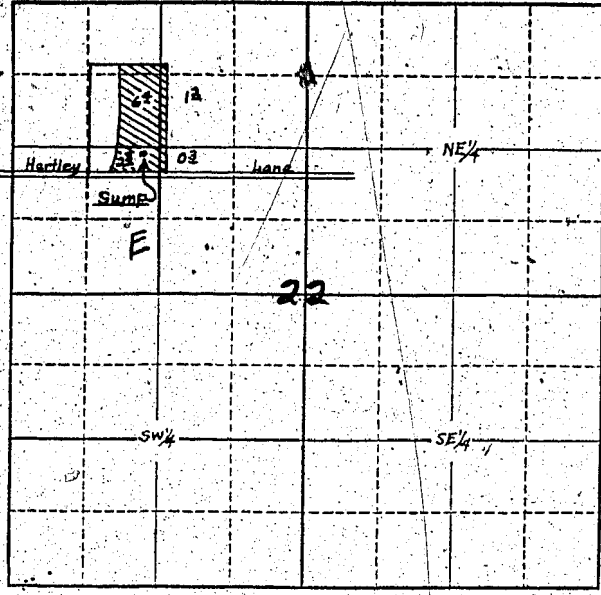

Locate well and acreage of irrigated land on plat.

Scale: 4" = 1 Mile

STATE OF OREGON

County of Jackson } ss.

I, Earl W. Hardin, being first duly sworn, do hereby certify that I have read the foregoing Registration Statement and that all of the items therein contained are true to the best of my knowledge and belief.

Earl W. Hardin

(Signature of Registrant)

Subscribed and sworn to before me this 30th day of July, 19 58

My commission expires August 25, 1958

Walter C. ...

(Notary Public)

(SEAL)

CERTIFICATE OF REGISTRATION

STATE OF OREGON

County of Marion } ss.

This is to certify that the foregoing Registration Statement was received in the office of the State Engineer on the 31st day of July, 1958, at 8:00 o'clock A. M. and has been duly recorded in said office in Book No. 13 of Registration Statements on page GR-3112

Witness my hand this 16th day of June, 19 59

Leura A. Stanley

(State Engineer)

By _____
(Deputy)

\$15.00