

Registration Statement

REGISTRATION NO. GR-337CERTIFICATE NO. GR-322

OF CLAIMANT OF RIGHT TO APPROPRIATE GROUND WATER

(Under Chapter 703, Oregon Laws 1955.)

TO THE STATE ENGINEER OF OREGON:

I, PATRICK J. JOHNSTON and DOLORES A. JOHNSTON
of RT One Box 317 County of MARION
WOODBURNState of OREGON, do hereby make application for a certificate of registration as evidence of a right to appropriate ground water.1. Source from which water is withdrawn is pump well #1
(Flowing well, pump well, infiltration trench, or tunnel)2. Location is: 5 miles northwest from Woodburn
(Approximate distance and direction from nearest city or town)

and is more particularly described as follows:

(a) 2000 feet east and 380 feet south from NE corner Sec. 34.
1177.44' N 3° 12' E then 1286' S 68° 40' E then 1191' 21' E - 500 to well
NE 1/4 of NW 1/4
(Give distance and bearing to corner of section or other legal subdivision)being within Northwest quarter of Sec. 34, Twp. 4, Rge. 2W
(Smallest legal subdivision) (N. or S.) (E. or W.)

or (b) within limits of recorded platted property, town or city:

in Lot _____, Block _____ of _____
(Name of plat or addition)County of _____
(If within city or town, give name)3. Construction Work was begun on March 4, 1955; was completed on April 10, 1955
(Date) (Date)and the ground water claimed was first used for the purposes set out below on June 6, 1955
(Date)since which time the water has been used intermittantly
(Continuously or Intermittently)from April 15 to October 1
(Date) (Date)4. Quantity of water claimed and used is 320 gallons per minute; unknown acre feet per year.5. Purpose or Purposes for which water is used irrigation
(Domestic, irrigation, municipal, manufacturing, industrial, etc.)6. Description of Well: Depth 104 feet. Type drilled
(Dug or drilled)diameter 10 inches. Elevation of ground at well site 165 Ft. feet, mean sea level.
(As near as known)Depth to water table 21 feet.7. Capacity of Well: 400 g.p.m. with 52 feet drawdown.

_____ g.p.m. with _____ feet drawdown.

Date of test April 12If Flowing Well: Measured discharge _____ g.p.m. on _____
(Date)Shut-in pressure at ground surface _____ lbs. per sq. in. on _____
(Date)Water is controlled by _____
(Cap, valve, etc.)

If log of well is not available, give name and address of driller: J. T. Miller, Aurora

11. Infiltration Trench: Covered or open: _____

Dimensions: Length _____ ft. Minimum depth _____ ft. Maximum depth _____ ft.

Bottom width _____ ft. Discharge _____ g.p.m. Date of test _____

12. Tunnel: Type of lining _____

Dimensions: _____
(Length, course, and cross sectional size)

Position of water bearing stratum with reference to portal of tunnel _____

Log of tunnel: (Preceding table for log of well may be used, if desired. Give footage from portal and character of materials, as pertinent.)

13. Pumping Equipment:

(a) Pump JASZZI-turbine-25hp Capacity _____ g.p.m.
(Make, type and size)

(b) Motor 25 HP 30 220V
(Type and horsepower)

14. Location of area irrigated or to be irrigated, or place of use if for purposes other than irrigation.

Township, North or South	Range, E. or W. of Willamette Meridian	Section	Forty-acre Tract	Number Acres To Be Irrigated	Date of Reclamation
	EW	34		78	
T4S	R2W	27	SW $\frac{1}{4}$ SE $\frac{1}{4}$	9 ac	1-9-55
		34	NW $\frac{1}{4}$ NE $\frac{1}{4}$	7 $\frac{1}{2}$ ac	11
			NE $\frac{1}{4}$ NW $\frac{1}{4}$	28 ac	11
			NW $\frac{1}{4}$ NW $\frac{1}{4}$	8 $\frac{1}{2}$ ac	11
			SW $\frac{1}{4}$ NW $\frac{1}{4}$	15 ac	11
			SE $\frac{1}{4}$ NW $\frac{1}{4}$	15 ac	11
				78 Ac	

15. If the ground water supply is supplemental to an existing water supply, identification of any application for a permit, permit, certificate or adjudicated right to appropriate water made or held by the registrant.

Township 45 Range R 2 W W.M.

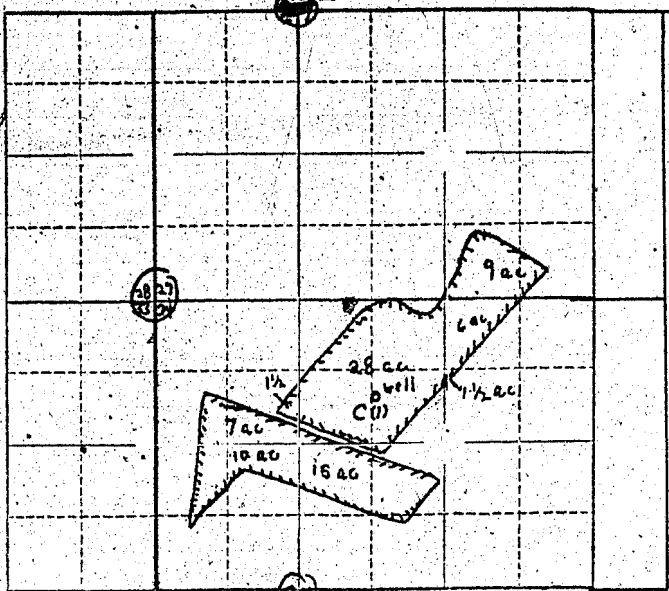

Locate well and acreage of irrigated land on plat
Scale: 1/4 = 1 Mile

STATE OF OREGON

County of Marion

I, Patrick G. Johnson being first duly sworn, do hereby certify that I have read the foregoing Registration Statement and that all of the items therein contained are true to the best of my knowledge and belief:

Patrick G. Johnson
(Signature of Registrant)

Subscribed and sworn to before me this 17th day of Jan, 1957

My commission expires 8-22-57
J. W. Adams
(Notary Public)

(SEAL)

CERTIFICATE OF REGISTRATION

STATE OF OREGON

County of Marion

This is to certify that the foregoing Registration Statement was received in the office of the State Engineer on the 17th day of January, 1957, at 3:00 o'clock P.M. and has been duly recorded in said office in Book No. 2 of Registration Statements on page GR-322 C

~~Construction shall be completed by 12-31-57 and the water completely applied to beneficial use by 12-31-57~~

Witness my hand this 1st day of April, 1957

Lewis A. Stanley
(State Engineer)

22.26

By _____
(Deputy)

GR-322 C