

Registration Statement

OF CLAIMANT OF RIGHT TO APPROPRIATE GROUND WATER

TO THE STATE ENGINEER OF OREGON:

I, Wilbur Bruck

of Route 1 Box 316 Wilsonville County of Clackamas

State of Oregon, do hereby make application for a certificate of registration as evidence of a right to appropriate ground water.

1. Source from which water is withdrawn is pump well
(Flowing well, pump well, infiltration trench, or tunnel)

2. Location is: 2 1/2 mi. E of Wilsonville
(Approximate distance and direction from nearest city or town)

and is more particularly described as follows:

(a) 2360' west and 1076' south of N.E. corner
(Give distance and bearing to corner of section or other legal subdivision)

being within NW 1/4 of NE 1/4 of Sec. 18, Twp. 3 S, Rge. 1 E
(Smallest legal subdivision) (N. or S.) (E. or W.)

or (b) within limits of recorded platted property, town or city:

in Lot _____, Block _____ of _____
(Name of plat or addition)

County of _____
(If within city or town, give name)

3. Construction Work was begun on September 1950; was completed on October 1950
(Date) (Date)

and the ground water claimed was first used for the purposes set out below on May 1951
(Date)

since which time the water has been used intermittently (for irrigation)
(Continuously or intermittently)

from May to October
(Date) (Date)

4. Quantity of water claimed and used is 100 gallons per minute; _____ acre feet per year.

5. Purpose or Purposes for which water is used drain and irrigated pasture
(Domestic, irrigation, municipal, manufacturing, industrial, etc.)

6. Description of Well: Depth 254 feet. Type drilled
(Dug or drilled)

diameter 4 inches. Elevation of ground at well site 160 feet, mean sea level.
(As near as known)

Depth to water table 78 feet.

7. Capacity of Well: 160 g.p.m. with 2.3 feet drawdown.

_____ g.p.m. with _____ feet drawdown.

Date of test October 1950

If Flowing Well: Measured discharge _____ g.p.m. on _____
(Date)

Shut-in pressure at ground surface _____ lbs. per sq. in. on _____
(Date)

Water is controlled by _____
(Cap, valve, etc.)

Township 3 S Range 1 E W.M.

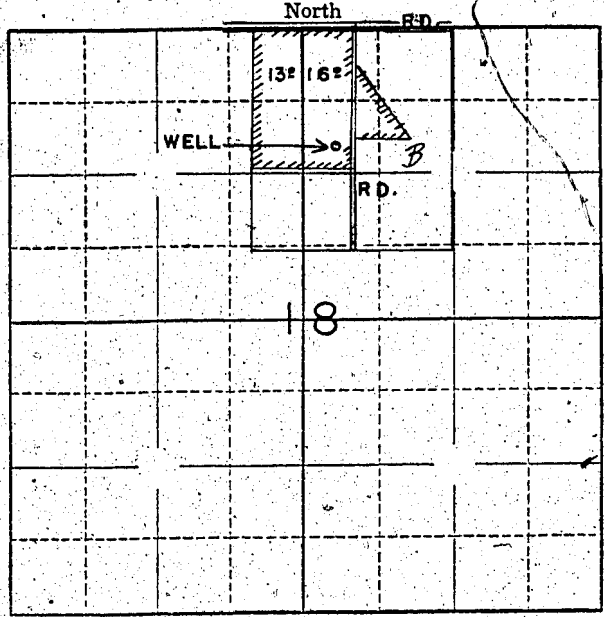

Locate well and acreage of irrigated land on plat.

Scale: 2" = 1 Mile

STATE OF OREGON }
County of Clackamas } ss.

I, Willbur Bruck, being first duly sworn, do hereby certify that I have read the foregoing Registration Statement and that all of the items therein contained are true to the best of my knowledge and belief.

Willbur Bruck
(Signature of Registrant)

Subscribed and sworn to before me this 30th day of July, 1958

My commission expires MY COMMISSION EXPIRES OCT. 15, 1959

W. H. Clippinger
(State Engineer)

(SEAL)

CERTIFICATE OF REGISTRATION

STATE OF OREGON }
County of Marion } ss.

This is to certify that the foregoing Registration Statement was received in the office of the State Engineer on the 31st day of July, 1958 at 2:00 o'clock A. M. and has been duly recorded in said office in Book No. 13 of Registration Statements on page GR-3123

Witness my hand this 16th day of June, 1959

Lewis A. Stanley
(State Engineer)

By _____
(Deputy)

1/500