

# Registration Statement

## OF CLAIMANT OF RIGHT TO APPROPRIATE GROUND WATER

TO THE STATE ENGINEER OF OREGON:

I, Elmer E. ~~Hansen~~ Hansen  
of PT# 1, BX# 188 County of Lane  
(Mailing address)

State of Oregon, do hereby make application for a certificate of registration as evidence of a right to appropriate ground water.

1. Source from which water is withdrawn is Pump well  
(Flowing well, pump well, infiltration trench, or tunnel)

2. Location is: 6 miles S Junction City  
(Approximate distance and direction from nearest city or town)

and is more particularly described as follows:

(a) 875' N & 395' E from SW cor sec 33  
(Give distance and bearing to corner of section or other legal subdivision)

being within SW 1/4 of SW 1/4 of Sec. 33, Twp. 16-S, Rge. 4-W  
(Smallest legal subdivision) (N. or S.) (E. or W.)

or (b) within limits of recorded platted property, town or city:

in Lot \_\_\_\_\_, Block \_\_\_\_\_ of \_\_\_\_\_  
(Name of plat or addition)

County of Lane  
(If within city or town, give name)

3. Construction Work was begun on 1954; was completed on 1954  
(Date) (Date)

and the ground water claimed was first used for the purposes set out below on 1954  
(Date)

since which time the water has been used Intermittently  
(Continuously or intermittently)

from May to Oct  
(Date) (Date)

4. Quantity of water claimed and used is 100 gallons per minute; 42 acre feet per year.

5. Purpose or Purposes for which water is used Irrigation

(Domestic, irrigation, municipal, manufacturing, industrial, etc.)

6. Description of Well: Depth 19 feet. Type Driven  
(Dug or drilled)

diameter (3)-2 inches. Elevation of ground at well site 340 feet, mean sea level.  
(As near as known)

Depth to water table 15 feet.

7. Capacity of Well: 100 g.p.m. with 3 feet drawdown.

\_\_\_\_\_ g.p.m. with \_\_\_\_\_ feet drawdown.

Date of test \_\_\_\_\_

If Flowing Well: Measured discharge \_\_\_\_\_ g.p.m. on \_\_\_\_\_  
(Date)

Shut-in pressure at ground surface \_\_\_\_\_ lbs. per sq. in. on \_\_\_\_\_  
(Date)

Water is controlled by \_\_\_\_\_  
(Cap, valve, etc.)

*Elmer E. Hansen*



If log of well is not available, give name and address of driller. ....

11. Infiltration Trench: Covered or open .....

Dimensions: Length ..... ft. Minimum depth ..... ft. Maximum depth ..... ft.  
 Bottom width ..... ft. Discharge ..... g.p.m. Date of test .....

12. Tunnel: Type of lining .....

Dimensions: .....  
(Length, course, and cross sectional size)  
 Position of water bearing stratum with reference to portal of tunnel .....

Log of tunnel: (Preceding table for log of well may be used, if desired. Give footage from portal and character of materials, as pertinent.)

13. Pumping Equipment:

(a) Pump Barkley - Centrif - 1 1/2" Capacity 150 g.p.m.  
(Make, type and size)  
 (b) Motor 1-Ph Elec. 5-H.P.  
(Type and horsepower)

14. Location of area irrigated or to be irrigated, or place of use if for purposes other than irrigation.

Township North or South	Range E. or W. of Willamette Meridian	Section	Forty-acre Tract	Number Acres To Be Irrigated	Date of Reclamation
16-S	4-W	33	N.W. 1/4 of S.W. 1/4	5	1954
16-S	4-W	33	S.W. 1/4 of S.W. 1/4	10	"
				<u>15</u>	

15. If the ground water supply is supplemental to an existing water supply, identification of any application for a permit, permit, certificate or adjudicated right to appropriate water made or held by the registrant.

Township 16.5 Range 40 W.M.  
North

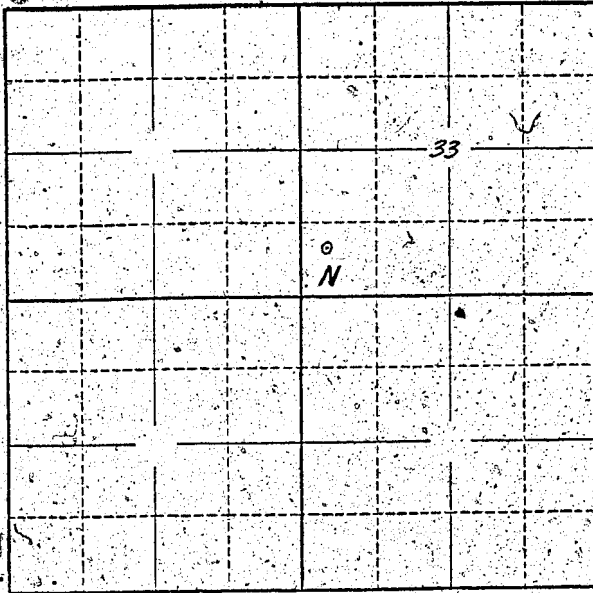

Locate well and acreage of irrigated land on plat.  
Scale: 2" = 1 Mile

STATE OF OREGON

County of Wasco } ss.

I, Edna E. Hansen, being first duly sworn, do hereby certify that I have read the foregoing Registration Statement and that all of the items therein contained are true to the best of my knowledge and belief.

Edna E. Hansen  
(Signature of Registrant)

Subscribed and sworn to before me this 30th day of July, 1958.

My commission expires March 14 1962

Herman S. Sigurdson  
(Notary Public)

(SEAL)

**CERTIFICATE OF REGISTRATION**

STATE OF OREGON

County of Marion } ss.

This is to certify that the foregoing Registration Statement was received in the office of the State Engineer on the 31st day of July, 1958, at 8:00 o'clock A. M. and has been duly recorded in said office in Book No. 13 of Registration Statements on page GR-3130

Witness my hand this 16th day of June, 1959

Laura A. Stanley  
(State Engineer)

By \_\_\_\_\_ (Deputy)

GR - 3130