

Registration Statement

OF CLAIMANT OF RIGHT TO APPROPRIATE GROUND WATER

TO THE STATE ENGINEER OF OREGON:

I, Louis Schimber

of Corvallis, R.R. 1, Box 47 County of Wheeler
(Mailing address)

State of Oregon, do hereby make application for a certificate of registration as evidence of a right to appropriate ground water.

1. Source from which water is withdrawn is Pump Well
(Flowing well, pump well, infiltration trench, or tunnel)

2. Location is: 4 miles West of Corvallis
(Approximate distance and direction from nearest city or town)

and is more particularly described as follows:

(a) 400' S & 150' W from center of Section 28
(Give distance and bearing to corner of section or other legal subdivision)

being within NE 1/4 S.W. 1/4 of Sec. 28, Twp. 35, Rge. 2
(Smallest legal subdivision) (N. or S.) (E. or W.)

or (b) within limits of recorded platted property, town or city:

in Lot _____, Block _____ of _____
(Name of plat or addition)

County of _____
(If within city or town, give name)

3. Construction Work was begun on 7-1-52; was completed on 4-1-52
(Date) (Date)

and the ground water claimed was first used for the purposes set out below on _____
(Date)

since which time the water has been used intermittently
(Continuously or intermittently)

from May 15 1952 to Sept 25 1952
(Date) (Date)

4. Quantity of water claimed and used is 300 gallons per minute; _____ acre feet per year.

5. Purpose or Purposes for which water is used domestic
(Domestic, irrigation, municipal, manufacturing, industrial, etc.)

6. Description of Well: Depth 125 feet. Type drilled
(Dug or drilled)

diameter 6 inches. Elevation of ground at well site _____ feet, mean sea level.
(As near as known)

Depth to water table 12 feet.

7. Capacity of Well: 285 g.p.m. with 13 feet drawdown.

_____ g.p.m. with _____ feet drawdown.

Date of test April 16 1952

If Flowing Well: Measured discharge _____ g.p.m. on _____
(Date)

Shut-in pressure at ground surface _____ lbs. per sq. in. on _____
(Date)

Water is controlled by _____
(Cap, valve, etc.)

8. Casing: (Give diameter, commercial specifications and depth below ground surface of each casing size.)

6 inch diameter from 0 to 13 feet
 inch diameter from to feet
 inch diameter from to feet
 inch diameter from to feet

Describe and show depth of shoe, plug, adapter, liner or other details:

9. Perforated Casings or Screens:

2 6" x 1/4" from 75 to 65
(Number per foot and size of perforations, or describe screen)
 2 6" x 1/8" from 110 to
 from to
 from to

10. Log of Well: (Describe each stratum or formation clearly, indicate if water bearing, and give thickness and depth as indicated.)

MATERIAL	Thickness (Feet)	Depth to Bottom (Feet)
Clay	12	
Silt	18	30
Fine Sand	56	90
Coarse	22	112
Gravel & Sand	28	140

If log of well is not available, give name and address of driller.

11. Infiltration Trench: Covered or open

Dimensions: Length _____ ft. Minimum depth _____ ft. Maximum depth _____ ft.

Bottom width _____ ft. Discharge _____ g.p.m. Date of test _____

12. Tunnel: Type of lining

Dimensions: _____
(Length, course, and cross sectional size)

Position of water bearing stratum with reference to portal of tunnel _____

Log of tunnel: (Preceding table for log of well may be used, if desired. Give footage from portal and character of materials, as pertinent.)

13. Pumping Equipment:

(a) Pump Johnson Turbine Capacity _____ g.p.m.
(Make, type and size)

(b) Motor Electric
(Type and horsepower)

14. Location of area irrigated or to be irrigated, or place of use if for purposes other than irrigation.

Township North or South	Range E. or W. of Willamette Meridian	Section	Forty-acre Tract	Number Acres To Be Irrigated	Date of Reclamation
5 S	2 W	28	NE 1/4 SW 1/4	10	
5 S	2 W	"	NW 1/4 SE 1/4	10	
5 S	2 W	"	SE 1/4 NW 1/4	10	
5 S	2 W	"	NW 1/4 SW 1/4	10	
				40	

15. If the ground water supply is supplemental to an existing water supply, identification of any application for a permit, permit, certificate or adjudicated right to appropriate water made or held by the registrant.

Township 5 S Range 2 W, W.M.
North

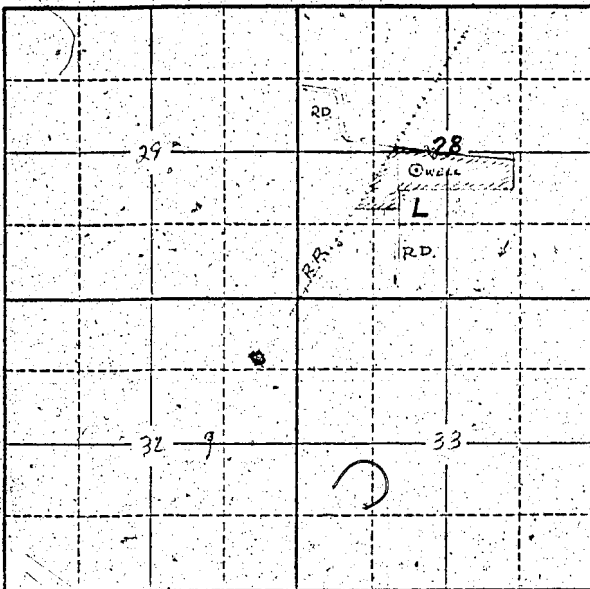

Locate well and acreage of irrigated land on plat.
Scale: 2" = 1 Mile

STATE OF OREGON

County of Marion } ss.

I Louis Schmecher, being first duly sworn, do hereby certify that I have read the foregoing Registration Statement and that all of the items therein contained are true to the best of my knowledge and belief.

Louis Schmecher
(Signature of Registrant)

Subscribed and sworn to before me this 31st day of July, 1958

My commission expires 12th June 1961

Wm S. Bartholomew
(Notary Public)

(SEAL)

CERTIFICATE OF REGISTRATION

STATE OF OREGON

County of Marion } ss.

This is to certify that the foregoing Registration Statement was received in the office of the State Engineer on the 31st day of July, 1958, at 11:00 o'clock A.M. and has been duly recorded in said office in Book No. 13 of Registration Statements on page GR-3166

Witness my hand this 18th day of June, 1959

Laura A. Stankin
(State Engineer)

By _____ (Deputy)

GR-3166

#17.25