

Registration Statement

OF CLAIMANT OF RIGHT TO APPROPRIATE GROUND WATER

TO THE STATE ENGINEER OF OREGON:

I, Charles E. Finnigan
 of RT. 1, Box 84 Oregon City County of Clackamas
(Mailing address)
 State of Oregon, do hereby make application for a certificate of registration as evidence of a right to appropriate ground water.

1. Source from which water is withdrawn is Pump Well
(Flowing well, pump well, infiltration trench, or tunnel)

2. Location is: One, Three Tenth mile south of Oregon City
(Approximate distance and direction from nearest city or town)

and is more particularly described as follows:

(a) N20°40'E 2035 Feet From SW Corner of Section 12
(Give distance and bearing to corner of section or other legal subdivision)

being within NW 1/4 SW 1/4 of Sec. 12 Twp. 35 Rge. 1E
(Smallest legal subdivision) (T. or S.) (E. or W.)

or (b) within limits of recorded platted property, town or city:

in Lot _____, Block _____ of _____
(Name of plat or addition)

County of _____
(If within city or town, give name)

3. Construction Work was begun on April 15 - 1948, was completed on May 1 - 1948
(Date) (Date)

and the ground water claimed was first used for the purposes set out below on July 1953
(Date)

since which time the water has been used Continuously throughout the summer
(Continuously or intermittently)

from July 53 to Present
(Date) (Date)

4. Quantity of water claimed and used is 40 gallons per minute; _____ acre feet per year.

5. Purpose or Purposes for which water is used IRRIGATION

(Domestic, irrigation, municipal, manufacturing, industrial, etc.)

6. Description of Well: Depth 163 feet. Type DRILLED
(Dug or drilled)

diameter 6 inches. Elevation of ground at well site 420 feet, mean sea level.
(As near as known)

Depth to water table 104 feet.

7. Capacity of Well: 40 g.p.m. with 40 feet drawdown.

_____ g.p.m. with _____ feet drawdown.

Date of test July 1, 1953

If Flowing Well: Measured discharge _____ g.p.m. on _____
(Date)

Shut-in pressure at ground surface _____ lbs. per sq. in. on _____
(Date)

Water is controlled by _____
(Cap, valve, etc.)

8. Casing: (Give diameter, commercial specifications and depth below ground surface of each casing size.)

6 inch diameter steel casing from Top to 16'0" feet
 . inch diameter from to feet
 . inch diameter from to feet
 . inch diameter from to feet

Describe and show depth of shoe, plug, adapter, liner or other details:

9. Perforated Casings or Screens:

PERFORATED AT 110-130-150 from to
(Number per foot and size of perforations, or describe screen)
 1 ROW 5 PER FT $\frac{3}{8}$ x $1\frac{1}{2}$ SLOTS from 110 to 130
 from 150 to 163
 from to

10. Log of Well: (Describe each stratum or formation clearly, indicate if water bearing, and give thickness and depth as indicated.)

MATERIAL	Thickness (Feet)	Depth to Bottom (Feet)
CLAY (Red)	24	24
BROKEN BASALT	79	104
Blue clay	56	160
GRAVEL (BROWN) WATER	13	173

If log of well is not available, give name and address of driller.

11. Infiltration Trench: Covered or open

Dimensions: Length ft. Minimum depth ft. Maximum depth ft.

Bottom width ft. Discharge g.p.m. Date of test

12. Tunnel: Type of lining

Dimensions:
(Length, course, and cross sectional size)

Position of water bearing stratum with reference to portal of tunnel

Log of tunnel: (Preceding table for log of well may be used, if desired. Give footage from portal and character of materials, as pertinent.)

13. Pumping Equipment:

(a) Pump *SUMO Submersible* Capacity *40* g.p.m.
(Make, type and size)

(b) Motor *3 Horse P.*
(Type and horsepower)

14. Location of area irrigated or to be irrigated, or place of use if for purposes other than irrigation.

Township North or South	Range E. or W. of Willamette Meridian	Section	Forty-acre Tract	Number Acres To Be Irrigated	Date of Reclamation
<i>35</i>	<i>1E</i>	<i>12</i>	<i>NW 1/4 SW 1/4</i>	<i>7.0</i>	<i>1953</i>

15. If the ground water supply is supplemental to an existing water supply, identification of any application for a permit, permit, certificate or adjudicated right to appropriate water made or held by the registrant.

Township 35 Range 1E, W.M.
North

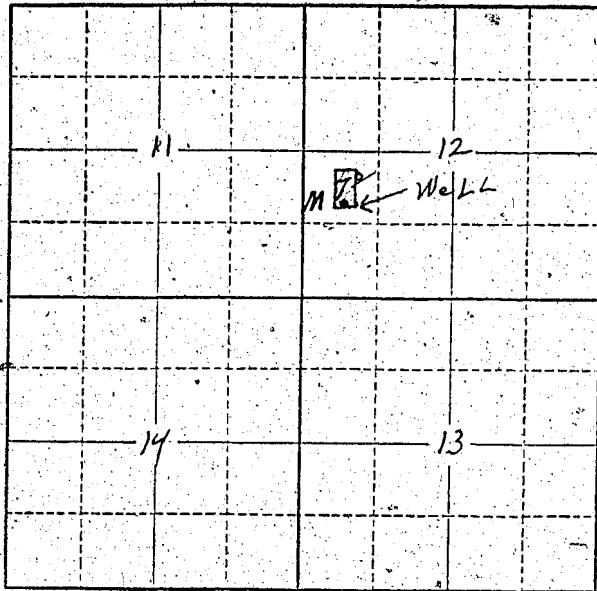

Locate well and acreage of irrigated land on plat.
Scale: 2" = 1 Mile

STATE OF OREGON

County of Marion } ss.

I Charles E. Sunneagon, being first duly sworn, do hereby certify that I have read the foregoing Registration Statement and that all of the items therein contained are true to the best of my knowledge and belief.

Charles E. Sunneagon
(Signature of Registrant)

Subscribed and sworn to before me this 31st day of July, 1958

My commission expires 12th June 1961 Wm. S. Bartholomew
(Notary Public)

(SEAL)

CERTIFICATE OF REGISTRATION

STATE OF OREGON } ss.
County of Marion

This is to certify that the foregoing Registration Statement was received in the office of the State Engineer on the 31st day of July, 1958, at 2:00 o'clock P. M. and has been duly recorded in said office in Book No. 13 of Registration Statements on page GR-3168

Witness my hand this 18th day of June, 1959

Leura A. Standley
(State Engineer)

\$15.00

By _____ (Deputy)