

Registration Statement

OF CLAIMANT OF RIGHT TO APPROPRIATE GROUND WATER

TO THE STATE ENGINEER OF OREGON:

I, LOUIS SOVA

of ~~Postal Box 79~~ ~~Postal Box 79~~ Brooks, OREGON County of MARION

State of OREGON, do hereby make application for a certificate of registration as evidence of a right to appropriate ground water.

1. Source from which water is withdrawn is PUMP WELL (Flowing well, pump well, infiltration trench, or tunnel)

2. Location is: 2 1/2 MILES NORTH OF BROOKS. (Approximate distance and direction from nearest city or town)

and is more particularly described as follows:

(a) 540' EAST & 800' NORTH FROM SW CORNER OF SECTION 3

being within SW 1/4 OF SW 1/4 of Sec. 3 Twp. 6 S Rge. 2 W (Smallest legal subdivision) (N. or S.) (E. or W.)

or (b) within limits of recorded platted property, town or city: NO.

in Lot _____ Block _____ of _____ (Name of plat or addition)

County of _____ (If within city or town, give name)

3. Construction Work was begun on 1941; was completed on SAME (Date) (Date)

and the ground water claimed was first used for the purposes set out below on 1941 (Date)

since which time the water has been used INTERMITTENTLY (Date)

from 1941 to 1958 (Continuously or Intermittently) (Date) (Date)

4. Quantity of water claimed and used is 50 gallons per minute; 8 acre feet per year.

5. Purpose or Purposes for which water is used HOUSE & STOCK WATER L.S. ALSO IRRIGATION BEGUN IN 1953

(Domestic, irrigation, municipal, manufacturing, industrial, etc.)

6. Description of Well: Depth 115 feet. Type DRILLED (Dug or drilled)

diameter 4 1/2 inches. Elevation of ground at well site 150 feet, mean sea level. (As near as known)

Depth to water table 21 feet.

7. Capacity of Well: 54 g.p.m. with 84 feet drawdown.

g.p.m. with _____ feet drawdown.

Date of test 1953

If Flowing Well: Measured discharge _____ g.p.m. on _____ (Date)

Shut-in pressure at ground surface _____ lbs. per sq. in. on _____ (Date)

Water is controlled by _____ (Cap, valve, etc.)

Township 65 Range 2W W.M.
North

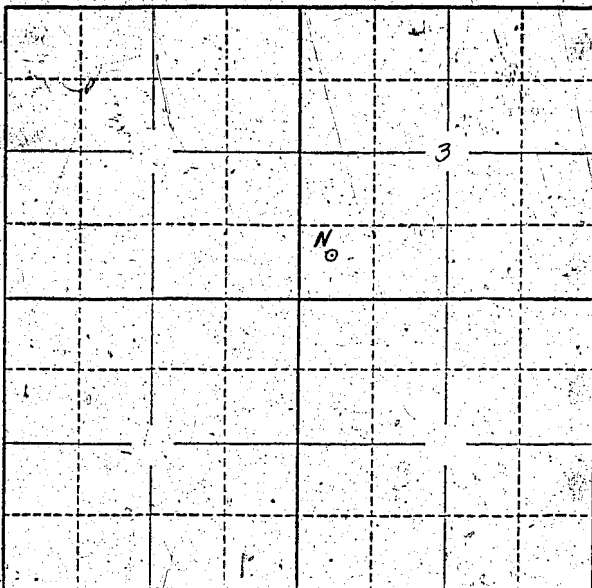

Locate well and acreage of irrigated land on plat.
Scale: 2" = 1 Mile

STATE OF OREGON

County of Marion } ss.

I, Louis Scott, being first duly sworn, do hereby certify that I have read the foregoing Registration Statement and that all of the items therein contained are true to the best of my knowledge and belief.

Louis Scott
(Signature of Registrant)

Subscribed and sworn to before me this 31st day of July, 1955

My commission expires 8-22-61 W. H. Madar
(Notary Public)

(SEAL)

CERTIFICATE OF REGISTRATION

STATE OF OREGON

County of Marion } ss.

This is to certify that the foregoing Registration Statement was received in the office of the State Engineer on the 31st day of July, 1955, at 1:15 o'clock P. M. and has been duly recorded in said office in Book No. 13 of Registration Statements on page GR-3205

Witness my hand this 20th day of July, 1959
Lewis A. Stanley
(State Engineer)

By _____ (Deputy)