

RECEIVED
JUL 21 1958
STATE ENGINEER
EXAMINER

Registration Statement

REGISTRATION NO. GR-3470
CERTIFICATE NO. GR-3907

OF CLAIMANT OF RIGHT TO APPROPRIATE GROUND WATER

(Under Chapter 708, Oregon Laws 1955.)

TO THE STATE ENGINEER OF OREGON:

I, HOWARD E. SALVAGE
of CAVE JUNCTION County of Josephine

State of OREGON, do hereby make application for a certificate of registration as evidence of a right to appropriate ground water.

1. Source from which water is withdrawn is PUMP WELL #3
(Flowing well, pump well, infiltration trench, or tunnel)
2. Location is: 1 Mile EAST OF CAVE JUNCTION ORE
(Approximate distance and direction from nearest city or town)

and is more particularly described as follows:

(a) 1436 No. 4127 WEST of the SW CORNER of the SE 1/4 of the SE 1/4 of Sec 22
(Give distance and bearing to corner of section or other legal subdivision)
being within SW 1/4 SE 1/4 of Sec. 22, Twp. 39 S, Rge. 8 W
(Smallest legal subdivision) (N. or S.) (E. or W.)

or (b) within limits of recorded platted property, town or city:
in Lot _____, Block _____ of _____
(Name of plat or addition)

County of Josephine
(If within city or town, give name)

3. Construction Work was begun on UNKNOWN, was completed on UNKNOWN
(Date) (Date)
and the ground water claimed was first used for the purposes set out below on UNKNOWN 1954
(Date)

since which time the water has been used Continuously
(Continuously or Intermittently)
from 1954 to 7-29-58
(Date) (Date)

4. Quantity of water claimed and used is 45 gallons per minute; _____ acre feet per year.
(Exempt)

5. Purpose or Purposes for which water is used IRRIGATION
(Domestic, irrigation, municipal, manufacturing, industrial, etc.)

6. Description of Well: Depth 70 feet. Type Drilled
(Dug or drilled)
diameter 6" inches. Elevation of ground at well site 1250' feet, mean sea level.
(As near as known)
Depth to water table, 43' feet.

7. Capacity of Well: 45-50 g.p.m. with 10' feet drawdown.
_____ g.p.m. with _____ feet drawdown.

Date of test July 1954

If Flowing Well: Measured discharge _____ g.p.m. on _____
(Date)

Shut-in pressure at ground surface _____ lbs. per sq. in. on _____
(Date)

Water is controlled by _____
(Cap, valve, etc.)

If log of well is not available, give name and address of driller. UNKNOWN

11. Infiltration Trench: Covered or open

Dimensions: Length _____ ft. Minimum depth _____ ft. Maximum depth _____ ft.
Bottom width _____ ft. Discharge _____ g.p.m. Date of test _____

12. Tunnel: Type of lining

Dimensions: _____
(Length, course, and cross sectional size)
Position of water bearing stratum with reference to portal of tunnel _____

Log of tunnel: (Preceding table for log of well may be used, if desired. Give footage from portal and character of materials, as pertinent.)

13. Pumping Equipment:

(a) Pump PACIFIC 5N8A Capacity 75 g.p.m.
(Make, type and size)
(b) Motor ELECTRIC 3HP
(Type and horsepower)

14. Location of area irrigated or to be irrigated, or place of use if for purposes other than irrigation.

Township North or South	Range E. or W. of Willamette Meridian	Section	Forty-acre Tract	Number Acres To Be Irrigated	Date of Reclamation
<u>39. S</u>	<u>8 W</u>	<u>32</u>	<u>SE 1/4</u>	<u>7.0</u>	<u>1957</u> <u>UNKNOWN</u>

15. If the ground water supply is supplemental to an existing water supply, identification of any application for a permit, permit, certificate or adjudicated right to appropriate water made or held by the registrant.

Township 39 S Range 8 W, W.M.
North

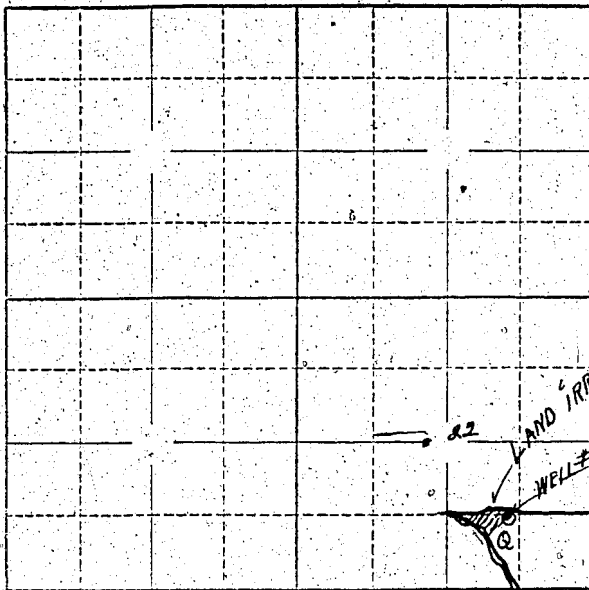

Locate well and acreage of irrigated land on plat.

Scale: 2" = 1 Mile

STATE OF OREGON

County of Klamath

ss.

I Howard E. Salvo being first duly sworn, do hereby certify that I have read the foregoing Registration Statement and that all of the items therein contained are true to the best of my knowledge and belief.

Howard E. Salvo
(Signature of Registrant)

Subscribed and sworn to before me this 30 day of July, 1958

My commission expires April 17 - 1962

Christie Markwardt
(Notary Public for Oregon)

(SEAL)

CERTIFICATE OF REGISTRATION

STATE OF OREGON

County of Marion

ss.

This is to certify that the foregoing Registration Statement was received in the office of the State Engineer on the 1st day of August, 1958, at 8:00 o'clock A. M. and has been duly recorded in said office in Book No. 16 of Registration Statements on page GR 3907

~~Xx Commission of said C. E. completed by ... and the same is hereby certified as ...~~

Witness my hand this 15th day of February, 1960

Laura A. Stanley
(State Engineer)

By

GR-3907

(Deputy)

1500