

Registration Statement

OF CLAIMANT OF RIGHT TO APPROPRIATE GROUND WATER

TO THE STATE ENGINEER OF OREGON:

I, Kenneth A. Danstrom

of 205 Lower Goodpasture Road, Eugene County of Lane

State of Oregon, do hereby make application for a certificate of registration as evidence of a right to appropriate ground water.

1. Source from which water is withdrawn is Pump Well
(Flowing well, pump well, infiltration trench, or tunnel)

2. Location is: 2 miles northwest of Eugene
(Approximate distance and direction from nearest city or town)

and is more particularly described as follows:

(a) N 2°30' E 1138 feet from W.S.W. Corner of Jacob Gillespie D.L.C. No. 70
(Give distance and bearing to corner of section or other legal subdivision) (T17S-R3W-N.E.)

being within SW 1/4 - SW 1/4 of Sec. 19 Twp 17 S Rge. 3 W
(Smallest legal subdivision) (N. or S.) (E. or W.)

or (b) within limits of recorded platted property, town or city:

in Lot _____, Block _____ of _____
(Name of plat or addition)

County of _____
(If within city or town, give name)

3. Construction Work was begun on 1938; was completed on 1938
(Date) (Date)

and the ground water claimed was first used for the purposes set out below on 1938
(Date)

since which time the water has been used Intermittently
(Continuously or Intermittently)

from 1938 to present
(Date) (Date)

4. Quantity of water claimed and used is 70 gallons per minute; 46 acre feet per year.

5. Purpose or Purposes for which water is used Permanent pasture irrigation
(Domestic, irrigation, municipal, manufacturing, industrial, etc.)

6. Description of Well: Depth 11 feet. Type Dug Well
(Dug or drilled)

diameter 30 inches; Elevation of ground at well site 420 feet, mean sea level.
(As near as known)

Depth to water table 10 feet.

7. Capacity of Well: _____ g.p.m. with _____ feet drawdown.

_____ g.p.m. with _____ feet drawdown.

Date of test _____

If Flowing Well: Measured discharge _____ g.p.m. on _____
(Date)

Shut-in pressure at ground surface _____ lbs. per sq. in. on _____
(Date)

Water is controlled by _____
(Cap, valve, etc.)

Township 17S Range 3W, W.M.
North

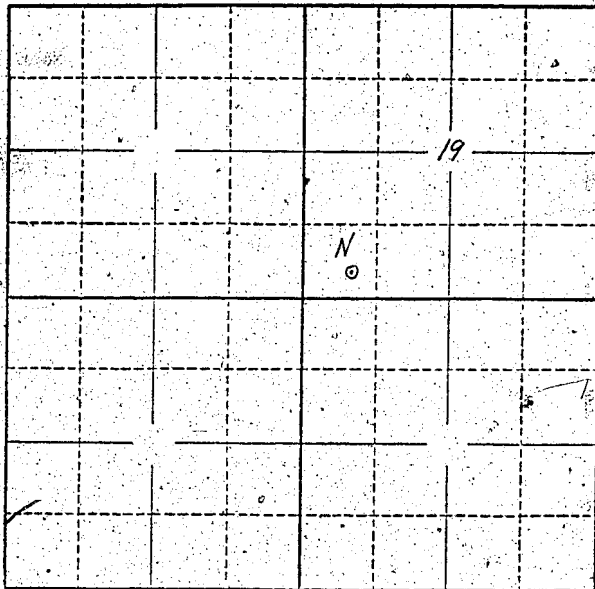

Locate well and acreage of irrigated land on plat.
Scale: 2" = 1 Mile

STATE OF OREGON

County of Jefferson } ss.

I B. W. Anderson being first duly sworn, do hereby certify that I have read the foregoing Registration Statement and that all of the items therein contained are true to the best of my knowledge and belief.

B. W. Anderson
(Signature of Registrant)

Subscribed and sworn to before me this 30 day of July, 1958

My commission expires My Commission Expires July 27, 1960

[Signature]
(Notary Public)

(SEAL)

CERTIFICATE OF REGISTRATION

STATE OF OREGON

County of Marion } ss.

This is to certify that the foregoing Registration Statement was received in the office of the State Engineer on the 31st day of July, 1958, at 1.00 o'clock P. M. and has been duly recorded in said office in Book No. 13 of Registration Statements on page OR-3221

Witness my hand this 20th day of July, 1959

Lewis A. Stanley
(State Engineer)

By _____

(Deputy)

\$15.00