

Registration Statement

CERTIFICATE NO.

GR 3492  
GR 3222

OF CLAIMANT OF RIGHT TO APPROPRIATE GROUND WATER

(Under Chapter 708, Oregon Laws 1955.)

TO THE STATE ENGINEER OF OREGON:

I, Gerald L. Diehl and Thais P. Diehl  
of Hillsboro County of Washington

State of Oregon, do hereby make application for a certificate of registration as evidence of a right to appropriate ground water.

- 1. Source from which water is withdrawn is Pump Well  
(Flowing well, pump well, infiltration trench, or tunnel)
- 2. Location is: 4 1/2 Miles N.E. of Hillsboro Oregon  
(Approximate distance and direction from nearest city or town)

and is more particularly described as follows:

(a) S 17° W 62.50 chains from ELY NE COR. of chambers claim  
(Give distance and bearing to corner of section or other legal subdivision)  
being within Northwest 1/4 of Sec. 15, Twp. 1 N, Rge. 2 W  
(Smallest legal subdivision) (N. or S.) (E. or W.)

or (b) within limits of recorded platted property, town or city:  
in Lot \_\_\_\_\_ Block \_\_\_\_\_ of \_\_\_\_\_  
(Name of plat or addition)

County of Washington  
(If within city or town, give name)

3. Construction Work was begun on Dec 52, was completed on Jan 53  
(Date) (Date)

and the ground water claimed was first used for the purposes set out below on Jan 53  
(Date)  
since which time the water has been used continuously  
(Continuously or intermittently)

from Jan 53 to Date Present  
(Date) (Date)

4. Quantity of water claimed and used is 20 gallons per minute; \_\_\_\_\_ acre feet per year.

5. Purpose or Purposes for which water is used ~~Domestic~~ Irrigation  
(Domestic, irrigation, municipal, manufacturing, industrial, etc.)

6. Description of Well: Depth 125 feet. Type Drilled  
(Dug or drilled)

diameter 6" inches. Elevation of ground at well site \_\_\_\_\_ feet; mean sea level.

Depth to water table 15 feet.  
(As near as known)

7. Capacity of Well: 20 g.p.m. with 65 feet drawdown.  
\_\_\_\_\_ g.p.m. with \_\_\_\_\_ feet drawdown.

Date of test Jan 1953

If Flowing Well: Measured discharge \_\_\_\_\_ g.p.m. on \_\_\_\_\_  
(Date)

Shut-in pressure at ground surface \_\_\_\_\_ lbs. per sq. in. on \_\_\_\_\_  
(Date)

Water is controlled by \_\_\_\_\_  
(Cap, valve, etc.)

8. Casing: (Give diameter, commercial specifications and depth below ground surface of each casing size.)

6 inch diameter steel std. wt. from 0 to 153 feet  
 inch diameter from to feet  
 inch diameter from to feet  
 inch diameter from to feet

Describe and show depth of shoe, plug, adapter, liner or other details:

9. Perforated Casings or Screens:

(Number per foot and size of perforations, or describe screen)  
 from to  
 from to  
 from to  
 from to

10. Log of Well: (Describe each stratum or formation clearly, indicate if water bearing, and give thickness and depth as indicated.)

MATERIAL	Thickness (Feet)	Depth to Bottom (Feet)
top soil	10	10
Blue clay	25	35
Red clay	25	60
Mixed red & gray clay	22	82
Brown clay with sand layers	13	95
Blue clay	55	150
Blue sand - water bearing	5	155

If log of well is not available, give name and address of driller.

A. M. JANNSSEN DRILLING CO.  
21075 S. W. Tualatin Highway  
ALDHA, OREGON

11. Infiltration Trench: Covered or open .....  
Dimensions: Length ..... ft. Minimum depth ..... ft. Maximum depth ..... ft.  
Bottom width ..... ft. Discharge ..... g.p.m. Date of test .....

12. Tunnel: Type of lining .....  
Dimensions: .....  
(Length, course, and gross sectional size)  
Position of water bearing stratum with reference to portal of tunnel: .....

Log of tunnel: (Preceding table for log of well may be used, if desired. Give footage from portal and character of materials, as pertinent.)

13. Pumping Equipment:  
(a) Pump <sup>15 VRS, Model D, # WDA 405</sup> ~~Sub~~ J. J. ZUZZI, injector Capacity 20 g.p.m.  
(Type, type and size)  
(b) Motor AC, 1 1/2 HP, 60 cycles, C. R. B. 40, 3 pole, 115/230 volts,  
57MPS 1418, Type CI, FR-203, 1 PH, 115/230 volts  
(Type and horsepower)

14. Location of area irrigated or to be irrigated, or place of use if for purposes other than irrigation.

Township North or South	Range E. or W. of Willamette Meridian	Section	Forty-acre Tract	Number Acres To Be Irrigated	Date of Reclamation
1 N	2 W	15	NW 1/4 NW 1/4	<u>4.3</u>	1951
"	"	"	SW 1/4 NW 1/4	<u>0.48</u>	1951
"	"	"	NE 1/4 NW 1/4	<u>2.32</u>	1951
"	"	"	SE 1/4 NW 1/4	<u>0.9</u>	1951
				<u>8.00</u>	

15. If the ground water supply is supplemental to an existing water supply, identification of any application for a permit, permit, certificate or adjudicated right to appropriate water made or held by the registrant.

Township 11 N Range 2 W W.M.  
North

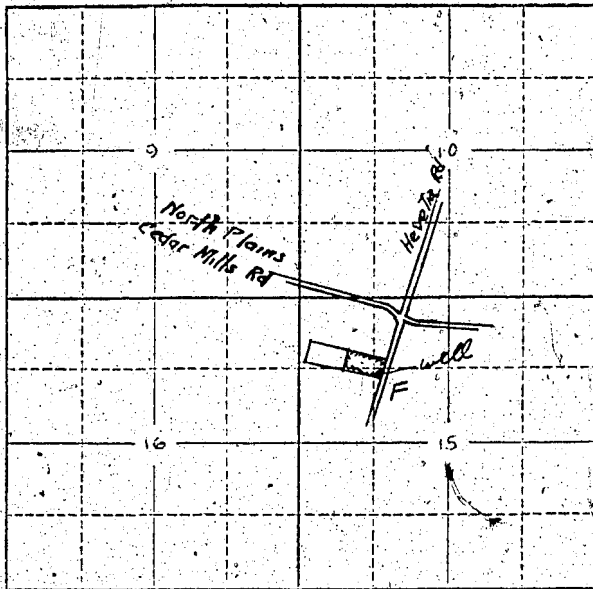

See attachment

Locate well and acreage of irrigated land on plat,  
Scale: 2" = 1 Mile

STATE OF OREGON

County of Washington } ss.

I, Harold D. Smith, being first duly sworn, do hereby certify that I have read the foregoing Registration Statement and that all of the items therein contained are true to the best of my knowledge and belief.

Harold D. Smith  
(Signature of Registrant)

Subscribed and sworn to before me this 30th day of July, 19 58

My commission expires 11/2/58

(Notary Public)

(SEAL)

**CERTIFICATE OF REGISTRATION**

STATE OF OREGON

County of Marion } ss.

This is to certify that the foregoing Registration Statement was received in the office of the State Engineer on the 31st day of July, 19 58, at 1:00 o'clock P.M. and has been duly recorded in said office in Book No. 13 of Registration Statements on page GR 3222.

~~XX Construction shall be completed by 10/30/59 and the water completely applied to beneficial use by 12/31/59. XX~~

Witness my hand this 20th day of July, 19 59

Leura A. Stanley  
(State Engineer)

By

(Deputy)

\$15.00

GR-3222