

# Registration Statement

## OF CLAIMANT OF RIGHT TO APPROPRIATE GROUND WATER.

TO THE STATE ENGINEER OF OREGON:

I, H A Potter  
of 2167 North East Park Ave Salem County of Marion  
State of Oregon do hereby make application for a certificate of registration as evidence  
of a right to appropriate ground water.

1. Source from which water is withdrawn is \_\_\_\_\_  
(Flowing well, pump well, infiltration trench, or tunnel)  
2. Location is: 5 1/2 miles North West Stayton Oregon  
(Approximate distance and direction from nearest city or town)

and is more particularly described as follows:

(a) 312 feet West + 212.5 feet South from NE corner of Sec 23  
(Give distance and bearing to corner of section or other legal subdivision)  
being within SE 1/4 of NE 1/4 of Sec. 23 Twp. 9S Rge. 2W  
(Smallest legal subdivision) (N. or S.) (E. or W.)  
or (b) within limits of recorded platted property, town or city:  
in Lot \_\_\_\_\_ Block \_\_\_\_\_ of \_\_\_\_\_  
(Name of plat or addition)

County of \_\_\_\_\_  
(If within city or town, give name)  
3. Construction Work was begun on JUNE 7, 1949; was completed on JUNE 7, 1949  
(Date) (Date)

and the ground water claimed was first used for the purposes set out below on JUNE 20, 1949  
(Date)  
since which time the water has been used Seasonable  
(Continuously or intermittently)  
from JUNE 20, 1949 to OCT 1957  
(Date) (Date)

4. Quantity of water claimed and used is \_\_\_\_\_ gallons per minute; \_\_\_\_\_ acre  
feet per year.

5. Purpose or Purposes for which water is used Irrigation  
(Domestic, irrigation, municipal, manufacturing, industrial, etc.)

6. Description of Well: Depth 16 feet. Type Dug  
(Dug or drilled)  
diameter \_\_\_\_\_ inches. Elevation of ground at well site \_\_\_\_\_ feet, mean sea level.  
(As near as known)  
Depth to water table 8 feet.

7. Capacity of Well: 200 g.p.m. with 10 feet drawdown.  
200 g.p.m. with 13 feet drawdown.

Date of test None

If Flowing Well: Measured discharge \_\_\_\_\_ g.p.m. on \_\_\_\_\_  
(Date)

Shut-in pressure at ground surface \_\_\_\_\_ lbs. per sq. in. on \_\_\_\_\_  
(Date)

Water is controlled by \_\_\_\_\_  
(Cap. valve, etc.)

8. Casing: (Give diameter, commercial specifications and depth below ground surface of each casing size.)

..... inch diameter ..... from ..... to ..... feet  
..... inch diameter ..... from ..... to ..... feet  
..... inch diameter ..... from ..... to ..... feet  
..... inch diameter ..... from ..... to ..... feet

Describe and show depth of shoe, plug, adapter, liner or other details: .....

9. Perforated Casings or Screens:

..... from ..... to .....  
(Number per foot and size of perforations, or describe screen)  
..... from ..... to .....  
..... from ..... to .....  
..... from ..... to .....

10. Log of Well: (Describe each stratum or formation clearly, indicate if water bearing, and give thickness and depth as indicated.)

MATERIAL	Thickness (Feet)	Depth to Bottom (Feet)
Top Soil, sandy Loam	4	3
Gravel, Rock, Sand	15	13

If log of well is not available, give name and address of driller.

11. Infiltration Trench: Covered or open *open*  
 Dimensions: Length *50'* ft. Minimum depth *16* ft. Maximum depth *16* ft.  
 Bottom width *12* ft. Discharge *200* g.p.m. Date of test

12. Tunnel: Type of lining  
 Dimensions:  
 Position of water bearing stratum with reference to portal of tunnel

Log of tunnel: (Preceding table for log of well may be used, if desired. Give footage from portal and character of materials, as pertinent)

13. Pumping Equipment:

(a) Pump *Fairbank + Morse, Cent.* Capacity \_\_\_\_\_ g.p.m.  
(Make, type and size)

(b) Motor *Electric 10 H.P.*  
(Type and horsepower)

14. Location of area irrigated or to be irrigated, or place of use if for purposes other than irrigation.

Township North or South	Range E. or W. of Willamette Meridian	Section	Forty-acre Tract.	Number Acres To Be Irrigated	Date of Reclamation
<i>T9S</i>	<i>R2W</i>	<i>23</i>	<i>SE 1/4 of NE 1/4</i>	<i>7.0</i>	<i>1949</i>
<i>"</i>	<i>"</i>	<i>23</i>	<i>NE 1/4 of SE 1/4</i>	<i>6.0</i>	<i>"</i>
<i>"</i>	<i>"</i>	<i>24</i>	<i>SW 1/4 of NW 1/4</i>	<i>3.30</i>	<i>"</i>
<i>"</i>	<i>"</i>	<i>24</i>	<i>NW 1/4 of SW 1/4</i>	<i>7.0</i>	<i>"</i>
				<i>23.30</i>	<i>"</i>

15. If the ground water supply is supplemental to an existing water supply, identification of any application for a permit, permit, certificate or adjudicated right to appropriate water made or held by the registrant.

Township 9S Range 2W W.M.  
North

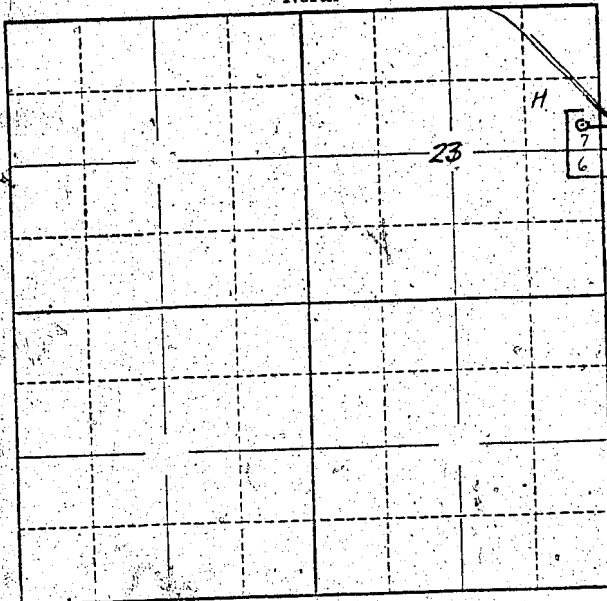

Locate well and acreage of irrigated land on plat.  
Scale: 2" = 1 Mile

STATE OF OREGON

County of Marion

ss.

I, H. A. Potter, being first duly sworn, do hereby certify that I have read the foregoing Registration Statement and that all of the items therein contained are true to the best of my knowledge and belief.

H. A. Potter  
(Signature of Registrant)

Subscribed and sworn to before me this 31st day of July, 1958

My commission expires 12th June 1961

W. S. Bartholomew  
(Notary Public)

(SEAL)

**CERTIFICATE OF REGISTRATION**

STATE OF OREGON

County of Marion

ss.

This is to certify that the foregoing Registration Statement was received in the office of the State Engineer on the 31st day of July, 1958, at 4:45 o'clock P.M. and has been duly recorded in said office in Book No. 14 of Registration Statements on page GR-3242

Witness my hand this 20th day of July, 1959

Stewart A. Stanley  
(State Engineer)

By \_\_\_\_\_ (Deputy)

GR - 3242

\$15.00