

Registration Statement

OF CLAIMANT OF RIGHT TO APPROPRIATE GROUND WATER

TO THE STATE ENGINEER OF OREGON:

I, John W. Young, Trust
 of Box 10, Elsie, Lane Co. County of Lane
(Mailing address)
 State of Oregon, do hereby make application for a certificate of registration as evidence of a right to appropriate ground water.

1. Source from which water is withdrawn is Shallow well
(Flowing well, pump well, infiltration trench, or tunnel)

2. Location is: _____
(Approximate distance and direction from nearest city or town)

and is more particularly described as follows:

(a) 1970 feet north & 1095 feet west from S.E. corner of John Partin D.C. #64
(Give distance and bearing to corner of section or other legal subdivision)

being within N.W. 1/4 of Sec. 27 of Sec. 27, Twp. 30 S. Rge. 3 W.
(Smallest legal subdivision) (N. or S.) (E. or W.)

or (b) within limits of recorded platted property, town or city: _____

in Lot _____, Block _____ of _____
(Name of plat or addition)

County of Lane
(If within city or town, give name)

3. Construction Work was begun on July 23, 1951; was completed on Aug 1, 1951
(Date) (Date)

and the ground water claimed was first used for the purposes set out below on 1951
(Date)

since which time the water has been used intermittently
(Continuously or Intermittently)

from 1951 to 1951
(Date) (Date)

4. Quantity of water claimed and used is 160 gallons per minute; 20.3 acre feet per year.

5. Purpose or Purposes for which water is used irrigation

(Domestic, irrigation, municipal, manufacturing, industrial, etc.)

6. Description of Well: Depth 52 feet. Type auger well drilled
(Dug or drilled)

diameter _____ inches. Elevation of ground at well site 1000 feet, mean sea level.
(As near as known)

Depth to water table 5 feet.

7. Capacity of Well: 175 g.p.m. with 32 feet drawdown.

_____ g.p.m. with _____ feet drawdown.

Date of test 1951

If Flowing Well: Measured discharge _____ g.p.m. on _____
(Date)

Shut-in pressure at ground surface _____ lbs. per sq. in. on _____
(Date)

Water is controlled by _____
(Cap, valve, etc.)

Township 20 S Range 3 W, W.M.
North

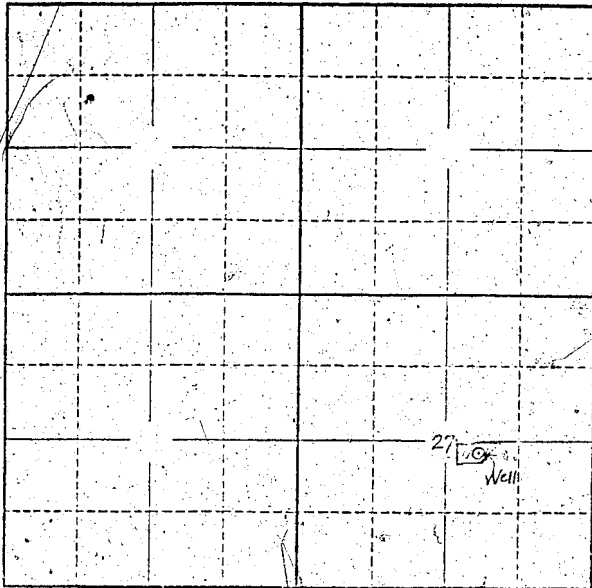

Locate well and acreage of irrigated land on plat.
Scale: 2" = 1 Mile

STATE OF OREGON

County of LANE

ss.

I, John Newkirk, being first duly sworn, do hereby certify that I have read the foregoing Registration Statement and that all of the items therein contained are true to the best of my knowledge and belief.

(Signature of Registrant)

Subscribed and sworn to before me this 27th day of July, 1958

My commission expires 10.15.58

(Notary Public) For Oregon

(SEAL)

CERTIFICATE OF REGISTRATION

STATE OF OREGON

County of Marion

ss.

This is to certify that the foregoing Registration Statement was received in the office of the State Engineer on the 14 day of July, 1958, at 11 o'clock AM and has been duly recorded in said office in Book No. 14 of Registration Statements on page 326

Witness my hand this 20th day of July, 1958

(State Engineer)

By _____ (Deputy)

GR - 3261