

Registration Statement

OF CLAIMANT OF RIGHT TO APPROPRIATE GROUND WATER

TO THE STATE ENGINEER OF OREGON:

I, ERNEST M. JOHANNE MEYER

of ROUTE 3 HILLSBORO County of WASHINGTON

State of OREGON, do hereby make application for a certificate of registration as evidence of a right to appropriate ground water.

1. Source from which water is withdrawn is WMP No. 1
(Flowing well, pump well, infiltration trench, or tunnel)

2. Location is: 5 Miles North Hillsboro on North Plains Road
(Approximate distance and direction from nearest city or town)

and is more particularly described as follows:

(a) N 72° 30' East 310' to NE corner Sec 12
(Give distance and bearing to corner of section or other legal subdivision)

being within NW 1/4 NE 1/4 of Sec. 12, Twp. 1 N., Rge. 3 W.
(Smallest legal subdivision) (N. or S.) (E. or W.)

or (b) within limits of recorded platted property, town or city: NORTH PLAINS

in Lot 80 & 21, Block _____ of NORTH PLAINS
(Name of plat or addition)

County of WASHINGTON
(If within city or town, give name)

3. Construction Work was begun on SEPT 1947; was completed on SEP 1947
(Date) (Date)

and the ground water claimed was first used for the purposes set out below on MAY 1948
(Date)

since which time the water has been used INTERMITTENTLY
(Continuously or intermittently)

from 1948 to DATE
(Date) (Date)

4. Quantity of water claimed and used is 10 gallons per minute; 3 acre feet per year.

5. Purpose or Purposes for which water is used IRRIGATION (Also used for domestic)

(Domestic, irrigation, municipal, manufacturing, industrial, etc.)

6. Description of Well: Depth 145 feet. Type DUG
(Dug or drilled)

diameter: 6 inches. Elevation of ground at well site 200 feet, mean sea level.
(As near as known)

Depth to water table 12 feet.

7. Capacity of Well: 10 g.p.m. with 38 feet drawdown.
_____ g.p.m. with _____ feet drawdown.

Date of test During Recent Normal

If Flowing Well: Measured discharge _____ g.p.m. _____ (Date)

Shut-in pressure at ground surface 105 lbs. per sq. in. on _____ (Date)

Water is controlled by _____
(Cap, valve, etc.)

Township 1 N Range 3 W W.M.
North

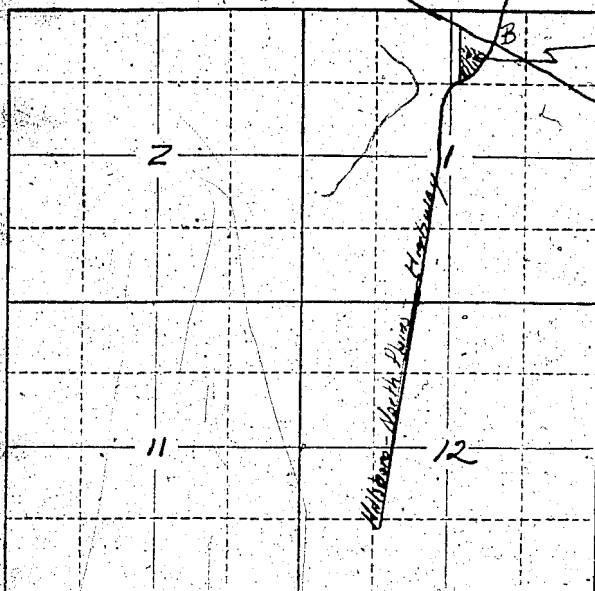

Locate well and acreage of irrigated land on plat.
Scale: 2" = 1 Mile

STATE OF OREGON

County

Washington

ss.

I,

Ernest Meyer

, being first duly sworn, do hereby certify that I have read the foregoing Registration Statement and that all of the items therein contained are true to the best of my knowledge and belief.

x

Ernest Meyer

(Signature of Registrant)

Subscribed and sworn to before me this 30 day of July, 1958

My commission expires

Volman F. De Fries
(Notary Public)

(SEAL)

CERTIFICATE OF REGISTRATION

STATE OF OREGON

County of Marion

ss.

This is to certify that the foregoing Registration Statement was received in the office of the State Engineer on the _____ day of _____, 1958, at _____ o'clock _____ M. and has been duly recorded in said office in Book No. 14 of Registration Statements on page GR-3280

Witness my hand this 20 day of July, 1958

[Signature]
(State Engineer)

By

(Deputy)

GR-3280

4/500