

Registration Statement

OF CLAIMANT OF RIGHT TO APPROPRIATE GROUND WATER

TO THE STATE ENGINEER OF OREGON:

I, W.C. Mason
of Milton-Freewater, R. #3 Box 275 County of Umatilla
(Mailing address)

State of Oregon, do hereby make application for a certificate of registration as evidence of a right to appropriate ground water.

1. Source from which water is withdrawn is pump well
(Flowing well, pump well, infiltration trench, or tunnel)

2. Location is: 4 3/4 Miles Northwest from Milton-Freewater, Oregon
(Approximate distance and direction from nearest city or town)

and is more particularly described as follows:

(a) 547 ft. South from apt. 19 ft. West from NE cor of SE 1/4 NW 1/4 sec 2
(Give distance and bearing to corner of section or other legal subdivision) T. 6 N. R. 35. E. 1/4 M.

being within Sec. 29 of Sec. 29, Twp. 6 N., Rge. 35 E. 1/4 M.
(Smallest legal subdivision) (N. or S.) (E. or W.)

or (b) within limits of recorded platted property, town or city: _____

in Lot _____, Block _____ of _____
(Name of plat or addition)

County of Umatilla
(If within city or town, give name)

3. Construction Work was begun on Feb. 1 1922; was completed on April 30 1922
(Date) (Date)

and the ground water claimed was first used for the purposes set out below on June 1 1922
(Date)

since which time the water has been used continuously (except 1956)
(Continuously or intermittently)

from June 1 1922 to Sept. 20 1957.
(Date) (Date)

4. Quantity of water claimed and used is 200 gallons per minute; 135 acre feet per year.

5. Purpose or Purposes for which water is used Irrigation.

(Domestic, irrigation, municipal, manufacturing, industrial, etc.)

6. Description of Well: Depth 75 feet. Type Dug 49 ft. drilled 24 ft.
Dug part, cement curb 3, 5, 5 ft. by 27 ft. depth or drilled.
diameter _____ inches. Elevation of ground at well site 760 (approx.) feet, mean sea level.
(As near as known)

Depth to water table 20 to 40 feet. varies according to time of year

7. Capacity of Well: 220 g.p.m. with 45 feet drawdown. during June
_____ g.p.m. with _____ feet drawdown.

Date of test Made only in connection with pumping operations

If Flowing Well: Measured discharge _____ g.p.m. on _____
(Date)

Shut-in pressure at ground surface _____ lbs. per sq. in. on _____
(Date)

Water is controlled by _____
(Cap, valve, etc.)

If log of well is not available, give name and address of driller. Drillers deceased.

11. Infiltration Trench: Covered or open

Dimensions: Length ft. Minimum depth ft. Maximum depth ft.

Bottom width ft. Discharge g.p.m. Date of test

12. Tunnel: Type of lining

Dimensions:
(Length, course, and cross sectional size)

Position of water bearing stratum with reference to portal of tunnel

Log of tunnel: (Preceding table for log of well may be used, if desired. Give footage from portal and character of materials, as pertinent.)

13. Pumping Equipment: delivers 225 G.P.M. to head 40'

(a) Pump Sterling 2 1/2 centrifugal Capacity 225 g.p.m.
(Make, type and size)

(b) Motor 3 H.P. single phase U.S. Motor
(Type and horsepower)

14. Location of area irrigated or to be irrigated, or place of use if for purposes other than irrigation.

Township North or South	Range E. or W. of Willamette Meridian	Section	Forty-acre Tract	Number Acres To Be Irrigated	Date of Reclamation
6 N.	35 E.	29	SE 1/4 of NW 1/4	10.2	June 1 1922

15. If the ground water supply is supplemental to an existing water supply, identification of any application for a permit, permit, certificate or adjudicated right to appropriate water made or held by the registrant.

Water right adjudicated for 10 acres, Hudson Bay Milton-Freewater canal Walla

Walla River adjudication proceedings 1932, also seepage water permit # 6318. Cert. # 7720.

Township 6N Range 35E W.M.
North

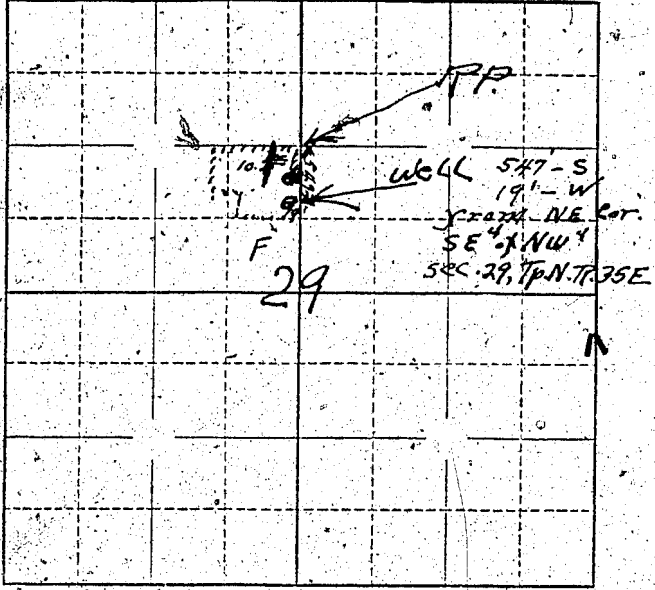

Locate well and acreage of irrigated land on plat.

Scale: $\frac{1}{4}$ " = 1 Mile
 $\frac{1}{8}$ " = 1 Mile

STATE OF OREGON

County of _____

I, _____, being first duly sworn, do hereby certify that I have read the foregoing Registration Statement and that all of the items therein contained are true to the best of my knowledge and belief.

[Signature]
(Signature of Registrant)

Subscribed and sworn to before me this 21st day of July 1958

My commission expires July 26, 1962
(Notary Public)

(SEAL)

CERTIFICATE OF REGISTRATION

STATE OF OREGON

County of Marion

This is to certify that the foregoing Registration Statement was received in the office of the State Engineer on the _____ day of _____, 19____ at _____ o'clock _____ M. and has been duly recorded in said office in Book No. 14 of Registration Statements on page GR-3285

Witness my hand this 30 day of July 1958

[Signature]
(State Engineer)

By _____
(Deputy)

\$15.00

GR - 3285