

Registration Statement

OF CLAIMANT OF RIGHT TO APPROPRIATE GROUND WATER

TO THE STATE ENGINEER OF OREGON:

I, Page Walton

of 1225 Escadr. Blvd., Eugene County of Lane
(Mailing address)

State of Oregon, do hereby make application for a certificate of registration as evidence of a right to appropriate ground water.

1. Source from which water is withdrawn is pump well
(Flowing well, pump well, infiltration trench, or tunnel)

2. Location is: 7 miles north of Eugene
(Approximate distance and direction from nearest city or town)

and is more particularly described as follows:

(a) From SW corner Sec. 36, T10N R36E
(Give distance and bearing to corner of section or other legal subdivision)

being within 1/4 Sec. 36 of Sec. 36, Twp. 10N, Rge. 36E
(Smallest legal subdivision) (N. or S.) (E. or W.)

or (b) within limits of recorded platted property, town or city:

in Lot _____, Block _____ of _____
(Name of plat or addition)

County of _____
(If within city or town, give name)

3. Construction Work was begun on March 1957; was completed on March 1957
(Date) (Date)

and the ground water claimed was first used for the purposes set out below on March 1957
(Date)

since which time the water has been used intermittently
(Continuously or intermittently)

from March to October
(Date) (Date)

4. Quantity of water claimed and used is 150 gallons per minute; _____ acre feet per year.

5. Purpose or Purposes for which water is used irrigation

(Domestic, irrigation, municipal, manufacturing, industrial, etc.)

6. Description of Well: Depth _____ feet. Type driven
(Dug or drilled)

diameter _____ inches. Elevation of ground at well site 376 feet, mean sea level.
(As near as known)

Depth to water table _____ feet.

7. Capacity of Well: 150 g.p.m. with _____ feet drawdown.

Maximum capacity with _____ feet drawdown _____ g.p.m. with _____ feet drawdown.

Date of test _____

If Flowing Well: Measured discharge _____ g.p.m. on _____
(Date)

Shut-in pressure at ground surface _____ lbs. per sq. in. on _____
(Date)

Water is controlled by _____
(Cap, valve, etc.)

8. Casing: (Give diameter, commercial specifications and depth below ground surface of each casing size.)

..... inch diameter from 0 to 21 feet
 inch diameter from to feet
 inch diameter from to feet
 inch diameter from to feet

Describe and show depth of shoe, plug, adapter, liner or other details:

.....

9. Perforated Casings or Screens:

..... from to
 (Number per foot and size of perforations, or describe screen)
 from to
 from to
 from to

10. Log of Well: (Describe each stratum or formation clearly, indicate if water bearing, and give thickness and depth as indicated.)

MATERIAL	Thickness (Feet)	Depth to Bottom (Feet)

If log of well is not available, give name and address of driller D. J. Dickinson
1280 River Road, Tualatin, Oregon

11. Infiltration Trench: Covered or open

Dimensions: Length ft. Minimum depth ft. Maximum depth ft.

Bottom width ft. Discharge g.p.m. Date of test

12. Tunnel: Type of lining

Dimensions:
(Length, course, and cross sectional size)

Position of water bearing stratum with reference to portal of tunnel

Log of tunnel: (Preceding table for log of well may be used, if desired. Give footage from portal and character of materials, as pertinent.)

13. Pumping Equipment:

(a) Pump Eimco's Pump, centrifugal, 2"x1" Capacity 150 g.p.m.
(Make, type and size)

(b) Motor Eimco's pump, 3 phase, 220 volt, 7 1/2 hp
(Type and horsepower)

14. Location of area irrigated or to be irrigated, or place of use if for purposes other than irrigation.

Township North or South	Range E. or W. of Willamette Meridian	Section	Forty-acre Tract	Number Acres To Be Irrigated	Date of Reclamation
109	154	7	W. SW 1/4 of Sec 7	10	March 1963

15. If the ground water supply is supplemental to an existing water supply, identification of any application for a permit, permit, certificate or adjudicated right to appropriate water made or held by the registrant.

Township 16 S Range 4 W, W.M.

North

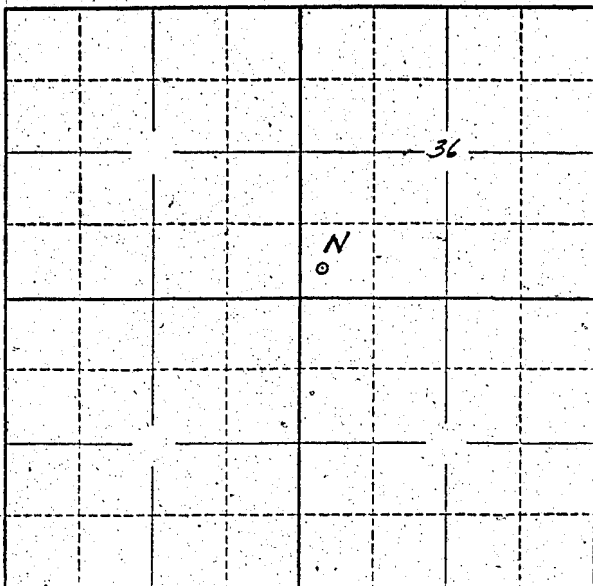

Locate well and acreage of irrigated land on plat.

Scale: 2" = 1 Mile

STATE OF OREGON

County of Lane } ss.

I, Page Wilson, being first duly sworn, do hereby certify that I have read the foregoing Registration Statement and that all of the items therein contained are true to the best of my knowledge and belief.

Page Wilson
(Signature of Registrant)

Subscribed and sworn to before me this 1st day of August, 1958

My commission expires 9-29-60 D. G. Young
(Notary Public)

(SEAL)

CERTIFICATE OF REGISTRATION

STATE OF OREGON

County of Marion } ss.

This is to certify that the foregoing Registration Statement was received in the office of the State Engineer on the 1st day of August, 1958, at 9:00 o'clock A. M. and has been duly recorded in said office in Book No. 14 of Registration Statements on page GR 3317

Witness my hand this 20th day of July, 1959

Stuart A. Standley
(State Engineer)

By _____ (Deputy)

\$15.00

GR - 3317