

Registration Statement

OF CLAIMANT OF RIGHT TO APPROPRIATE GROUND WATER

TO THE STATE ENGINEER OF OREGON:

I, Lloyd H. Tenney
of 1730 Thomas Road, Medford, County of Jackson
(Mailing address)

State of Oregon do hereby make application for a certificate of registration as evidence of a right to appropriate ground water.

1. Source from which water is withdrawn is Pump Well
(Flowing well, pump well, infiltration trench, or tunnel)

2. Location is: 3 miles west of Medford, Oregon
(Approximate distance and direction from nearest city or town)

and is more particularly described as follows:

(a) 1261 feet north and 915 feet East from the SW corner SEC 35
(Give distance and bearing to corner of section or other legal subdivision)

being within NW 1/4 SW 1/4 SE 1/4 of Sec. 35, Twp. 37 S. Rge. 2 W.
(Smallest legal subdivision) (N. or S.) (E. or W.)

or (b) within limits of recorded platted property, town or city:

in Lot _____, Block _____ of _____
(Name of plat or addition)

County of _____
(If within city or town, give name)

3. Construction Work was begun on 1929; was completed on 1929
(Date) (Date)

and the ground water claimed was first used for the purposes set out below on 1929
(Date)

since which time the water has been used continuously
(Continuously or intermittently)

from 1929 to present
(Date) (Date)

4. Quantity of water claimed and used is 50 gallons per minute; 18 acre feet per year.

5. Purpose or Purposes for which water is used irrigation

(Domestic, irrigation, municipal, manufacturing, industrial, etc.)

6. Description of Well: Depth 15 feet. Type dug
(Dug or drilled)

diameter 10' x 20' inches. Elevation of ground at well site 1150 feet, mean sea level.
(As near as known)

Depth to water table 2.0 feet.

7. Capacity of Well: _____ g.p.m. with _____ feet drawdown.

_____ g.p.m. with _____ feet drawdown.

Date of test _____

If Flowing Well: Measured discharge _____ g.p.m. on _____
(Date)

Shut-in pressure at ground surface _____ lbs. per sq. in. on _____
(Date)

Water is controlled by _____
(Cap, valve, etc.)

8. Casing: (Give diameter, commercial specifications and depth below ground surface of each casing size.)

..... inch diameter none from to feet
..... inch diameter from to feet
..... inch diameter from to feet
..... inch diameter from to feet

Describe and show depth of shoe, plug, adapter, liner or other details:
.....
.....

9. Perforated Casings or Screens:

..... from to
(Number per foot and size of perforations, or describe screen)
..... from to
..... from to
..... from to

10. Log of Well: (Describe each stratum or formation clearly, indicate if water bearing, and give thickness and depth as indicated.)

MATERIAL	Thickness (Feet)	Depth to Bottom (Feet)
not known		

If log of well is not available, give name and address of driller: Alfred P. Flanery

Madford, Oregon

11. Infiltration Trench: Covered or open
Dimensions: Length ft. Minimum depth ft. Maximum depth ft.
Bottom width ft. Discharge g.p.m. Date of test

12. Tunnel: Type of lining
Dimensions: (Length, course, and cross sectional size)
Position of water bearing stratum with reference to portal of tunnel

Log of tunnel: (Preceding table for log of well may be used, if desired. Give footage from portal and character of materials, as pertinent.)

13. Pumping Equipment:
(a) Pump 2" centrifugal Capacity g.p.m.
(b) Motor 1 1/2 H.P. electric motor

14. Location of area irrigated or to be irrigated, or place of use if for purposes other than irrigation.

Table with 6 columns: Township North or South, Range E. or W. of Willamette Meridian, Section, Forty-acre Tract, Number Acres To Be Irrigated, Date of Reclamation. Row 1: 37 S., 2 W., 35, 2NW SW SD, 3.75, 1929

15. If the ground water supply is supplemental to an existing water supply, identification of any application for a permit, permit, certificate or adjudicated right to appropriate water made or held by the registrant.

Township 37 S Range 2 W, W.M.

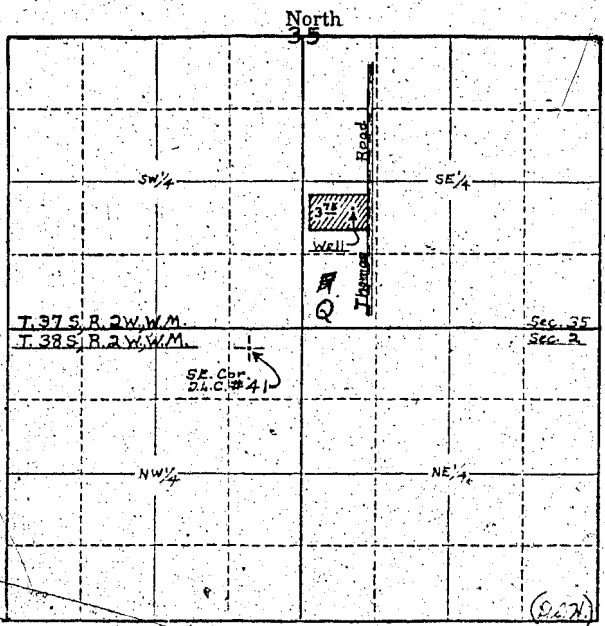

Locate well and acreage of irrigated land on plat.
Scale: 4" = 1 Mile

STATE OF OREGON }
County of Jackson } ss.

I, Lloyd H. Tenney, being first duly sworn, do hereby certify that I have read the foregoing Registration Statement and that all of the items therein contained are true to the best of my knowledge and belief.

Lloyd H. Tenney
(Signature of Registrant)

Subscribed and sworn to before me this 21st day of July, 1950.

My commission expires Nov. 22-1960
(Notary Public)

(SEAL)

CERTIFICATE OF REGISTRATION

STATE OF OREGON }
County of Marion } ss.

This is to certify that the foregoing Registration Statement was received in the office of the State Engineer on the 15 day of August, 1950, at 2 o'clock P.M. and has been duly recorded in said office in Book No. 14 of Registration Statements on page GR-3332

Witness my hand this 20th day of August, 1950

George R. Stensley
(State Engineer)

By _____
(Deputy)

GR 3332

15.00