

# Registration Statement

## OF CLAIMANT OF RIGHT TO APPROPRIATE GROUND WATER

TO THE STATE ENGINEER OF OREGON:

I, Walter C. Hicks  
of 1125 Midway Road, Medford, County of DELAWARE  
(Mailing address)

State of Oregon, do hereby make application for a certificate of registration as evidence of a right to appropriate ground water.

1. Source from which water is withdrawn is Sump  
(Flowing well, pump well, infiltration trench, or tunnel)

2. Location is: 1 1/2 miles north of Medford, Oregon  
(Approximate distance and direction from nearest city or town)

and is more particularly described as follows:

(a) 920 feet South and 1250 feet East from the N. corner of Section 13  
(Give distance and bearing to corner of section or other legal subdivision)

being within SE 1/4 NW 1/4 of Sec. 13, Twp. 37, Rge. 2  
(Smallest legal subdivision) (N. or S.) (E. or W.)

or (b) within limits of recorded platted property, town or city:

in Lot \_\_\_\_\_, Block \_\_\_\_\_ of \_\_\_\_\_  
(Name of plat or addition)

County of \_\_\_\_\_  
(If within city or town, give name)

3. Construction Work was begun on 1927; was completed on 1927  
(Date) (Date)

and the ground water claimed was first used for the purposes set out below on 1-27  
(Date)

since which time the water has been used continuously  
(Continuously or intermittently)

from 1927 to present  
(Date) (Date)

4. Quantity of water claimed and used is 75 gallons per minute; 9.0 acre feet per year.

5. Purpose or Purposes for which water is used Irrigation  
(Domestic, irrigation, municipal, manufacturing, industrial, etc.)

6. Description of ~~well~~ SUMP: Depth 14 feet. Type D.G.  
(Dug or drilled)

diameter 25 1/2 inches. Elevation of ground at well site 1310 feet, mean sea level.  
(As near as known)

Depth to water table 6 feet.

7. Capacity of Well: 75 g.p.m. with no feet drawdown.

         g.p.m. with          feet drawdown.

Date of test noted from use.

If Flowing Well: Measured discharge          g.p.m. on          (Date)

Shut-in pressure at ground surface          lbs. per sq. in. on          (Date)

Water is controlled by           
(Cap, valve, etc.)

8. Casing: (Give diameter, commercial specifications and depth below ground surface of each casing size.)

..... inch diameter    none ..... from ..... to ..... feet  
 ..... inch diameter ..... from ..... to ..... feet  
 ..... inch diameter ..... from ..... to ..... feet  
 ..... inch diameter ..... from ..... to ..... feet

Describe and show depth of shoe, plug, adapter, liner or other details:

.....  
 .....

9. Perforated Casings or Screens:

..... from ..... to .....  
 (Number per foot and size of perforations, or describe screen)  
 ..... from ..... to .....  
 ..... from ..... to .....  
 ..... from ..... to .....

10. Log of Well: (Describe each stratum or formation clearly, indicate if water bearing, and give thickness and depth as indicated.)

MATERIAL	Thickness (Feet)	Depth to Bottom (Feet)
loam water bearing at 8 feet.	10	10
travel on bottom of shaft--	unknown	unknown

If log of well is not available, give name and address of driller.

11. Infiltration Trench: Covered or open

Dimensions: Length ft. Minimum depth ft. Maximum depth ft.

Bottom width ft. Discharge g.p.m. Date of test

12. Tunnel: Type of lining

Dimensions: (Length, course, and cross sectional size)

Position of water bearing stratum with reference to portal of tunnel

Log of tunnel: (Preceding table for log of well may be used, if desired. Give footage from portal and character of materials, as pertinent.)

13. Pumping Equipment:

(a) Pump 1 1/2" x 1 1/2" centrifugal Capacity 70 g.p.m. (Make, type and size)

(b) Motor 5 H.P. gasoline engine. (Type and horsepower)

14. Location of area irrigated or to be irrigated, or place of use if for purposes other than irrigation.

Table with 6 columns: Township North or South, Range E. or W. of Willamette Meridian, Section, Forty-acre Tract, Number Acres To Be Irrigated, Date of Reclamation. Row 1 contains handwritten data: S., W., 13, SE 1/4 NW 1/4 NE 1/4, 4.0, 1927.

15. If the ground water supply is supplemental to an existing water supply, identification of any application for a permit, permit, certificate or adjudicated right to appropriate water made or held by the registrant.

Township 37 S Range 2 W W.M.

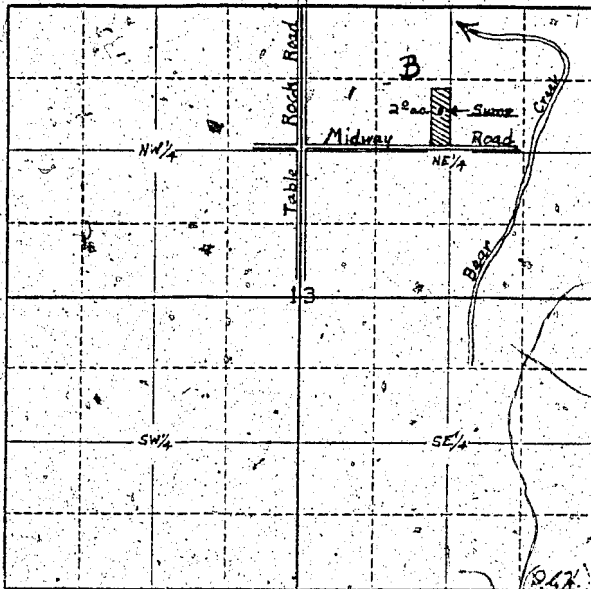

Locate well and acreage of irrigated land on plat.  
Scale: 4" = 1 Mile

STATE OF OREGON

County of Jackson ss.

I, Walter C. Hicks, being first duly sworn, do hereby certify that I have read the foregoing Registration Statement and that all of the items therein contained are true to the best of my knowledge and belief.

X  
(Signature of Registrant)

Subscribed and sworn to before me this 31st day of July, 1959

My commission expires August 25, 1958

(Notary Public)

(SEAL)

**CERTIFICATE OF REGISTRATION**

STATE OF OREGON

County of Marion ss.

This is to certify that the foregoing Registration Statement was received in the office of the State Engineer on the 20th day of August, 1959, at 2 o'clock PM and has been duly recorded in said office in Book No. 14 of Registration Statements on page GR-3333

Witness my hand this 20th day of August, 1959

W. A. Stanley  
(State Engineer)

By \_\_\_\_\_ (Deputy)

GR - 3333

\$1,500