

Registration Statement

OF CLAIMANT OF RIGHT TO APPROPRIATE GROUND WATER

TO THE STATE ENGINEER OF OREGON:

I, Fred R. Kuest

of 1910 Beall Lane, Medford, County of Jackson
(Mailing address)

State of Oregon, do hereby make application for a certificate of registration as evidence of a right to appropriate ground water.

1. Source from which water is withdrawn is (SUMM) infiltration trench 3.175' of tubing
(Flowing well, pump well, infiltration trench, or tunnel)

2. Location is: 1 mile South of Central Point, Oregon
(Approximate distance and direction from nearest city or town)

and is more particularly described as follows:

(a) 298' North and 1.52' East from the NW corner of DIC 266
(Give distance and bearing to corner of section or other legal subdivision)

being within NW 1/4 SW 1/4 S 1 of Sec. 10, Twp. 31 S., Rge. 2 W.
(Smallest legal subdivision) (N. or S.) (E. or W.)

or (b) within limits of recorded platted property, town or city:

in Lot _____, Block _____ of _____
(Name of plat or addition)

County of _____
(If within city or town, give name)

3. Construction Work was begun on 1947, was completed on 1947
(Date) (Date)

and the ground water claimed was first used for the purposes set out below on 1947
(Date)

since which time the water has been used continuously
(Continuously or Intermittently)

from 1947 to present
(Date) (Date)

4. Quantity of water claimed and used is 250 gallons per minute; 104 acre feet per year.

5. Purpose or Purposes for which water is used irrigation
(Domestic, irrigation, municipal, manufacturing, industrial, etc.)

6. Description of Well: Depth 10 feet. Type Dug
(Dug or drilled)

diameter 21.25 inches. Elevation of ground at well site 1300 feet, mean sea level.
(As near as known)

Depth to water table 4.0 feet.

7. Capacity of Well: 250 g.p.m. with 6.0 feet drawdown.

_____ g.p.m. with _____ feet drawdown.

Date of test noted above

If Flowing Well: Measured discharge _____ g.p.m. on _____
(Date)

Shut-in pressure at ground surface _____ lbs. per sq. in. on _____
(Date)

Water is controlled by _____
(Cap, valve, etc.)

8. Casing: (Give diameter, commercial specifications and depth below ground surface of each casing size.)

..... inch diameter ^{sides} Summ is concrete lined on / from 0 to 18 feet
..... inch diameter from to feet
..... inch diameter from to feet
..... inch diameter from to feet

Describe and show depth of shoe, plug, adapter, liner or other details:

9. Perforated Casings or Screens:

..... from to
(Number per foot and size of perforations, or describe screen)
..... from to
..... from to
..... from to

10. Log of Well: (Describe each stratum or formation clearly, indicate if water bearing, and give thickness and depth as indicated.)

MATERIAL	Thickness (Feet)	Depth to Bottom (Feet)
black top soil	5	12
sandy loam.	4	8
granite and gravel (water bearing)	3	6

If log of well is not available, give name and address of driller.

11. Infiltration Trench: Covered or open open

Dimensions: Length 48 ft. Minimum depth 18 ft. Maximum depth 18 ft.

Bottom width 24 ft. Discharge g.p.m. Date of test

12. Tunnel: Type of lining

Dimensions:
(Length, course, and cross sectional size)

Position of water bearing stratum with reference to portal of tunnel

Log of tunnel: (Preceding table log of well may be used, if desired. Give footage from portal and character of materials, as pertinent.)

13. Pumping Equipment:

(a) Pump: 3" x 2.5" centrifugal pump (Fairbanks-Morse) Capacity g.p.m.
(Make, type and size)

(b) Motor 7.5 H.P. electric motor
(Type and horsepower)

14. Location of area irrigated or to be irrigated, or place of use if for purposes other than irrigation.

Township North or South	Range E. or W. of Willamette Meridian	Section	Forty-acre Tract	Number Acres To Be Irrigated	Date of Reclamation
37 S.	2 W.	10	SE, NE, SW	1.1 acres	1947
			NE, SE, SW	0.9 acre	1947
			S, NW, SE	11.4 acres	1947
			N, SW, SE	9.6 acres	1947
			Total	23.0 acres	

15. If the ground water supply is supplemental to an existing water supply, identification of any application for a permit, permit, certificate or adjudicated right to appropriate water made or held by the registrant.

none

Township 37 S Range 2 W, W.M.
North

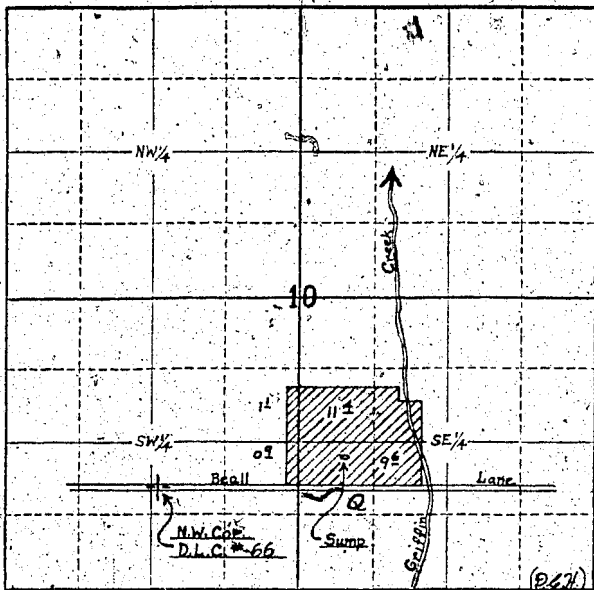

Locate well and acreage of irrigated land on plat.
Scale: **4" = 1 Mile**

STATE OF OREGON

County of Jackson

} ss.

I, Fred R. Kuest, being first duly sworn, do hereby certify that I have read the foregoing Registration Statement and that all of the items therein contained are true to the best of my knowledge and belief.

X
.....
(Signature of Registrant)

Subscribed and sworn to before me this 31st day of July, 1958

My commission expires August 25, 1958

.....
(Notary Public)

(SEAL)

CERTIFICATE OF REGISTRATION

STATE OF OREGON

County of Marion

} ss.

This is to certify that the foregoing Registration Statement was received in the office of the State Engineer on the day of, 1958, at o'clock 1 M. and has been duly recorded in said office in Book No. 14 of Registration Statements on page GR-3336

Witness my hand this 20th day of August, 1959

W. A. Stanley
(State Engineer)

By
(Deputy)

GR-3336

115.00