

Registration Statement

OF CLAIMANT OF RIGHT TO APPROPRIATE GROUND WATER

Well Pump No. 2

TO THE STATE ENGINEER OF OREGON:

I, Charles F. DeFoe
of Box 127 Honbar County of Curry
(Mailing address)

State of Oregon, do hereby make application for a certificate of registration as evidence of a right to appropriate ground water. Form address is 500 W. Beacon Drive Junction City, Oregon

1. Source from which water is withdrawn is Pump Well
(Flowing well, pump well, infiltration trench, or tunnel)

2. Location is: 7 mi. N. of Eugene Oregon
(Approximate distance and direction from nearest city or town)

and is more particularly described as follows: 1625 feet west & 150 feet North from Ely corner Section 34

(a) See legal description
(Give distance and bearing to corner of section or other legal subdivision)

being within SW 1/4 of NE 1/4 of Sec. 34, Twp. 16 S, Rge. 4 W
(Smallest legal subdivision) (S. or S.) (E. or W.)

or (b) within limits of recorded platted property, town or city:

in Lot _____, Block _____ of _____
(Name of plat or addition)

County of _____
(If within city or town, give name)

3. Construction Work was begun on 1952, was completed on 1952
(Date) (Date)

and the ground water claimed was first used for the purposes set out below on 1952
(Date)

since which time the water has been used Continuously
(Continuously or intermittently)

from 1952 to 1958
(Date) (Date)

4. Quantity of water claimed and used is 150 gallons per minute; 3 acre feet per year.

5. Purpose or Purposes for which water is used irrigation

(Domestic, irrigation, municipal, manufacturing, industrial, etc.)

6. Description of Well: Depth 100 ft feet. Type Drilled
(Dug or drilled)

diameter 8 inches. Elevation of ground at well site _____ feet, mean sea level.
(As near as known)

Depth to water table 100 ft feet.

7. Capacity of Well: 1500 g.p.m. with _____ feet drawdown.

_____ g.p.m. with _____ feet drawdown.

Date of test _____

If Flowing Well: Measured discharge _____ g.p.m. on _____
(Date)

Shut-in pressure at ground surface _____ lbs. per sq. in. on _____
(Date)

Water is controlled by _____
(Cap, valve, etc.)

Township 16 S Range 4 N, W.M.
North

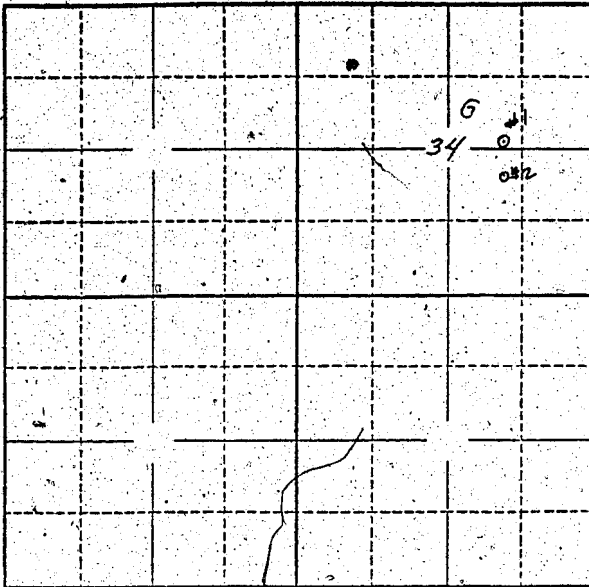

Locate well and acreage of irrigated land on plat.
Scale: 2" = 1 Mile

STATE OF OREGON

County of Cicero } ss.

I, Charles E. Dipe, being first duly sworn, do hereby certify that I have read the foregoing Registration Statement and that all of the items therein contained are true to the best of my knowledge and belief.

Charles E. Dipe
(Signature of Registrant)

Subscribed and sworn to before me this 1st day of August, 1958

My commission expires June 9, 1962 Maryann Reinhard
(Notary Public)

(SEAL)

CERTIFICATE OF REGISTRATION

STATE OF OREGON } ss.
County of Marion

This is to certify that the foregoing Registration Statement was received in the office of the State Engineer on the 4th day of August, 1958, at 8:00 o'clock A.M. and has been duly recorded in said office in Book No. 16 of Registration Statements on page GR-3925

Witness my hand this 15th day of February, 1960

LUNA A. Stanley
(State Engineer)

By _____
(Deputy)

\$15.00

GR 3925