

Registration Statement

OF CLAIMANT OF RIGHT TO APPROPRIATE GROUND WATER

TO THE STATE ENGINEER OF OREGON:

I, PAUL K. WISER

of Rt #1 Box 150 Silverton County of MARION
(Mailing address)

State of OREGON, do hereby make application for a certificate of registration as evidence of a right to appropriate ground water.

1. Source from which water is withdrawn is INFILTRATION TRENCH
(Flowing well, pump well, infiltration trench, or tunnel)

2. Location is: 2 1/2 MI E OF SILVERTON
(Approximate distance and direction from nearest city or town)

and is more particularly described as follows:

(a) 6020' N 70° 45' E OF SW COR SEC 31
(Give distance and bearing to corner of section or other legal subdivision)

being within N 1/4 S 1/4 S 1/4 of Sec. 31, Twp. 6 S, Rge. 1 E
(Smallest legal subdivision) (N. or S.) (E. or W.)

or (b) within limits of recorded platted property, town or city: NONE

in Lot _____, Block _____ of _____
(Name of plat or addition)

County of _____
(If within city or town, give name)

3. Construction Work was begun on JUNE 15, 1955; was completed on JUNE 30, 1955
(Date) (Date)

and the ground water claimed was first used for the purposes set out below on JULY 6, 1955
(Date)

since which time the water has been used CONTINUOUSLY
(Continuously or intermittently)

from JULY 6, 1955 to AUG 4, 1958 (TO PRESENT)
(Date) (Date)

4. Quantity of water claimed and used is 70 gallons per minute; 12 acre feet per year.

5. Purpose or Purposes for which water is used IRRIGATION

(Domestic, irrigation, municipal, manufacturing, industrial, etc.)

6. Description of Well: Depth _____ feet. Type HOLE DUG
(Dug or drilled)

diameter _____ inches. Elevation of ground at well site _____ feet, mean sea level.
(As near as known)

Depth to water table _____ feet.

7. Capacity of Well: Not available g.p.m. with _____ feet drawdown.

_____ g.p.m. with _____ feet drawdown.

Date of test _____

If Flowing Well: Measured discharge _____ g.p.m. on NONE
(Date)

Shut-in pressure at ground surface _____ lbs. per sq. in. on _____
(Date)

Water is controlled by _____
(Cap, valve, etc.)

If log of well is not available, give name and address of driller.

11. Infiltration Trench: Covered or open OPEN
 Dimensions: Length 225 ft. Minimum depth 50 ft. Maximum depth 60 ft.
 Bottom width 25 ft. Discharge 70 g.p.m. Date of test MAY 15, 1958

12. Tunnel: Type of lining NONE
 Dimensions:
(Length, course, and cross sectional size)
 Position of water bearing stratum with reference to portal of tunnel

Log of tunnel: (Preceding table for log of well may be used, if desired. Give footage from portal and character of materials, as pertinent.)

13. Pumping Equipment:
 (a) Pump BERKLEY 2" CENTRIFUGAL Capacity 70 g.p.m.
(Make, type and size)
 (b) Motor ELEC 5 HP
(Type and horsepower)

14. Location of area irrigated or to be irrigated, or place of use if for purposes other than irrigation.

Township North or South	Range E. or W. of Williamsite Meridian	Section	Forty-acre Tract	Number Acres To Be Irrigated	Date of Reclamation
65	R1E	31	SW4, SW4	3.0	7-1-55

This is a infiltration trench that gets its source of water from underground flaws only. Little or no surface water is used for irrigation.

15. If the ground water supply is supplemental to an existing water supply, identification of any application for a permit, permit, certificate or adjudicated right to appropriate water made or held by the registrant.
None

SEE ATTACHED MAP.

Township 6 S Range 1 E W.M.
North

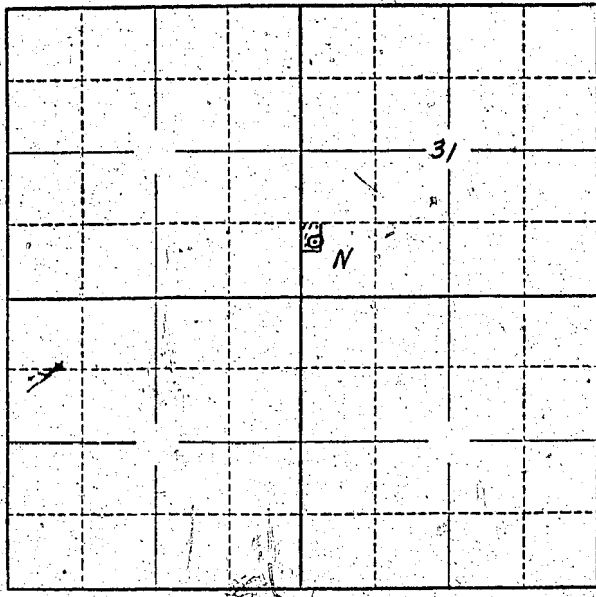

Locate well and acreage of irrigated land on plat.

Scale: 2" = 1 Mile

STATE OF OREGON

County of Marion } ss.

I, Paul K. Wiser, being first duly sworn, do hereby certify that I have read the foregoing Registration Statement and that all of the items therein contained are true to the best of my knowledge and belief.

Paul K. Wiser
(Signature of Registrant)

Subscribed and sworn to before me this 1st day of August, 19 58.

My commission expires January 15, 1960
(Notary Public)

(SEAL)

CERTIFICATE OF REGISTRATION

STATE OF OREGON } ss.
County of Marion

This is to certify that the foregoing Registration Statement was received in the office of the State Engineer on the 1 day of August, 19 58, at 1:30 o'clock P. M. and has been duly recorded in said office in Book No. 14 of Registration Statements on page GR-3374

Witness my hand this 20th day of August, 19 59

Russ A. Stanley
(State Engineer)

By _____ (Deputy)

\$15.00

GR - 3374