

Registration Statement

OF CLAIMANT OF RIGHT TO APPROPRIATE GROUND WATER

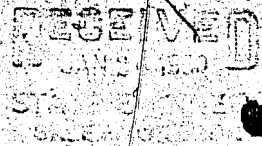

TO THE STATE ENGINEER OF OREGON:

I, Robin D. Day and Janice E. Day
of Rt. 2, Box 87, Salem County of Marion
(Mailing address)
State of Oregon, do hereby make application for a certificate of registration as evidence of a right to appropriate ground water.

1. Source from which water is withdrawn is Pump Well #2
(Flowing well, pump well, infiltration trench, or tunnel)

2. Location is: North of Salem and 7 miles from Ladd & Bush Bank, Salem;
(Approximate distance and direction from nearest city or town)

and is more particularly described as follows:

(a) 2040 feet west and 1290 feet north from SE Corner Section 21
(Give distance and bearing to corner of section or other legal subdivision)

being within SW 1/4 of SE 1/4 of Sec. 21, Twp. 6 S., Rge. 3 W.
(Smallest legal subdivision) (N. or S.) (E. or W.)

or (b) within limits of recorded platted property, town or city:

in Lot _____, Block _____ of _____
(Name of plat or addition)

County of _____
(If within city or town, give name)

3. Construction Work was begun on 1942; was completed on 1942
(Date) (Date)

and the ground water claimed was first used for the purposes set out below on 1942
(Date)

since which time the water has been used intermittently
(Continuously or intermittently)

from 1942 to and including 1948
(Date) (Date)

4. Quantity of water claimed and used is 200 gallons per minute; _____ acre feet per year. Depends on the year and the kind of crops on it.

5. Purpose or Purposes for which water is used irrigation
(Domestic, irrigation, municipal, manufacturing, industrial, etc.)

6. Description of Well: Depth 40 feet. Type drill
(Dug or drilled)

diameter _____ inches; Elevation of ground at well site 100 feet, mean sea level.
(As near as known)

Depth to water table _____ feet.

7. Capacity of Well: 200 g.p.m. with no feet drawdown.

_____ g.p.m. with _____ feet drawdown.

Date of test every year when pump is put in

If Flowing Well: Measured discharge _____ g.p.m. on _____
(Date)

Shut-in pressure at ground surface _____ lbs. per sq. in. on _____
(Date)

Water is controlled by _____
(Cap, valve, etc.)

8. Casing: (Give diameter, commercial specifications and depth below ground surface of each casing size.)

6 inch diameter from top to 40 feet

inch diameter from to feet

inch diameter from to feet

inch diameter from to feet

Describe and show depth of shoe, plug, adapter, liner or other details:

9. Perforated Casings or Screens:

Screens at bottom from to

(Number per foot and size of perforations, or describe screen)

..... from to

..... from to

..... from to

10. Log of Well: (Describe each stratum or formation clearly, indicate if water bearing, and give thickness and depth as indicated.)

MATERIAL	Thickness (Feet)	Depth to Bottom (Feet)
Plain river bottom soil	30	
then sand and gravel		

Township 6S Range 3W, W.M.
North

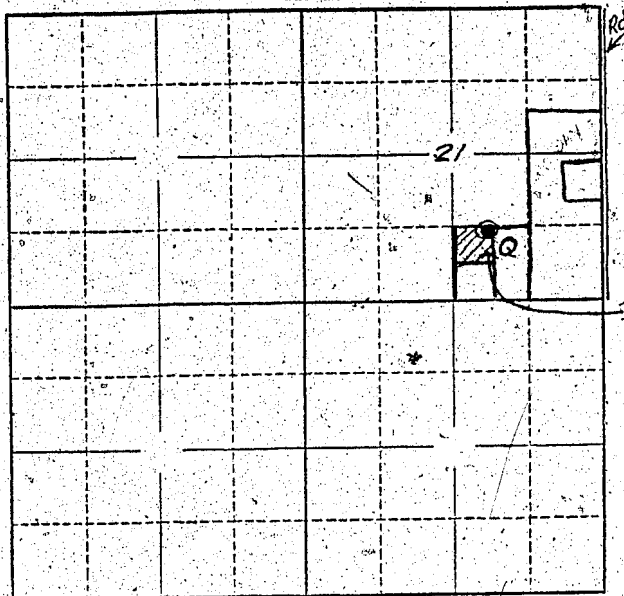

Locate well and acreage of irrigated land on plat.
Scale: 2" = 1 Mile

STATE OF OREGON

County of Marion

ss.

I, Robin D. Day, being first duly sworn, do hereby certify that I have read the foregoing Registration Statement and that all of the items therein contained are true to the best of my knowledge and belief.

Robin D. Day
(Signature of Registrant)

Subscribed and sworn to before me this 31st day of July, 1958

My commission expires 9/25/59

Bryan Chase
(Notary Public)

(SEAL)

CERTIFICATE OF REGISTRATION

STATE OF OREGON

County of Marion

ss.

This is to certify that the foregoing Registration Statement was received in the office of the State Engineer on the 1 day of August, 1958, at 8:00 o'clock A. M. and has been duly recorded in said office in Book No. 16 of Registration Statements on page GR-3941

Witness my hand this 15th day of February, 1960

Laura A. Stanley
(State Engineer)

By _____
(Deputy)

\$15.00