

Registration Statement

OF CLAIMANT OF RIGHT TO APPROPRIATE GROUND WATER

TO THE STATE ENGINEER OF OREGON:

I, Herbert E. Childs

of 1515 Brook Lane, Corvallis County of Benton
(Mailing address)

State of Oregon do hereby make application for a certificate of registration as evidence of a right to appropriate ground water.

1. Source from which water is withdrawn is pump well
(Flowing well, pump well, infiltration trench, or tunnel)

2. Location is: 1 1/2 miles SW of center of city of Corvallis
(Approximate distance and direction from nearest city or town)

and is more particularly described as follows:

(a) 7.018 chains plus approx. 90 ft. north 0° 10' west and approx. 110 ft. east of SW corner of Joseph C. Avery DLO (Distance and bearing to corner of section or other legal subdivision) being within NW 1/4 of SW 1/4 of Sec. 3, Twp. 12 S, Rge. 5 W
(Smallest legal subdivision) (N. or S.) (E. or W.)

or (b) within limits of recorded platted property, town or city:

in Lot _____, Block _____ of _____
(Name of plat or addition)

County of _____
(If within city or town, give name)

3. Construction Work was begun on probably 1923, was completed on probably 1923
(Date) (Date)

and the ground water claimed was first used for the purposes set out below on probably 1923 - 1940
(Date)

since which time the water has been used continuously
(Continuously or intermittently)

from 1923 to 1 Aug. 1958, date of this application.
(Date) (Date)

4. Quantity of water claimed and used is 3 gallons per minute; 2 acre feet per year.

5. Purpose or Purposes for which water is used _____

non-commercial irrigation
(Domestic, irrigation, municipal, manufacturing, industrial, etc.)

6. Description of Well: Depth approx. 25 feet. Type drilled
(Dug or drilled)
3/4" pipe in 1 1/2" casing
diameter _____ inches. Elevation of ground at well site approx. 285 feet, mean sea level.
(As near as known)

Depth to water table approx. 12 feet.

7. Capacity of Well: 3 g.p.m. with unknown _____ feet drawdown.

_____ g.p.m. with _____ feet drawdown.

Date of test 30 July 1958

If Flowing Well: Measured discharge _____ g.p.m. on _____
(Date)

Shut-in pressure at ground surface _____ lbs. per sq. in. on _____
(Date)

Water is controlled by _____
(Cap, valve, etc.)

Township 12S Range 5W, W.M.
North

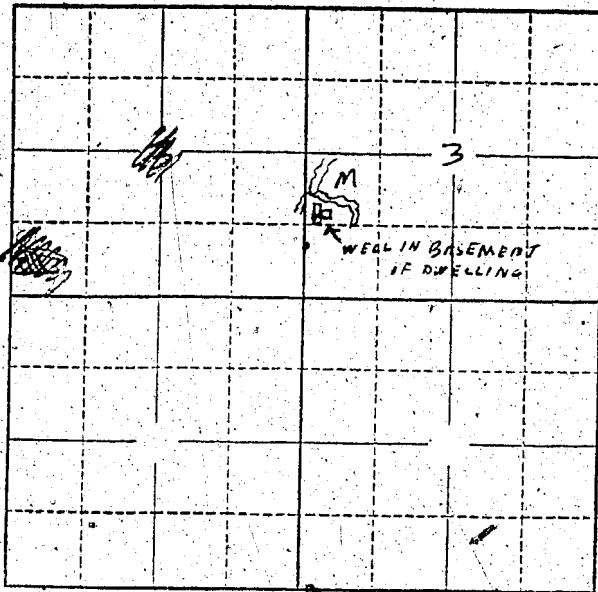

Locate well and acreage of irrigated land on plat.
Scale: 2" = 1 Mile

STATE OF OREGON

County of Benton } ss.

I, Herbert E. Childs, being first duly sworn, do hereby certify that I have read the foregoing Registration Statement and that all of the items therein contained are true to the best of my knowledge and belief.

Herbert E. Childs
(Signature of Registrant)

Subscribed and sworn to before me this 31 day of July, 1959.

NOTARY PUBLIC FOR OREGON

My commission expires Aug. 21, 1960

Geo. M. ...
(Notary Public)

(SEAL)

CERTIFICATE OF REGISTRATION

STATE OF OREGON } ss.
County of Marion

This is to certify that the foregoing Registration Statement was received in the office of the State Engineer on the 1 day of August, 1959, at 8:00 o'clock A. M. and has been duly recorded in said office in Book No. 14 of Registration Statements on page GR-3379

Witness my hand this 20th day of August, 1959

Lewis A. Stanley
(State Engineer)

By _____ (Deputy)

GR 3379

\$15.00