

RECEIVED
AUG 1 1958
STATE ENGINEER
SALEM, OREGON

Registration No. GR-3706
Certificate No. GR-4086

Registration Statement

OF CLAIMANT OF RIGHT TO APPROPRIATE GROUND WATER

TO THE STATE ENGINEER OF OREGON:

I, Frank J. Glass
of 301 1/2 Milken Dr. Eugene, County of Linn
(Mailing address)

State of Oregon, do hereby make application for a certificate of registration as evidence of a right to appropriate ground water.

- 1. Source from which water is withdrawn is pump well #2
(Flowing well, pump well, infiltration trench, or tunnel)
- 2. Location is: One mile North and one-half mile East of Eugene, Ore.
(Approximate distance and direction from nearest city or town)

and is more particularly described as follows: 358.96 North and 259208 East of N.W. Cor. Lawrence Poindexter D.L.C. #52, T.17 S.R.4W. W.M.

(a) being within S.W. 1/4 S.W. 1/4 of Sec. 1, Twp. 17 S, Rge. 4 W.
(Smallest legal subdivision) (N. or S.) (E. or W.)

or (b) within limits of recorded platted property, town or city:
in Lot _____, Block _____ of _____
(Name of plat or addition)
County of Linn
(If within city or town, give name)

3. Construction Work was begun on _____; was completed on _____
(Date) (Date)

and the ground water claimed was first used for the purposes set out below on _____
(Date)

since which time the water has been used _____
(Continuously or intermittently)

from _____ to _____
(Date) (Date)

4. Quantity of water claimed and used is 400 gallons per minute; 12.5 acre feet per year.

5. Purpose or Purposes for which water is used _____
(Domestic, irrigation, municipal, manufacturing, industrial, etc.)

6. Description of Well: Depth 27 feet. Type _____ (Dug or drilled)
diameter _____ inches. Elevation of ground at well site _____ feet, mean sea level.
(As near as known)
Depth to water table _____ feet.

7. Capacity of Well: _____ g.p.m. with _____ feet drawdown.
_____ g.p.m. with _____ feet drawdown.

Date of test _____

If Flowing Well: Measured discharge _____ g.p.m. on _____ (Date)

Shut-in pressure at ground surface _____ lbs. per sq. in. on _____ (Date)

Water is controlled by _____ (Cap, valve, etc.)

If log of well is not available, give name and address of driller.

11. Infiltration Trench: Covered or open

Dimensions: Length ft. Minimum depth ft. Maximum depth ft.

Bottom width ft. Discharge g.p.m. Date of test

12. Tunnel: Type of lining

Dimensions: (Length, course, and cross sectional size)

Position of water bearing stratum with reference to portal of tunnel

Log of tunnel: (Preceding table for log of well may be used, if desired. Give footage from portal and character of materials, as pertinent.)

13. Pumping Equipment:

(a) Pump P.M. 3 3/4 In Capacity g.p.m.
(Make, type and size)

(b) Motor 10 H.P. 3 ph.
(Type and horsepower)

14. Location of area irrigated or to be irrigated, or place of use if for purposes other than irrigation.

Township North or South	Range E. or W. of Willamette Meridian	Section	Forty-acre Tract	Number Acres To Be Irrigated	Date of Reclamation
T 17 S	R 4 W	1	SW 1/4 SW 1/4	8.0	1951
T 17 N	R 4 W	1	NE 1/4 SW 1/4	3.5	"
T 17 N	R 4 W	1	SE 1/4 SW 1/4	8.5	"
				20.00 TOTAL	

15. If the ground water supply is supplemental to an existing water supply, identification of any application for a permit, permit, certificate or adjudicated right to appropriate water made or held by the registrant.

Township 17 S Range 4 W W.M.
North

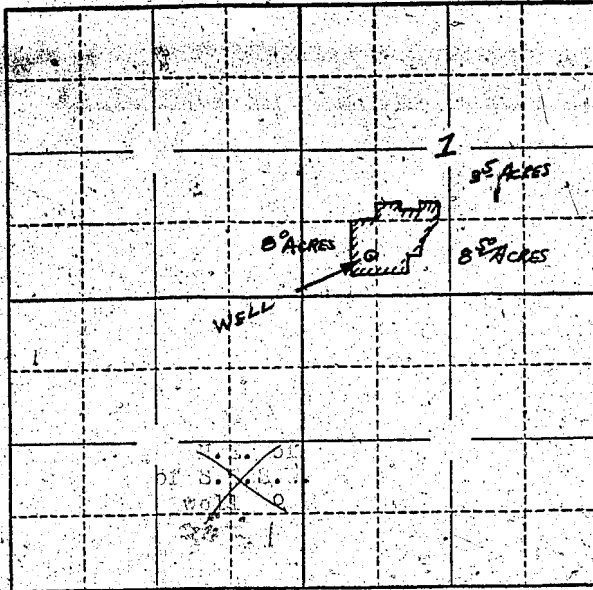

Locate well and acreage of irrigated land on plat.
Scale: 2" = 1 Mile

STATE OF OREGON

County of _____ } ss.

I, _____, being first duly sworn, do hereby certify that I have read the foregoing Registration Statement and that all of the items therein contained are true to the best of my knowledge and belief.

Paul E. Head
(Signature of Registrant)

Subscribed and sworn to before me this _____ day of _____, 1955.
My Commission Expires April 10, 1962

My commission expires _____

William K. Schaper
(Notary Public)

(SEAL)

CERTIFICATE OF REGISTRATION

STATE OF OREGON

County of Marion } ss.

This is to certify that the foregoing Registration Statement was received in the office of the State Engineer on the 1 day of August, 1955, at 8:00 o'clock A. M. and has been duly recorded in said office in Book No. 17 of Registration Statements on page GR-4086

Witness my hand this 16th day of May, 1960.

LEWIS A. STANLEY
(State Engineer)

By *Max F. Rogers*
Max F. Rogers (Deputy)

\$15.00

GR 4086