

Registration Statement

OF CLAIMANT OF RIGHT TO APPROPRIATE GROUND WATER

TO THE STATE ENGINEER OF OREGON:

I, Hancy B. Ray
of Route 2, Box 73, Eugene County of Linn
(Mailing address)

State of Oregon, do hereby make application for a certificate of registration as evidence of a right to appropriate ground water.

1. Source from which water is withdrawn is pump well
(Flowing well, pump well, infiltration trench, or tunnel)

2. Location is: 4 miles north Eugene
(Approximate distance and direction from nearest city or town)

and is more particularly described as follows:

(a) 597' North and 129' East of the NW cor. of the Dan'l S. Snelling D.L.C. 41
(Give distance and bearing to corner of section or other legal subdivision)
being within 1/4 Sec. 18 of Sec. 18, Twp. 17S, Rge. 3W
(Smallest legal subdivision) (N. or S.) (E. or W.)

or (b) within limits of recorded platted property, town or city:
in Lot _____, Block _____ of _____
(Name of plat or addition)

_____ County of _____
(If within city or town, give name)

3. Construction Work was begun on January 1938; was completed on May 1938
(Date) (Date)
and the ground water claimed was first used for the purposes set out below on May 1938
(Date)

since which time the water has been used intermittently
(Continuously or intermittently)
from May 1938 to July 1958
(Date) (Date)

4. Quantity of water claimed and used is 640 gallons per minute; _____ acre feet per year.

5. Purpose or Purposes for which water is used _____
(Domestic, irrigation, municipal, manufacturing, industrial, etc.)

6. Description of Well: Depth 20 feet. Type six 2" pipes
(Dug or drilled)
diameter 6-2" pipes inches. Elevation of ground at well site 400 feet, mean sea level.
(As near as known)
Depth to water table 18 feet.

7. Capacity of Well: 300 g.p.m. with _____ feet drawdown.
_____ g.p.m. with _____ feet drawdown.

Date of test not tested

If Flowing Well: Measured discharge _____ g.p.m. on _____
(Date)

Shut-in pressure at ground surface _____ lbs. per sq. in. on _____
(Date)

Water is controlled by _____
(Cap, valve, etc.)

Township 17 S Range 3 W, W.M.
North

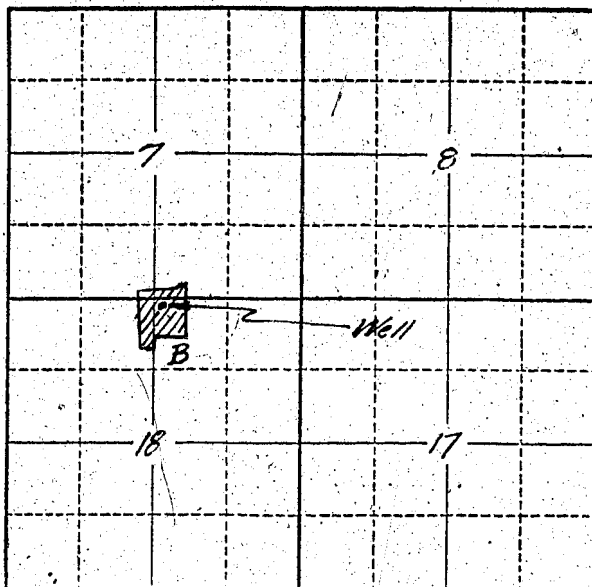

Locate well and acreage of irrigated land on plat.
Scale: 2" = 1 Mile

STATE OF OREGON

County of Lane } ss.

I, Nancy B. Ray, being first duly sworn, do hereby certify that I have read the foregoing Registration Statement and that all of the items therein contained are true to the best of my knowledge and belief.

Nancy B. Ray
(Signature of Registrant)

Subscribed and sworn to before me this 31st day of July, 1958.

My commission expires January 1, 1959
(Notary Public)

(SEAL)

CERTIFICATE OF REGISTRATION

STATE OF OREGON } ss.
County of Marion

This is to certify that the foregoing Registration Statement was received in the office of the State Engineer on the 1st day of August, 1958, at 2:00 o'clock A.M. and has been duly recorded in said office in Book No. 14 of Registration Statements on page GR-3395

Witness my hand this 20th day of August, 1959.

Lewis A. Stanley
(State Engineer)

By _____ (Deputy)

\$15.00

GR. **3395**