

RECEIVED
AUG 1 1958

STATE ENGINEER
SALEM, OREGON

Registration No. GR - 3724

Certificate No. GR - 3398

Registration Statement

OF CLAIMANT OF RIGHT TO APPROPRIATE GROUND WATER

TO THE STATE ENGINEER OF OREGON:

I, Orval D White

of Rt 2 Box 159 Forest Grove County of Washington

State of Oregon, do hereby make application for a certificate of registration as evidence of a right to appropriate ground water.

1. Source from which water is withdrawn is Pump Well
(Flowing well, pump well, infiltration trench, or tunnel)

2. Location is: 1 mile E. of Forest Grove on Highway 8
(Approximate distance and direction from nearest city or town)

and is more particularly described as follows:

(a) 130' North and 120' East of the SW Corner Sec. 33
(Give distance and bearing to corner of section or other legal subdivision)

being within SE 1/4 of SE 1/4 of Sec. 32, Twp. 1N, Rge. 3W
(Smallest legal subdivision) (N. or S.) (E. or W.)

or (b) within limits of recorded platted property, town or city:

in Lot _____, Block _____ of _____
(Name of plat or addition)

County of Washington
(If within city or town, give name)

3. Construction Work was begun on 1945; was completed on 1945
(Date) (Date)

and the ground water claimed was first used for the purposes set out below on 1945
(Date)

since which time the water has been used Domestic & Irrigation continuously
(Continuously or intermittently)

from 1945 to 1958
(Date) (Date)

4. Quantity of water claimed and used is 10 gallons per minute; 2.5 acre feet per year.

5. Purpose or Purposes for which water is used _____

Domestic and Irrigation
(Domestic, irrigation, municipal, manufacturing, industrial, etc.)

6. Description of Well: Depth 50 feet. Type Drilled
(Dug or drilled)

diameter 22 inches. Elevation of ground at well site _____ feet, mean sea level.
(As near as known)

Depth to water table 1 feet.

7. Capacity of Well: 15 g.p.m. with _____ feet drawdown.

_____ g.p.m. with _____ feet drawdown.

Date of test 1945

If Flowing Well: Measured discharge _____ g.p.m. on _____
(Date)

Shut-in pressure at ground surface _____ lbs. per sq. in. on _____
(Date)

Water is controlled by _____
(Cap, valve, etc.)

Township 1N Range 3W, W.M.
North

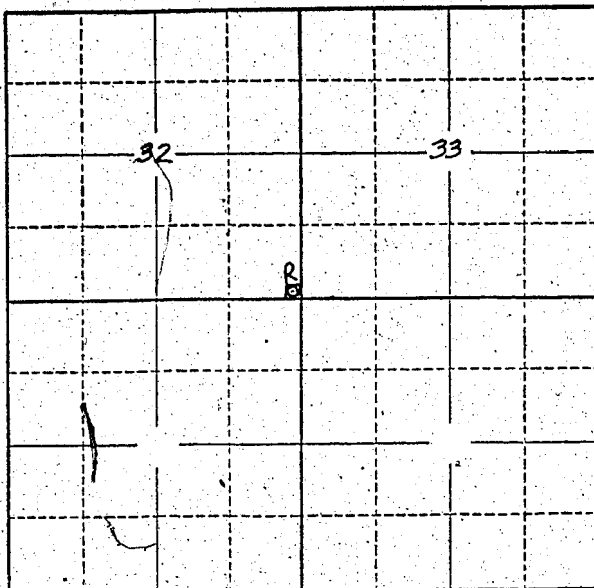

Locate well and acreage of irrigated land on plat.
Scale: 2" = 1 Mile

STATE OF OREGON

County of _____ } ss.

I, Orval W. White, being first duly sworn, do hereby certify that I have read the foregoing Registration Statement and that all of the items therein contained are true to the best of my knowledge and belief.

Orval W. White
(Signature of Registrant)

Subscribed and sworn to before me this 26th day of March, 1958

My commission expires 12th June 1961

Wm. S. Bartholomew
(Notary Public)

(SEAL) ♡

CERTIFICATE OF REGISTRATION

STATE OF OREGON

County of Marion } ss.

This is to certify that the foregoing Registration Statement was received in the office of the State Engineer on the 1st day of August, 1958, at 2.00 o'clock A. M. and has been duly recorded in said office in Book No. 14 of Registration Statements on page GR-3398

Witness my hand this 20th day of August, 1959

Lewis A. Stanley
(State Engineer)

\$1.50

By _____ (Deputy)

GR 3398