

Registration Statement

OF CLAIMANT OF RIGHT TO APPROPRIATE GROUND WATER

TO THE STATE ENGINEER OF OREGON:

I, EDWARD M. BUCHHEITof Route 2 Box 68 Silverton County of Marion
(Mailing address)State of Oregon, do hereby make application for a certificate of registration as evidence of a right to appropriate ground water.1. Source from which water is withdrawn is One Pump Well
(Flowing well, pump well, infiltration trench, or tunnel)2. Location is: 2 Mi. NW of Silverton
(Approximate distance and direction from nearest city or town)

and is more particularly described as follows:

(a) 7 Ch. S and 7 Ch. E from the N 1/4 corner of Section 28
(Give distance and bearing to corner of section or other legal subdivision)being within NW 1/4 NE 1/4 of Sec. 28, Twp. 6 S, Rge. 1 W
(Smallest legal subdivision) (N. or S.) (E. or W.)

or (b) within limits of recorded platted property, town or city:

in Lot _____, Block _____ of _____
(Name of plat or addition)County of Marion
(If within city or town, give name)3. Construction Work was begun on June 5, 1949; was completed on July 10, 1949
(Date) (Date)and the ground water claimed was first used for the purposes set out below on Aug 15, 1949
(Date)since which time the water has been used Intermittantly
(Continuously or intermittently)from Aug 15, 1949 to Present
(Date) (Date)4. Quantity of water claimed and used is 140 gallons per minute; 6.2 acre feet per year.5. Purpose or Purposes for which water is used Irrigation
(Domestic, irrigation, municipal, manufacturing, industrial, etc.)6. Description of Well: Depth 114 feet. Type Drilled
(Dug or drilled)
diameter 8 inches. Elevation of ground at well site 76 feet, mean sea level.
(As near as known)Depth to water table 20 feet.7. Capacity of Well: 230 g.p.m. with 50 feet drawdown.

_____ g.p.m. with _____ feet drawdown.

Date of test Aug 10, 1949If Flowing Well: Measured discharge _____ g.p.m. on _____
(Date)Shut-in pressure at ground surface _____ lbs. per sq. in. on _____
(Date)Water is controlled by _____
(Cap, valve, etc.)

8. Casing: (Give diameter, commercial specifications and depth below ground surface of each casing size.)

8 inch diameter from Top to 100 feet
..... inch diameter from to feet
..... inch diameter from to feet
..... inch diameter from to feet

Describe and show depth of shoe, plug, adapter, liner or other details:

9. Perforated Casings or Screens:



Not Known from to
(Number per foot and size of perforations, or describe screen)
..... from to
..... from to
..... from to

10. Log of Well: (Describe each stratum or formation clearly, indicate if water bearing, and give thickness and depth as indicated.)

MATERIAL	Thickness (Feet)	Depth to Bottom (Feet)
<i>Not Known</i>		

If log of well is not available, give name and address of driller. James Ballweber

Rt. 2 Box 90 Woodburn

11. Infiltration Trench: Covered or open
 Dimensions: Length ft. Minimum depth ft. Maximum depth ft.

Bottom width ft. Discharge g.p.m. Date of test

12. Tunnel: Type of lining

Dimensions:
(Length, course, and cross sectional size)

Position of water bearing stratum with reference to portal of tunnel

Log of tunnel: (Preceding table for log of well may be used, if desired. Give footage from portal and character of materials, as pertinent.)

13. Pumping Equipment:

(a) Pump Lane Bowler Turbine Capacity 200 g.p.m.
(Make, type and size)

(b) Motor 15 H.P. Electric
(Type and horsepower)

14. Location of area irrigated or to be irrigated, or place of use if for purposes other than irrigation.

Township North or South	Range E. or W. of Willamette Meridian	Section	Forty-acre Tract	Number Acres To Be Irrigated	Date of Reclamation
<u>6 S</u>	<u>1 W</u>	<u>28</u>	<u>NW 1/4 NE 1/4</u>	<u>45.8</u>	<u>Aug 15, 1949</u>
<u>"</u>	<u>"</u>	<u>"</u>	<u>NE 1/4 NW 1/4</u>	<u>5.2</u>	<u>"</u>
				<u>20.8</u>	<u>"</u>

15. If the ground water supply is supplemental to an existing water supply, identification of any application for a permit, permit, certificate or adjudicated right to appropriate water made or held by the registrant.
None

Township 6 S Range 1 W, W.M.

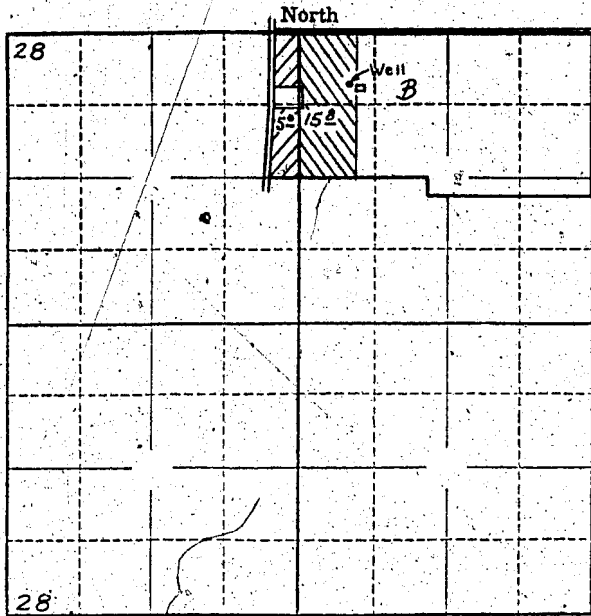

Locate well and acreage of irrigated land on plat.

Scale: $\frac{1}{4}$ " = 1 Mile

STATE OF OREGON

County of Marion } ss.

I, Edward M. Buchheit, being first duly sworn, do hereby certify that I have read the foregoing Registration Statement and that all of the items therein contained are true to the best of my knowledge and belief.

Edward M. Buchheit
(Signature of Registrant)

Subscribed and sworn to before me this 1st day of August, 1958.

My commission expires Sept. 8, 1960

John S. Wheeler
(Notary Public)

(SEAL)

CERTIFICATE OF REGISTRATION

STATE OF OREGON

County of Marion } ss.

This is to certify that the foregoing Registration Statement was received in the office of the State Engineer on the 1st day of August, 1958, at 3:00 o'clock P. M. and has been duly recorded in said office in Book No. 14 of Registration Statements on page GR 3403.

Witness my hand this 20th day of August, 1959

Lewis A. Stanley
(State Engineer)

By _____
(Deputy)

\$15.00

GR 3403