

RECEIVED

Registration No. GR - 3745

APR 11 1960  
STATE ENGINEER  
SALEM, OREGON

Certificate No. GR - 4046

# Registration Statement

## OF CLAIMANT OF RIGHT TO APPROPRIATE GROUND WATER

TO THE STATE ENGINEER OF OREGON:

I, Edward C. Gorman  
of Route 1, Box 230, Woodburn County of Marion  
State of Oregon, do hereby make application for a certificate of registration as evidence  
of a right to appropriate ground water.

- 1. Source from which water is withdrawn is Pump well  
(Flowing well, pump well, infiltration trench, or tunnel)
- 2. Location is: 1 mi. N. of Woodburn, on Boone's Ferry Rd.  
(Approximate distance and direction from nearest city or town)

and is more particularly described as follows:

(a) 1050 feet west & 300 feet south from E 1/4 corner of Section 6  
(Give distance and bearing to corner of section or other legal subdivision)  
being within NE 1/4 of SE 1/4 of Sec. 6, Twp. 5S, Rge. 1W  
(Smallest legal subdivision) (N. or S.) (E. or W.)

or (b) within limits of recorded-platted property, town or city:  
in Lot \_\_\_\_\_, Block \_\_\_\_\_ of PM. Gleason DLC  
(Name of plat or addition)  
County of \_\_\_\_\_  
(If within city or town, give name)

3. Construction Work was begun on 1947; was completed on 1947  
(Date) (Date)  
and the ground water claimed was first used for the purposes set out below on 1950  
(Date)  
since which time the water has been used intermittently during season  
(Continuously or Intermittently)  
from 1950 to Oct. 1957  
(Date) (Date)

4. Quantity of water claimed and used is 30 gallons per minute; \_\_\_\_\_ acre feet per year.

5. Purpose or Purposes for which water is used  
irrigation  
(Domestic, irrigation, municipal, manufacturing, industrial, etc.)

6. Description of Well: Depth 106 feet. Type Drilled  
(Dug or drilled)  
diameter 6 inches. Elevation of ground at well site \_\_\_\_\_ feet, mean sea level.  
(As near as known)  
Depth to water table unk feet.

7. Capacity of Well: \_\_\_\_\_ g.p.m. with \_\_\_\_\_ feet drawdown.  
\_\_\_\_\_ g.p.m. with \_\_\_\_\_ feet drawdown.  
Date of test NO

If Flowing Well: Measured discharge \_\_\_\_\_ g.p.m. on \_\_\_\_\_  
(Date)  
Shut-in pressure at ground surface \_\_\_\_\_ lbs. per sq. in. on \_\_\_\_\_  
(Date)  
Water is controlled by \_\_\_\_\_  
(Cap, valve, etc.)

8. **Casing:** (Give diameter, commercial specifications and depth below ground surface of each casing size.)

6 inch diameter *steel casing* from 0 to 106 feet  
 inch diameter from to feet  
 inch diameter from to feet  
 inch diameter from to feet

Describe and show depth of shoe, plug, adapter, liner or other details:

9. **Perforated Casings or Screens:**

*unk* from to  
 (Number per foot and size of perforations, or describe screen)  
 from to  
 from to  
 from to

10. **Log of Well:** (Describe each stratum or formation clearly, indicate if water bearing, and give thickness and depth as indicated.)

| MATERIAL   | Thickness (Feet) | Depth to Bottom (Feet) |
|------------|------------------|------------------------|
| <i>unk</i> |                  |                        |
|            |                  |                        |
|            |                  |                        |
|            |                  |                        |
|            |                  |                        |
|            |                  |                        |
|            |                  |                        |
|            |                  |                        |
|            |                  |                        |
|            |                  |                        |
|            |                  |                        |
|            |                  |                        |
|            |                  |                        |
|            |                  |                        |
|            |                  |                        |
|            |                  |                        |
|            |                  |                        |
|            |                  |                        |
|            |                  |                        |
|            |                  |                        |
|            |                  |                        |
|            |                  |                        |
|            |                  |                        |

If log of well is not available, give name and address of driller. Wink

11. Infiltration Trench: Covered or open .....

Dimensions: Length ..... ft. Minimum depth ..... ft. Maximum depth ..... ft.

Bottom width ..... ft. Discharge ..... g.p.m. Date of test .....

12. Tunnel: Type of lining .....

Dimensions: .....  
(Length, course, and cross sectional size)

Position of water bearing stratum with reference to portal of tunnel .....

Log of tunnel: (Preceding table for log of well may be used, if desired. Give footage from portal and character of materials, as pertinent.)

13. Pumping Equipment:

(a) Pump Jacuzzi Turbine Capacity 30 g.p.m.  
(Make, type and size)

(b) Motor 1/2 HP. Electric 220V.  
(Type and horsepower)

14. Location of area irrigated or to be irrigated, or place of use if for purposes other than irrigation.

| Township<br>North or South | Range<br>E. or W. of<br>Willamette<br>Meridian | Section | Forty-acre Tract | Number Acres<br>To Be Irrigated | Date of<br>Reclamation |
|----------------------------|--|---------|------------------|---------------------------------|------------------------|
| T5S                        | R1W  | 6       | NE 1/4 of SE 1/4 | 2.0                             | 1950                   |
|                            |  |         |                  |                                 |                        |
|                            |  |         |                  |                                 |                        |
|                            |  |         |                  |                                 |                        |
|                            |  |         |                  |                                 |                        |
|                            |  |         |                  |                                 |                        |
|                            |  |         |                  |                                 |                        |
|                            |  |         |                  |                                 |                        |
|                            |  |         |                  |                                 |                        |
|                            |  |         |                  |                                 |                        |
|                            |  |         |                  |                                 |                        |
|                            |  |         |                  |                                 |                        |
|                            |  |         |                  |                                 |                        |
|                            |  |         |                  |                                 |                        |
|                            |  |         |                  |                                 |                        |
|                            |  |         |                  |                                 |                        |
|                            |  |         |                  |                                 |                        |
|                            |  |         |                  |                                 |                        |
|                            |  |         |                  |                                 |                        |
|                            |  |         |                  |                                 |                        |
|                            |  |         |                  |                                 |                        |
|                            |  |         |                  |                                 |                        |
|                            |  |         |                  |                                 |                        |
|                            |  |         |                  |                                 |                        |

15. If the ground water supply is supplemental to an existing water supply, identification of any application for a permit, permit, certificate or adjudicated right to appropriate water made or held by the registrant.

Township 55 Range 1W W.M.  
North

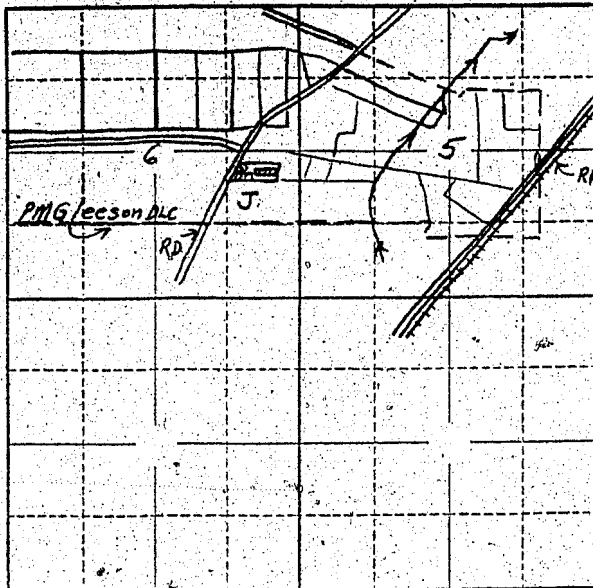

Enlarged view of property marked Stewart.

Well indicated by dot  
Irrigated land indicated by dotted lines

*Ed Geiman*

Locate well and acreage of irrigated land on plat.

Scale: 2" = 1 Mile.

STATE OF OREGON

County of Marion } ss.

I, Ed Geiman, being first duly sworn, do hereby certify that I have read the foregoing Registration Statement and that all of the items therein contained are true to the best of my knowledge and belief.

*Edward C. Geiman*  
(Signature of Registrant)

Subscribed and sworn to before me this 1st day of August, 19 58.

My commission expires 12th June 1961

*Wm. S. Baitholomew*  
(Notary Public)

(SEAL)

**CERTIFICATE OF REGISTRATION**

STATE OF OREGON

County of Marion } ss.

This is to certify that the foregoing Registration Statement was received in the office of the State Engineer on the 1st day of August, 19 58, at 3:40 o'clock P. M. and has been duly recorded in said office in Book No. 17 of Registration Statements on page GR-4046

Witness my hand this 16th day of May, 19 60

*Lewis A. Stanley*  
(State Engineer)

By \_\_\_\_\_

(Deputy)

\$15.00

GR 4046