

Registration Statement

OF CLAIMANT OF RIGHT TO APPROPRIATE GROUND WATER

TO THE STATE ENGINEER OF OREGON:

I, Carl Hunt
of 1121 Maple Drive Junction City County of Lane
(Mailing address)
State of Ore., do hereby make application for a certificate of registration as evidence
of a right to appropriate ground water.

1. Source from which water is withdrawn is #3
(Flowing well, pump well, infiltration trench, or tunnel)
2. Location is: 6 1/2 mi S.E.
(Approximate distance and direction from nearest city or town)

and is more particularly described as follows:

Ⓢ (a) 2275' S & 560' W of NW corner Sec 23
(Give distance and bearing to corner of section or other legal subdivision)
being within SE 1/4 of NW 1/4 of Sec. 23, Twp. 16, Rge. 4 1/2
(Smallest legal subdivision) (N. or S.) (E. or W.)

or (b) within limits of recorded platted property, town or city:
in Lot _____, Block _____ of _____
(Name of plat or addition)
County of _____
(If within city or town, give name)

3. Construction Work was begun on 1952; was completed on 1952
(Date) (Date)
and the ground water claimed was first used for the purposes set out below on 1957
(Date)

since which time the water has been used intermittently
(Continuously or intermittently)
from May to Sept
(Date) (Date)

4. Quantity of water claimed and used is 100 gallons per minute; 42.2 acre feet per year.

5. Purpose or Purposes for which water is used Irrigation
(Domestic, irrigation, municipal, manufacturing, industrial, etc.)

6. Description of Well: Depth 20 feet. Type Drivewell
(Dug or drilled)
diameter 2-3 inches. Elevation of ground at well site _____ feet, mean sea level.
(As near as known)
Depth to water table _____ feet.

7. Capacity of Well: _____ g.p.m. with _____ feet drawdown.
_____ g.p.m. with _____ feet drawdown.

Date of test Not Tested

If Flowing Well: Measured discharge _____ g.p.m. on _____
(Date)

Shut-in pressure at ground surface _____ lbs. per sq. in. on _____
(Date)

Water is controlled by _____
(Cap, valve, etc.)

8. **Casing:** (Give diameter, commercial specifications and depth below ground surface of each casing size.)

2-3" inch diameter *steel well casing* from 0 to 20 feet
inch diameter from to feet
inch diameter from to feet
inch diameter from to feet

Describe and show depth of shoe, plug, adapter, liner or other details:

9. **Perforated Casings or Screens:**

(Number per foot and size of perforations, describe screen)

from to
from to
from to
from to

10. **Log of Well:** (Describe each stratum or formation clearly, indicate if water bearing, and give thickness and depth as indicated.)

MATERIAL	Thickness (Feet)	Depth to Bottom (Feet)
Gravel		

If log of well is not available, give name and address of driller.....

11. Infiltration Trench: Covered or open

Dimensions: Length ft. Minimum depth ft. Maximum depth ft.
 Bottom width ft. Discharge g.p.m. Date of test

12. Tunnel: Type of lining

Dimensions:
 (Length, course, and cross sectional size)

Position of water bearing stratum with reference to portal of tunnel

Log of tunnel: (Preceding table for log of well may be used, if desired. Give footage from portal and character of materials, as pertinent.)

13. Pumping Equipment:

(a) Pump Centrifugal 2" Capacity ~~20~~ ¹⁰⁰ ~~3~~ g.p.m.
 (Make, type and size)
 (b) Motor Cluh. 5 HP 5 Cluh.
 (Type and horsepower)

14. Location of area irrigated or to be irrigated, or place of use if for purposes other than irrigation.

Township North or South	Range E. or W. of Willamette Meridian	Section	Forty-acre Tract	Number Acres To Be Irrigated	Date of Reclamation
16 S	4 W	23	SE $\frac{1}{4}$ of NW $\frac{1}{4}$	12.36	1952
16 S	4 W	23	NE $\frac{1}{4}$ of SW $\frac{1}{4}$	4.5	"
				16.86 ac	"

15. If the ground water supply is supplemental to an existing water supply, identification of any application for a permit, permit, certificate or adjudicated right to appropriate water made or held by the registrant.

Township 16 S Range 4 W, W.M.
North

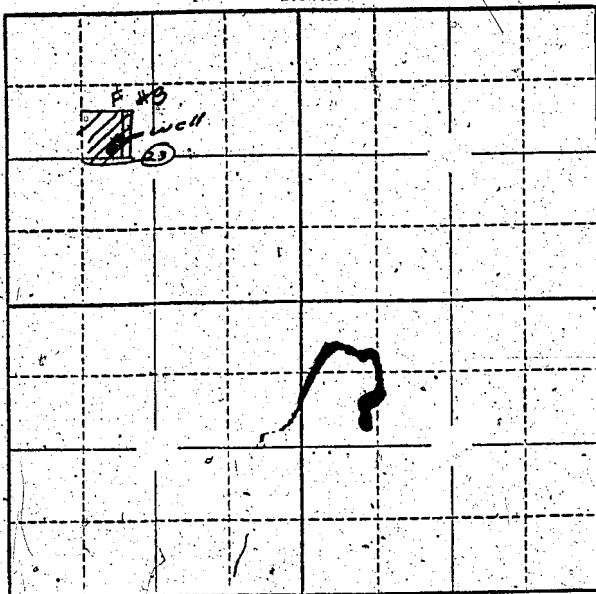

Locate well and acreage of irrigated land on plat.
Scale: 2" = 1 Mile

STATE OF OREGON

County of Jane } ss.

I, Carl Kirk, being first duly sworn, do hereby certify that I have read the foregoing Registration Statement and that all of the items therein contained are true to the best of my knowledge and belief.

Carl Kirk
(Signature of Registrant)

Subscribed and sworn to before me this 31st day of July, 1958

My commission expires April 16, 1960 Helma Stueckert
(Notary Public)

(SEAL)

CERTIFICATE OF REGISTRATION

STATE OF OREGON

County of Marion } ss.

This is to certify that the foregoing Registration Statement was received in the office of the State Engineer on the 1st day of August, 1958, at 2.00 o'clock A. M. and has been duly recorded in said office in Book No. 14 of Registration Statements on page GR 3417

Witness my hand this 20th day of August, 1959

Leura A. Stanley
(State Engineer)

By _____
(Deputy)

\$15.00

GR 3417