

19.65

REGISTRATION NO. GR-3765
CERTIFICATE NO. GR-3426

Registration Statement

OF CLAIMANT OF RIGHT TO APPROPRIATE GROUND WATER

(Under Chapter 708, Oregon Laws 1955.)

TO THE STATE ENGINEER OF OREGON:

I, S. P. HUGHES

of 440 LONE PINE DR. JUNCTION CITY County of LANE

State of ORE., do hereby make application for a certificate of registration as evidence of a right to appropriate ground water.

1. Source from which water is withdrawn is PUMP WELL #2
(Flowing well, pump well, infiltration trench, or tunnel)

2. Location is: 6 MILES SO. OF JUNCTION CITY
(Approximate distance and direction from nearest city or town)

and is more particularly described as follows:

(a) 3570' S. 46° 35' W OF THE CENTER OF SEC. 23
(Give distance and bearing to corner of section or other legal subdivision)

being within SW 1/4 SW 1/4 of Sec. 23, Twp. 16 S, Rge. 4 W
(Smallest legal subdivision) (N. or S.) (E. or W.)

or (b) within limits of recorded platted property, town or city:

in Lot _____, Block _____ of _____
(Name of plat or addition)

County of _____
(If within city or town, give name)

3. Construction Work was begun on JUNE 1938; was completed on JUNE 1938
(Date) (Date)

and the ground water claimed was first used for the purposes set out below on JULY 1938
(Date)

since which time the water has been used CONT.
(Continuously or intermittently)

from JULY 1938 to PRESENT
(Date) (Date)

4. Quantity of water claimed and used is 342 gallons per minute; 152.5 acre feet per year.

5. Purpose or Purposes for which water is used IRRIGATION

(Domestic, Irrigation, municipal, manufacturing, industrial, etc.)

6. Description of Well: Depth 26 feet. Type DRIVEN
(Dug or drilled)

diameter 4 inches. Elevation of ground at well site 325 feet, mean sea level.
(As near as known)

Depth to water table 16 feet.

7. Capacity of Well: _____ g.p.m. with _____ feet drawdown.

_____ g.p.m. with _____ feet drawdown.

Date of test _____

If Flowing Well: Measured discharge _____ g.p.m. on _____
(Date)

Shut-in pressure at ground surface _____ lbs. per sq. in. on _____
(Date)

Water is controlled by _____
(Cap. valve, etc.)

Township 16.5 Range 4W, W.M.
North

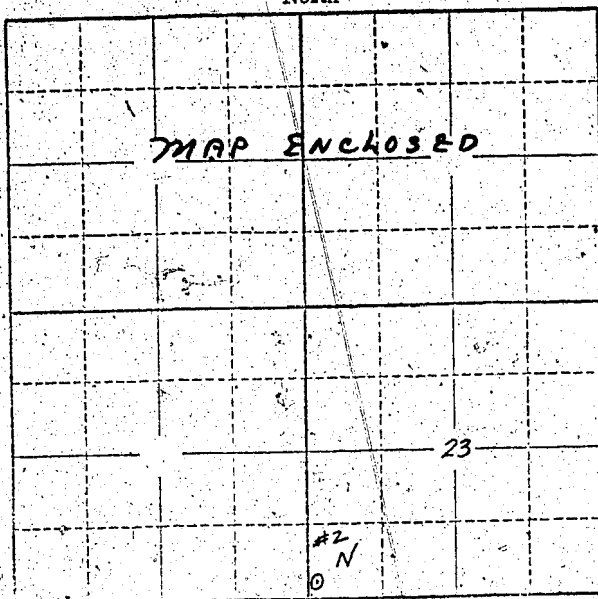

Locate well and acreage of irrigated land on plat.
Scale: 2" = 1 Mile

STATE OF OREGON

County of Clatsop } ss.

I, S. P. Hughes, being first duly sworn, do hereby certify that I have read the foregoing Registration Statement and that all of the items therein contained are true to the best of my knowledge and belief.

S. P. Hughes
(Signature of Registrant)

Subscribed and sworn to before me this 30 day of July, 1958

My commission expires 9-29-60

D. B. Young
(Notary Public)

(SEAL)

CERTIFICATE OF REGISTRATION

STATE OF OREGON

County of Marion } ss.

This is to certify that the foregoing Registration Statement was received in the office of the State Engineer on the 1st day of August, 1958, at 2.00 o'clock A.M. and has been duly recorded in said office in Book No. 14 of Registration Statements on page GR 3426

~~Construction shall be completed by 1959 and the water completely applied for beneficial use by 1960~~

Witness my hand this 20th day of August, 1959

Stuart A. Stanley
(State Engineer)

#19.65

By _____ (Deputy)
GR-3426