

# Registration Statement

## OF CLAIMANT OF RIGHT TO APPROPRIATE GROUND WATER

TO THE STATE ENGINEER OF OREGON:

I, Kenneth L. Cowgill

of Rt 3 Box 880, ALBANY County of Linn  
(Mailing address)

State of Oregon, do hereby make application for a certificate of registration as evidence of a right to appropriate ground water.

1. Source from which water is withdrawn is Pump well  
(Flowing well, pump well, infiltrated trench, or tunnel)

2. Location is: 3/4 S.W. of Albany Ore.  
(Approximate distance and direction from nearest city or town)

and is more particularly described as follows:

(a) 264' N. AND 122' E. OF S.W. CORNER S. 24, T. 11 S. R. 4 W.  
(Give distance and bearing to corner of section or other legal subdivision)

being within S.W. 1/4 of S.W. 1/4 of Sec. 16, Twp. 11 S., Rge. 4 W.  
(Smallest legal subdivision) (N. or S.) (E. or W.)

or (b) within limits of recorded platted property, town or city:

in Lot \_\_\_\_\_, Block \_\_\_\_\_ of \_\_\_\_\_  
(Name of plat or addition)

County of Linn  
(If within city or town, give name)

3. Construction Work was begun on 1953; was completed on 1953  
(Date) (Date)

and the ground water claimed was first used for the purposes set out below on April 1953  
(Date)

since which time the water has been used intermittently CONTINUOUSLY  
(Continuously or Intermittently)

from April 1953 to Sept or Oct PRESENT TIME  
(Date) (Date)

4. Quantity of water claimed and used is 150 gallons per minute; 60.0 acre feet per year.

5. Purpose or Purposes for which water is used irrigation

(Domestic, irrigation, municipal, manufacturing, industrial, etc.)

6. Description of Well: Depth 42 feet. Type drilled  
(Dug or drilled)

diameter 10 inches. Elevation of ground at well site 20.4 feet, mean sea level.  
(As near as known)

Depth to water table 20 feet.

7. Capacity of Well: 150 g.p.m. with \_\_\_\_\_ feet drawdown.

\_\_\_\_\_ g.p.m. with \_\_\_\_\_ feet drawdown.

Date of test NOT TESTED

If Flowing Well: Measured discharge \_\_\_\_\_ g.p.m. on \_\_\_\_\_  
(Date)

Shut-in pressure at ground surface \_\_\_\_\_ lbs. per sq. in. on \_\_\_\_\_  
(Date)

Water is controlled by \_\_\_\_\_  
(Cap, valve, etc.)





Township 11 S. Range 4 W. W.M.  
North

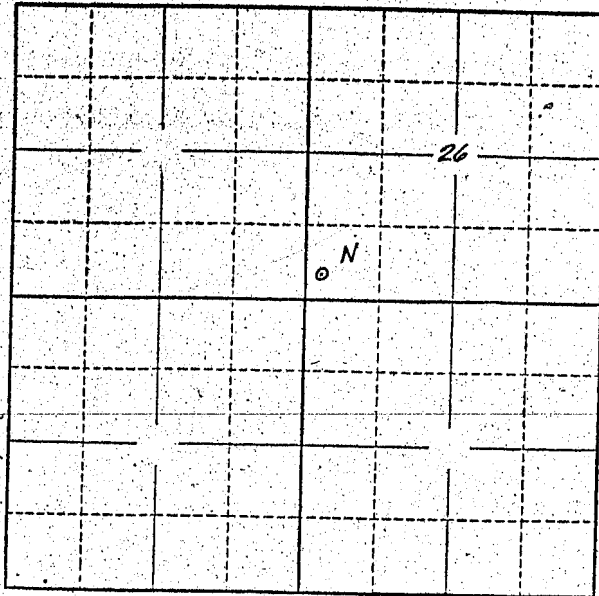

Locate well and acreage of irrigated land on plat.

Scale: 2" = 1 Mile

STATE OF OREGON

County of \_\_\_\_\_ } ss.

I, \_\_\_\_\_, being first duly sworn, do hereby certify that I have read the foregoing Registration Statement and that all of the items therein contained are true to the best of my knowledge and belief.

Herbert F. Coe  
(Signature of Registrant)

Subscribed and sworn to before me this 30<sup>th</sup> day of July, 1958

My commission expires \_\_\_\_\_  
NOTARY PUBLIC FOR OREGON  
My Commission Expires 20 March 1961

W. Walter Stuart  
(Notary Public)

(SEAL)

**CERTIFICATE OF REGISTRATION**

STATE OF OREGON }  
County of Marion } ss.

This is to certify that the foregoing Registration Statement was received in the office of the State Engineer on the 1 day of August, 1958, at 8:00 o'clock A.M. and has been duly recorded in said office in Book No. 14 of Registration Statements on page GR 3449

Witness my hand this 15<sup>th</sup> day of September, 1959

Lewis A. Stanley  
(State Engineer)

By \_\_\_\_\_  
(Deputy)

\$15.00