

# Registration Statement

## OF CLAIMANT OF RIGHT TO APPROPRIATE GROUND WATER

TO THE STATE ENGINEER OF OREGON:

I, Ben M. Johnson

of Rt. 1 Box 125 Milton - Fremont County of Umatilla

(Mailing address)

State of Oregon, do hereby make application for a certificate of registration as evidence of a right to appropriate ground water.

1. Source from which water is withdrawn is Pump Well  
(Flowing well, pump well, infiltration trench, or tunnel)

2. Location is: 3 miles N.E. Milton - Fremont  
(Approximate distance and direction from nearest city or town)

and is more particularly described as follows:

(a) 507 feet North & 999 feet East of center of Sec 25  
(Give distance and bearing to corner of section or other legal subdivision)

being within SE<sup>4</sup> of SW<sup>4</sup> of NE<sup>4</sup> of Sec. 25, Twp. 6N Rge. 35E  
(Smallest legal subdivision) (N. or S.) (E. or W.)

or (b) within limits of recorded platted property, town or city:

in Lot \_\_\_\_\_ Block \_\_\_\_\_ of \_\_\_\_\_  
(Name of plat or addition)

County of \_\_\_\_\_  
(If within city or town, give name)

3. Construction Work was begun on 1915; was completed on 1915  
(Date) (Date)

and the ground water claimed was first used for the purposes set out below on 1915  
(Date)

since which time the water has been used Continuously  
(Continuously or Intermittently)

from 1915 to 1958  
(Date) (Date)

4. Quantity of water claimed and used is: 250 gallons per minute; 60 acre feet per year.

5. Purpose or Purposes for which water is used Irrigation

(Domestic, irrigation, municipal, manufacturing, industrial, etc.)

6. Description of Well: Depth 78 feet. Type Drilled  
(Dug or drilled)

diameter 5 3/4 inches. Elevation of ground at well site 850 feet, mean sea level.  
(As near as known)

Depth to water table 16 feet.

7. Capacity of Well: 250 g.p.m. with 6 feet drawdown.

\_\_\_\_\_ g.p.m. with \_\_\_\_\_ feet drawdown.

Date of test \_\_\_\_\_

If Flowing Well: Measured discharge \_\_\_\_\_ g.p.m. on \_\_\_\_\_  
(Date)

Shut-in pressure at ground surface \_\_\_\_\_ lbs. per sq. in. on \_\_\_\_\_  
(Date)

Water is controlled by \_\_\_\_\_  
(Cap, valve, etc.)

8. Casing: (Give diameter, commercial specifications and depth below ground surface of each casing size.)

6 3/4 inch diameter ..... *Steel* ..... from *0* to *36* feet  
 ..... inch diameter ..... from ..... to ..... feet  
 ..... inch diameter ..... from ..... to ..... feet  
 ..... inch diameter ..... from ..... to ..... feet

Describe and show depth of shoe, plug, adapter, liner or other details: .....

9. Perforated Casings or Screens:

*Unknown* ..... from ..... to .....  
 (Number per foot and size of perforations, or describe screen)  
 ..... from ..... to .....  
 ..... from ..... to .....  
 ..... from ..... to .....

10. Log of Well: (Describe each stratum or formation clearly, indicate if water bearing, and give thickness and depth as indicated.)

MATERIAL	Thickness (Feet)	Depth to Bottom (Feet)
<i>top soil</i>	<i>7</i>	<i>7</i>
<i>cement gravel</i>	<i>71</i>	<i>78</i>

If log of well is not available, give name and address of driller. Orville Hogg Address Unknown

11. Infiltration Trench: Covered or open .....

Dimensions: Length ..... ft. Minimum depth ..... ft. Maximum depth ..... ft.

Bottom width ..... ft. Discharge ..... g.p.m. Date of test .....

12. Tunnel: Type of lining .....

Dimensions: .....  
(Length, course, and cross sectional size)

Position of water bearing stratum with reference to portal of tunnel .....

Log of tunnel: (Preceding table for log of well may be used, if desired. Give footage from portal and character of materials, as pertinent.)

13. Pumping Equipment:

(a) Pump 3 1/2" centrifugal File 64475 Capacity 250 g.p.m.  
(Make, type and size) M. O. R. C.

(b) Motor 7 1/2 HP Elec.  
(Type and horsepower)

14. Location of area irrigated or to be irrigated, or place of use if for purposes other than irrigation.

Township North or South	Range E. or W. of Willamette Meridian	Section	Forty-acre Tract	Number Acres To Be Irrigated	Date of Reclamation
<u>6N</u>	<u>35E</u>	<u>25</u>	<u>SW<sup>4</sup> of NE<sup>4</sup></u>	<u>28<sup>0</sup>/<sub>4</sub></u>	<u>1915</u>
<u>6N</u>	<u>35E</u>	<u>25</u>	<u>NW<sup>4</sup> of SE<sup>4</sup></u>	<u>10<sup>0</sup>/<sub>4</sub></u>	<u>1915</u>
				<u>38<sup>0</sup>/<sub>4</sub></u>	

15. If the ground water supply is supplemental to an existing water supply, identification of any application for a permit, permit, certificate or adjudicated right to appropriate water made or held by the registrant.

None

Township 6N Range 3E W.M.  
North

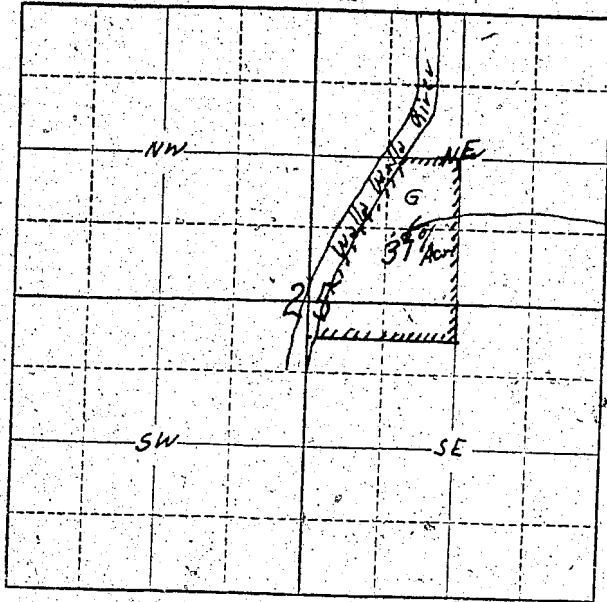

Well location is  
507 feet North + 999  
feet East of cent  
of Sec 25

Locate well and acreage of irrigated land on plat.

Scale:  $\frac{1}{4}$ " = 1 Mile  
4"

STATE OF OREGON

County of \_\_\_\_\_ } ss.

I, \_\_\_\_\_, being first duly sworn, do hereby certify that I have read the foregoing Registration Statement and that all of the items therein contained are true to the best of my knowledge and belief.

Subscribed and sworn to before me this \_\_\_\_\_ day of \_\_\_\_\_, 19\_\_\_\_.

My commission expires \_\_\_\_\_  
(Notary Public) \_\_\_\_\_

(SEAL)

### CERTIFICATE OF REGISTRATION

STATE OF OREGON } ss.  
County of Marion

This is to certify that the foregoing Registration Statement was received in the office of the State Engineer on the \_\_\_\_\_ day of \_\_\_\_\_, 19\_\_\_\_, at \_\_\_\_\_ o'clock \_\_\_\_\_ M. and has been duly recorded in said office in Book No. 16 of Registration Statements on page GR-3802

Witness my hand this \_\_\_\_\_ day of \_\_\_\_\_, 1950

16.20

By \_\_\_\_\_ (Deputy)  
\_\_\_\_\_  
(State Engineer)

GR. 3802