

Registration Statement

OF CLAIMANT OF RIGHT TO APPROPRIATE GROUND WATER

TO THE STATE ENGINEER OF OREGON:

I, Carm Weiss

of Milton-Freewater, R# 3 Box County of Umatilla

State of Oregon, do hereby make application for a certificate of registration as evidence of a right to appropriate ground water.

1. Source from which water is withdrawn is Pump well #2
(Flowing well, pump well, infiltration trench, or tunnel)

2. Location is: 2.4 miles from Milton-Freewater, Oregon North
(Approximate distance and direction from nearest city or town)

and is more particularly described as follows:

(a) 51 ft. N. from apt. 54 ft. W. from SE Cor. NE 1/4 SE 1/4 Sec. 26 TP. 6 N. R. 35 E
(Give distance and bearing to corner of section or other legal subdivision)

being within NE 1/4 of SE 1/4 of Sec. 26, Twp. 6 N., Rge. 35 E.
(Smallest legal subdivision) (N. or S.) (E. or W.)

or (b) within limits of recorded platted property, town or city:

in Lot _____, Block _____ of _____
(Name of plat or addition)

County of Umatilla

(If within city or town, give name)

3. Construction Work was begun on Feb. 1920; was completed on June 1 1920
(Date) (Date)

and the ground water claimed was first used for the purposes set out below on July 1st 1920
(Date)

since which time the water has been used continuously
(Continuously or intermittently)

from July 1 1920 to July 30 1958
(Date) (Date)

4. Quantity of water claimed and used is 500 gallons per minute; 270 acre feet per year.

5. Purpose or Purposes for which water is used Irrigation

(Domestic, irrigation, municipal, manufacturing, industrial, etc.)

6. Description of Well: Depth 65 feet. Type Dug 45' drilled 20 ft.
(Dug or drilled)

diameter _____ inches. Elevation of ground at well site 875 feet, mean sea level.
(As near as known)

Depth to water table 16 feet. in June

7. Capacity of Well: 500 g.p.m. with _____ feet drawdown.

_____ g.p.m. with _____ feet drawdown.

Date of test not made

If Flowing Well: Measured discharge _____ g.p.m. on _____
(Date)

Shut-in pressure at ground surface _____ lbs. per sq. in. on _____
(Date)

Water is controlled by _____
(Cap, valve, etc.)

8. Casing: (Give diameter, commercial specifications and depth below ground surface of each casing size.)

8 inch diameter 45' from 45' to 55 feet
inch diameter from to feet
inch diameter from to feet
inch diameter from to feet

Describe and show depth of shoe, plug, adapter, liner or other details:

9. Perforated Casings or Screens:

(Number per foot and size of perforations, or describe screen) from to
from to
from to
from to

10. Log of Well: (Describe each stratum or formation clearly, indicate if water bearing, and give thickness and depth as indicated.)

not known

MATERIAL	Thickness (Feet)	Depth to Bottom (Feet)
2 ft. to 1/2 soil, rest rocky to bottom of well		65'

If log of well is not available, give name and address of driller: not known

11. Infiltration Trench: Covered or open _____
Dimensions: Length _____ ft. Minimum depth _____ ft. Maximum depth _____ ft.

Bottom width _____ ft. Discharge _____ g.p.m. Date of test _____

12. Trench: Type of lining _____

Dimensions: _____
(Length, course, and cross sectional size)

Position of water bearing stratum with reference to portal of tunnel _____

Log of tunnel: (Preceding table for log of well may be used, if desired. Give footage from portal and character of materials, as pertinent.)

13. Pumping Equipment:

(a) Pump Pacific, 4" intake, 3" outlet Capacity 500 g.p.m.
Centrifugal
(Make, type and size)

(b) Motor Westing House 7 1/2 H.P., 3 phase
(Type and horsepower)

14. Location of area irrigated or to be irrigated, or place of use if for purposes other than irrigation.

Township North or South	Range Co E. or W. of Williamsburg Meridian	Section	Forty-acre Tract	Number Acres To Be Irrigated	Date of Reclamation
<u>6N</u>	<u>35 E</u>	<u>26</u>	<u>NE 1/4 of SE 1/4</u>	<u>20 ac used in with Well 1</u>	<u>July 1 1920</u>

15. If the ground water supply is supplemental to an existing water supply, identification of any application for a permit, permit, certificate or adjudicated right to appropriate water made or held by the registrant.

Permit # 2135, Cert. #1979, 14 ac, from E. BR. of E. Crockett (L.W.W. river)

Township 6N Range 35E, W.M.

North

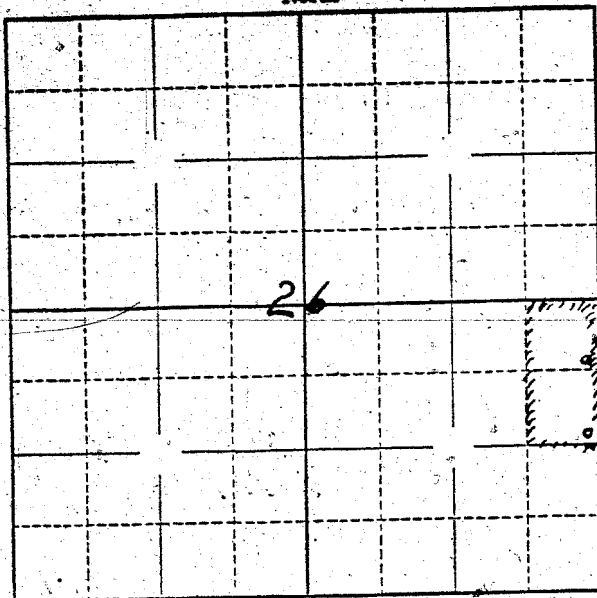

Locate well and acreage of irrigated land on plat.

Scale: $2'' = 1 \text{ Mile}$
 $4'' = 1 \text{ M}$

STATE OF OREGON

County of Wasco

ss.

I, Jason J. Willis, being first duly sworn, do hereby certify that I have read the foregoing Registration Statement and that all of the items therein contained are true to the best of my knowledge and belief.

Jason J. Willis
(Signature of Registrant)

Subscribed and sworn to before me this 30th day of July, 1958

My commission expires March 23, 1962

R. W. Wanku
(Notary Public)

(SEAL)

CERTIFICATE OF REGISTRATION

STATE OF OREGON

County of Marion

ss.

This is to certify that the foregoing Registration Statement was received in the office of the State Engineer on the 1 day of August, 1958, at 8:00 o'clock A. M. and has been duly recorded in said office in Book No. 14 of Registration Statements on page GR-3499

Witness my hand this 15th day of September, 1959

Laura A. Stanley
(State Engineer)

\$15.00

By _____
(Deputy)

GR 3499