

*Henry A. Stanley*

Registration No. GR - *3842*

Certificate No. GR - *3500*

### Registration Statement

#### OF CLAIMANT OF RIGHT TO APPROPRIATE GROUND WATER

TO THE STATE ENGINEER OF OREGON: *William*

1. *Carroll Wells*

of Milton-Freewater, R.#3 Box  
(Mailing address)

County of Umatilla

State of \_\_\_\_\_, do hereby make application for a certificate of registration as evidence of a right to appropriate ground water.

1. Source from which water is withdrawn is Pump well #1  
(Flowing well, pump well, infiltration trench, or tunnel)

2. Location is: 2 1/4 miles from Milton-Freewater, Oregon, North  
(Approximate distance and direction from nearest city or town)

and is more particularly described as follows:

(a) 585 ft. E. 12 ft. N. from SW cor. of NE 1/4 of SE 1/4 Sec. 26 Twp. 6 N. R. 35 E.  
(Give distance and bearing to corner of section or other legal subdivision)

being within NE 1/4 of SE 1/4 of Sec. 26, Twp. 6 N., Rge. 35 E.  
(Smallest legal subdivision) (N. or S.) (E. or W.)

or (b) within limits of recorded platted property, town or city: \_\_\_\_\_

in Lot \_\_\_\_\_, Block \_\_\_\_\_ of \_\_\_\_\_  
(Name of plat or addition)

County of \_\_\_\_\_  
(If within city or town, give name)

3. Construction Work was begun on Feb. 1 1919; was completed on June 1 1919  
(Date) (Date)

and the ground water claimed was first used for the purposes set out below on July 1 1919  
(Date)

since which time the water has been used continuously  
(Continuously or intermittently)

from July 1 1919 to July 30 1958  
(Date) (Date)

4. Quantity of water claimed and used is 700 gallons per minute; 372 acre feet per year.

5. Purpose or Purposes for which water is used Irrigation

(Domestic, irrigation, municipal, manufacturing, industrial, etc.)

6. Description of Well: Depth Dug 90 ft. feet. Type Dug 35 ft. drilled 55'  
(Dug or drilled)

diameter 6 inches. Elevation of ground at well site 870 feet, mean sea level.  
(As near as known)

Depth to water table 10 feet. in June

7. Capacity of Well: 700 g.p.m. with \_\_\_\_\_ feet drawdown.

\_\_\_\_\_ g.p.m. with \_\_\_\_\_ feet drawdown.

Date of test Not known if well was tested

If Flowing Well: Measured discharge \_\_\_\_\_ g.p.m. on \_\_\_\_\_  
(Date)

Shut-in pressure at ground surface \_\_\_\_\_ lbs. per sq. in. on \_\_\_\_\_  
(Date)

Water is controlled by \_\_\_\_\_  
(Cap, valve, etc.)





Township 6N Range 35E, W.M.  
North

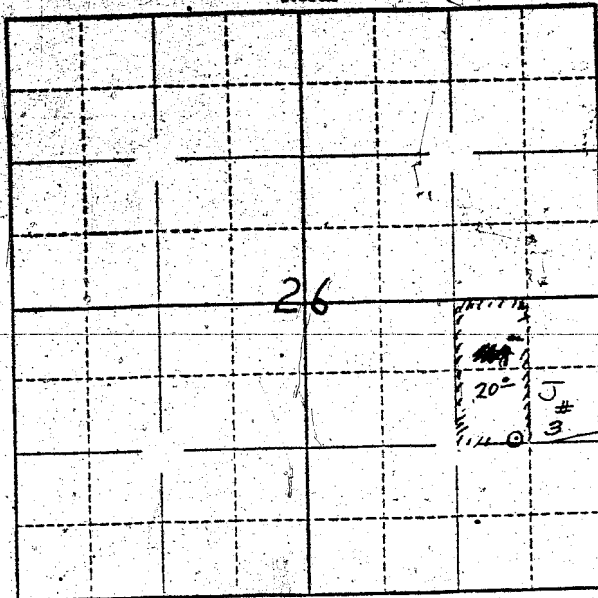

Locate, well and acreage of irrigated land on plat.

Scale: ~~2"~~ = 1 Mile  
1" = 1 Mile

STATE OF OREGON

County of Wasatch } ss.

I, Carson Weis, being first duly sworn, do hereby certify that I have read the foregoing Registration Statement and that all of the items therein contained are true to the best of my knowledge and belief.

Carson J. Weis  
(Signature of Registrant)

Subscribed and sworn to before me this 30<sup>th</sup> day of July, 1955.

My commission expires March 23, 1962

R. E. Wankle  
(Notary Public)

(SEAL)

**CERTIFICATE OF REGISTRATION**

STATE OF OREGON

County of Marion } ss.

This is to certify that the foregoing Registration Statement was received in the office of the State Engineer on the 1st day of August, 1955, at 8:00 o'clock A. M. and has been duly recorded in said office in Book No. 14 of Registration Statements on page 68 3500.

Witness my hand this 15<sup>th</sup> day of September, 1959.

Lewis A. Stanley  
(State Engineer)

By \_\_\_\_\_ (Deputy)

\$15.00