

Registration Statement

OF CLAIMANT OF RIGHT TO APPROPRIATE GROUND WATER

TO THE STATE ENGINEER OF OREGON:

I, T. H. Halady
 of Milton Freewater Rt 3 County of Umatilla
(Mailing address)
 State of Oregon do hereby make application for a certificate of registration as evidence of a right to appropriate ground water.

1. Source from which water is withdrawn is pump well
(Flowing well, pump well, infiltration trench, or tunnel)

2. Location is: 3 miles North of Milton Freewater
(Approximate distance and direction from nearest city or town)

and is more particularly described as follows: a pt 710' N. from a pt. 430' E. from SW cor. of SE 4 of NW 1/4 of Sec. 25

(a) 3/4 of NW 1/4 of Sec. 25
(Give distance and bearing to corner of section or other legal subdivision)

being within SW 1/4 of the SE 4 of NW 1/4 of Sec. 25, Twp. 6 N, Rge. 35 E
(Smallest legal subdivision) (N. or S.) (E. or W.)

or (b) within limits of recorded platted property, town or city: _____

in Lot _____, Block _____ of _____
(Name of plat or addition)

County of _____
(If within city or town, give name)

3. Construction Work was begun on April 1 1917, was completed on April 30 1917
(Date) (Date)

and the ground water claimed was first used for the purposes set out below on April 30 1917
(Date)

since which time the water has been used intermittently
(Continuously or intermittently)

from 1917 to 1957
(Date) (Date)

4. Quantity of water claimed and used is 400 gallons per minute; 216 acre feet per year.

5. Purpose or Purposes for which water is used irrigation
(Domestic, irrigation, municipal, manufacturing, industrial, etc.)

6. Description of Well: Depth 68 feet. Type Dug 22-dia 4 1/2'
(Dug or drilled)

diameter 8 inches. Elevation of ground at well site 860 feet, mean sea level.
(As near as known)

Depth to water table _____ feet. Varies from 10' to 20' - June 10'

7. Capacity of Well: 500 g.p.m. with _____ feet drawdown. lowers 3ft.
 _____ g.p.m. with _____ feet drawdown.

Date of test None made

If Flowing Well: Measured discharge _____ g.p.m. on _____
(Date)

Shut-in pressure at ground surface _____ lbs. per sq. in. on _____
(Date)

Water is controlled by _____
(Cap, valve, etc.)

8. Casing: (Give diameter, commercial specifications and depth below ground surface of each casing size.)

8 inch diameter *Depth unknown* from to feet
 inch diameter from to feet
 inch diameter from to feet
 inch diameter from to feet

Describe and show depth of shoe, plug, adapter, liner or other details:

9. Perforated Casings or Screens:

not known from to
(Number per foot and size of perforations, or describe screen)
 from to
 from to
 from to

10. Log of Well: (Describe each stratum or formation clearly, indicate if water bearing, and give thickness and depth as indicated.)

Drillers deceased

MATERIAL	Thickness (Feet)	Depth to Bottom (Feet)
Top soil, 6 to 8 ft - gravel to bottom of well		68

If log of well is not available, give name and address of driller.

11. Infiltration Trench: Covered or open

Dimensions: Length ft. Minimum depth ft. Maximum depth ft.

Bottom width ft. Discharge g.p.m. Date of test

12. Tunnel: Type of lining

Dimensions:
(Length, course, and cross sectional size)

Position of water bearing stratum with reference to portal of tunnel

Log of tunnel: (Preceding table for log of well may be used, if desired. Give footage from portal and character of materials, as pertinent.)

13. Pumping Equipment:

(a) Pump Pacific Pump 3" Capacity 400 g.p.m.
(Make, type and size)

(b) Motor Westinghouse 3 H.P.
(Type and horsepower)

14. Location of area irrigated or to be irrigated, or place of use if for purposes other than irrigation.

Township North or South	Range E. or W. of Williamsite Meridian	Section	Forty-acre Tract	Number Acres To Be Irrigated	Date of Reclamation
6N	35E	25	SE 1/4 NW 1/4	10 acres	April-30-1917

15. If the ground water supply is supplemental to an existing water supply, identification of any application for a permit, permit, certificate or adjudicated right to appropriate water made or held by the registrant.

Township 6N Range 35 W.M.
North

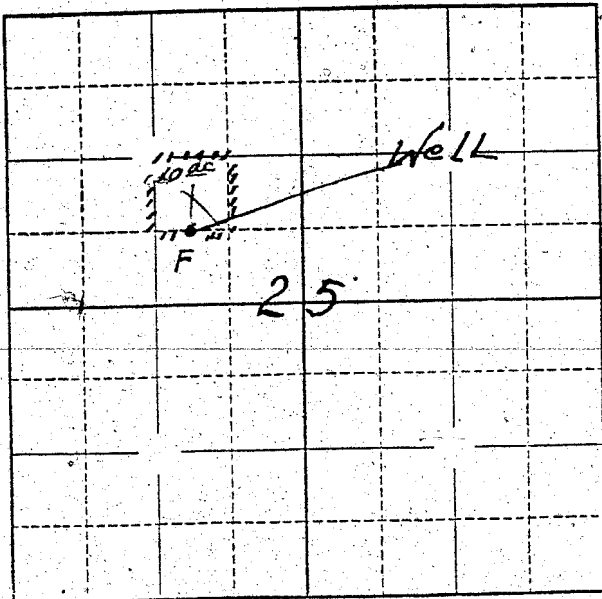

Locate well and acreage of irrigated land on plat.

Scale: ~~2"~~ 1 Mile

4" = 1 M.

STATE OF OREGON

County of Umatilla

ss.

I, T. H. Holiday, being first duly sworn, do hereby certify that I have read the foregoing Registration Statement and that all of the items therein contained are true to the best of my knowledge and belief.

T. H. Holiday

(Signature of Registrant)

Subscribed and sworn to before me this 30th day of July, 1958

My commission expires Jan. 26, 1962

G. H. Bishop

(Notary Public)

(SEAL)

CERTIFICATE OF REGISTRATION

STATE OF OREGON

County of Marion

ss.

This is to certify that the foregoing Registration Statement was received in the office of the State Engineer on the 1 day of August, 1958, at 1:00 o'clock P.M. and has been duly recorded in said office in Book No. 15 of Registration Statements on page OR 3508

Witness my hand this 15th day of September, 1959

Levia A. Stankley

(State Engineer)

By

(Deputy)

\$15.00

GR 3508