

Registration Statement

OF CLAIMANT OF RIGHT TO APPROPRIATE GROUND WATER

TO THE STATE ENGINEER OF OREGON:

I, Clarence E. Wolsizer

of Rt 2 Box 5 Milton-Freewater County of Umatilla

State of Oregon, do hereby make application for a certificate of registration as evidence of a right to appropriate ground water.

1. Source from which water is withdrawn is Pump Well
(Flowing well, pump well, infiltration trench, or tunnel)

2. Location is: 2 miles west Milton-Freewater
(Approximate distance and direction from nearest city or town)

and is more particularly described as follows:

(a) 765.8 feet north 657.7 feet East of S4 corner of Sec 34
(Give distance and bearing to corner of section or other legal subdivision)

being within NW4 of SW4 of SE4 of Sec. 34, Twp. 6N, Rge. 35E
(Smallest legal subdivision) (N. or S.) (E. or W.)

or (b) within limits of recorded platted property, town or city:

in Lot _____, Block _____ of _____
(Name of plat or addition)

County of _____
(If within city or town, give name)

3. Construction Work was begun on Prior 1912; was completed on Prior 1912
(Date) (Date)

and the ground water claimed was first used for the purposes set out below on 1912
(Date)

since which time the water has been used Continuously
(Continuously or Intermittently)

from June 1 to Sept 31
(Date) (Date)

4. Quantity of water claimed and used is 450 gallons per minute; 64 acre feet per year.

5. Purpose or Purposes for which water is used Irrigation

(Domestic, irrigation, municipal, manufacturing, industrial, etc.)

6. Description of Well: Depth 52 feet. Type Dug
(Dug or drilled)

diameter 72 inches. Elevation of ground at well site 900 feet, mean sea level.
(As near as known)

Depth to water table 36 feet.

7. Capacity of Well: _____ g.p.m. with _____ feet drawdown.

_____ g.p.m. with _____ feet drawdown.

Date of test No Test

If Flowing Well: Measured discharge _____ g.p.m. on _____
(Date)

Shut-in pressure at ground surface _____ lbs. per sq. in. on _____
(Date)

Water is controlled by _____
(Cap, valve, etc.)

8. **Casing:** (Give diameter, commercial specifications and depth below ground surface of each casing size.)

72 inch diameter Concrete from 0 to 20 feet
..... inch diameter from to feet
..... inch diameter from to feet
..... inch diameter from to feet

Describe and show depth of shoe, plug, adapter, liner or other details:

9. **Perforated Casings or Screens:**

(Number per foot and size of perforations, or describe screen) from to
..... from to
..... from to
..... from to

10. **Log of Well:** (Describe each stratum or formation clearly, indicate if water bearing, and give thickness and depth as indicated.)

No Information

MATERIAL	Thickness (Feet)	Depth to Bottom (Feet)

Township 6N Range 35E, W.M.
North

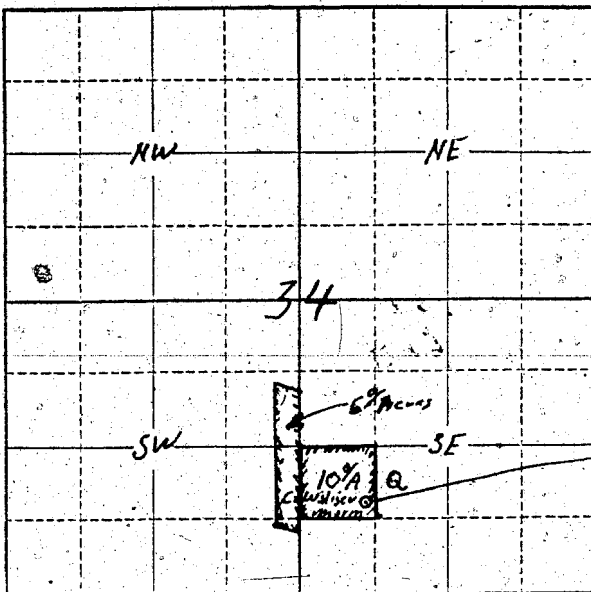

Locate well and acreage of irrigated land on plat.

Scale: $\frac{1}{4}$ " = 1 Mile

STATE OF OREGON

County of Wasilla

ss.

I, Clarence T. Holman, being first duly sworn, do hereby certify that I have read the foregoing Registration Statement and that all of the items therein contained are true to the best of my knowledge and belief.

X Clarence Holman
(Signature of Registrant)

Subscribed and sworn to before me this 15th day of September, 1959

My commission expires 12/31/62

S.D. Bishop
(Notary Public)

(SEAL)

CERTIFICATE OF REGISTRATION

STATE OF OREGON

County of Marion

ss.

This is to certify that the foregoing Registration Statement was received in the office of the State Engineer on the 15th day of September, 1959, at 1:00 o'clock P.M. and has been duly recorded in said office in Book No. 15 of Registration Statements on page GR-3510

Witness my hand this 15th day of September, 1959

W.A. Starnes
(State Engineer)

\$15.00

By _____
(Deputy)

GR 3510