

Registration Statement

OF CLAIMANT OF RIGHT TO APPROPRIATE GROUND WATER

TO THE STATE ENGINEER OF OREGON:

I, Edmond B. Forbes
 of 170 SE 6th Ave. Milton-Freewater County of Wasco
(Mailing address)
 State of Oregon, do hereby make application for a certificate of registration as evidence
 of a right to appropriate ground water.

1. Source from which water is withdrawn is Pump Well
(Flowing well, pump well, infiltration trench, or tunnel)
2. Location is: 1 NE Milton-Freewater
(Approximate distance and direction from nearest city or town)

and is more particularly described as follows:

(a) 110 feet south & 300 feet west from North 1/4 corner Section 1
(Give distance and bearing to corner of section or other legal subdivision)
 being within NE 1/4 of NW 1/4 of Sec. 1, Twp. 5N, Rge. 35E
(Smallest legal subdivision) (N. or S.) (E. or W.)

or (b) within limits of recorded platted property, town or city:
 in Lot _____, Block _____ of _____
(Name of plat or addition)
 _____ County of _____
(If within city or town, give name)

3. Construction Work was begun on Prior 1920; was completed on Prior 1920
(Date) (Date)
 and the ground water claimed was first used for the purposes set out below on Prior 1920
(Date)
 since which time the water has been used Intermittently
(Continuously or intermittently)
 from Prior 1920 to 1958
(Date) (Date)

4. Quantity of water claimed and used is 100 gallons per minute; 15 acre
 feet per year.

5. Purpose or Purposes for which water is used Irrigation - Domestic
(Domestic, irrigation, municipal, manufacturing, industrial, etc.)

6. Description of Well: Depth 40 feet. Type Dug
(Dug or drilled)
 diameter 72 inches. Elevation of ground at well site 895 feet, mean sea level.
(As near as known)
 Depth to water table 10 feet.

7. Capacity of Well: _____ g.p.m. with _____ feet drawdown.
 _____ g.p.m. with _____ feet drawdown.

Date of test No Test

If Flowing Well: Measured discharge _____ g.p.m. on _____
(Date)
 Shut-in pressure at ground surface _____ lbs. per sq. in. on _____
(Date)
 Water is controlled by _____
(Cap, valve, etc.)

If log of well is not available, give name and address of driller. *Not Known*

11. Infiltration Trench: Covered or open

Dimensions: Length ft. Minimum depth ft. Maximum depth ft.

Bottom width ft. Discharge g.p.m. Date of test

12. Tunnel: Type of lining

Dimensions:
(Length, course, and cross sectional size)

Position of water bearing stratum with reference to portal of tunnel

Log of tunnel: (Preceding table for log of well may be used, if desired. Give footage from portal and character of materials, as pertinent.)

13. Pumping Equipment:

(a) Pump *G.E. motor, Deere 3HP* (Make, type and size) Capacity *100* g.p.m.

(b) Motor *3HP Elec* (Type and horsepower)

14. Location of area irrigated or to be irrigated, or place of use if for purposes other than irrigation.

Township North or South	Range E. or W. of Willamette Meridian	Section	Forty-acre Tract	Number Acres To Be Irrigated	Date of Reclamation
<i>5N</i>	<i>35E</i>	<i>1</i>	<i>NE⁴ of NW⁴</i>	<i>3/4</i>	<i>prior 1920</i>

15. If the ground water supply is supplemental to an existing water supply, identification of any application for a permit, permit, certificate or adjudicated right to appropriate water made or held by the registrant.

IF Surface right East side Patch

Township 5N Range 35E, W.M.
North

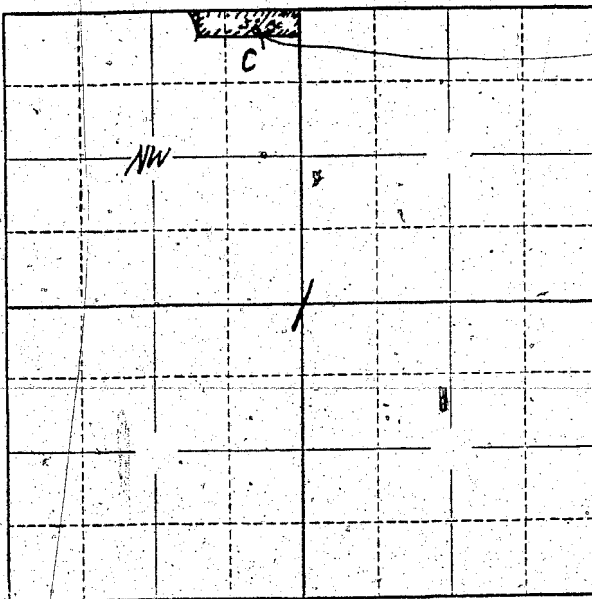

Well Location
300 feet west
& 110 feet S from
NW Corner of Sec 1

Locate well and acreage of irrigated land on plat.

Scale: $\frac{1}{4}$ " = 1 Mile

STATE OF OREGON

County of Umatilla } ss.

I, E. K. Forbes, being first duly sworn, do hereby certify that I have read the foregoing Registration Statement and that all of the items therein contained are true to the best of my knowledge and belief.

E. K. Forbes
(Signature of Registrant)

Subscribed and sworn to before me this 31st day of July, 1951

My commission expires June 6th 1960
J. R. K. Haddad
(Notary Public) for Oregon

(SEAL)

CERTIFICATE OF REGISTRATION

STATE OF OREGON

County of Marion } ss.

This is to certify that the foregoing Registration Statement was received in the office of the State Engineer on the 1st day of August, 1951, at 1:00 o'clock P.M. and has been duly recorded in said office in Book No. 15 of Registration Statements on page GR-3513

Witness my hand this 15th day of September, 1951

\$15.00

Lawrence J. Atkinson
(State Engineer)

By _____ (Deputy)

GR 3513