

Registration Statement

OF CLAIMANT OF RIGHT TO APPROPRIATE GROUND WATER

TO THE STATE ENGINEER OF OREGON:

I, Archie Harris

of Milton County of Wasco

State of Ore, do hereby make application for a certificate of registration as evidence of a right to appropriate ground water.

1. Source from which water is withdrawn is Pump well

2. Location is: 3 Mi. NW of Milton

and is more particularly described as follows:

(a) 810 ft. S + 361 ft. E of center of Sec. 33 6N 33E

being within SW 1/4 + NW 1/4 of SE 1/4 of Sec. 33, Twp. 6N, Rge. 35E

or (b) within limits of recorded platted property, town or city:

in Lot _____, Block _____ of _____

County of _____

3. Construction Work was begun on 1920; was completed on 1920

and the ground water claimed was first used for the purposes set out below on April 1920

since which time the water has been used continuously

from Apr 1-1920 to Sept 1959

4. Quantity of water claimed and used is 160 gallons per minute; 106 acre feet per year.

5. Purpose or Purposes for which water is used Irrigation

(Domestic, irrigation, municipal, manufacturing, industrial, etc.)

6. Description of Well: Depth 39 feet. Type Dug

diameter _____ inches. Elevation of ground at well site 920 feet, mean sea level.

Depth to water table 20-30 feet.

7. Capacity of Well: _____ g.p.m. with _____ feet drawdown.
_____ g.p.m. with _____ feet drawdown.

Date of test Nat. Inst.

If Flowing Well: Measured discharge _____ g.p.m. on _____

Shut-in pressure at ground surface _____ lbs. per sq. in. on _____

Water is controlled by _____

8. Casing: (Give diameter, commercial specifications and depth below ground surface of each casing size.)

..... inch diameter from to feet
 inch diameter from to feet
 inch diameter from to feet
 inch diameter from to feet

Describe and show depth of shoe, plug, adapter, liner or other details:

.....

9. Perforated Casings or Screens:

(Number per foot and size of perforations, or describe screen)

..... from to
 from to
 from to
 from to

10. Log of Well: (Describe each stratum or formation clearly, indicate if water bearing, and give thickness and depth as indicated.)

MATERIAL	Thickness (Feet)	Depth to Bottom (Feet)
Cement Gravel & Sand		

If log of well is not available, give name and address of driller

11. Infiltration Trench: Covered or open

Dimensions: Length ft. Minimum depth ft. Maximum depth ft.

Bottom width ft. Discharge g.p.m. Date of test

12. Tunnel: Type of lining

Dimensions:
(Length, course, and cross sectional size)

Position of water bearing stratum with reference to portal of tunnel

Log of tunnel: (Preceding table for log of well may be used, if desired. Give footage from portal and character of materials, as pertinent.)

13. Pumping Equipment:

(a) Pump 5 HP 2" Centrifugal Capacity 160 g.p.m.
(Make, type and size)

(b) Motor 5 HP Electric
(Type and horsepower)

14. Location of area irrigated or to be irrigated, or place of use if for purposes other than irrigation.

Township North or South	Range E. or W. of Willamette Meridian	Section	Forty-acre Tract	Number Acres To Be Irrigated	Date of Reclamation
6N	35E	33	NE 1/4 of SW 1/4	7.5	Prior to 1927
6N	35E	33	NW 1/4 of SE 1/4	5.6	
				13.1 Ac	

15. If the ground water supply is supplemental to an existing water supply, identification of any application for a permit, permit, certificate or adjudicated right to appropriate water made or held by the registrant.

Present View

Township 6 N Range 35 E W.M.
North

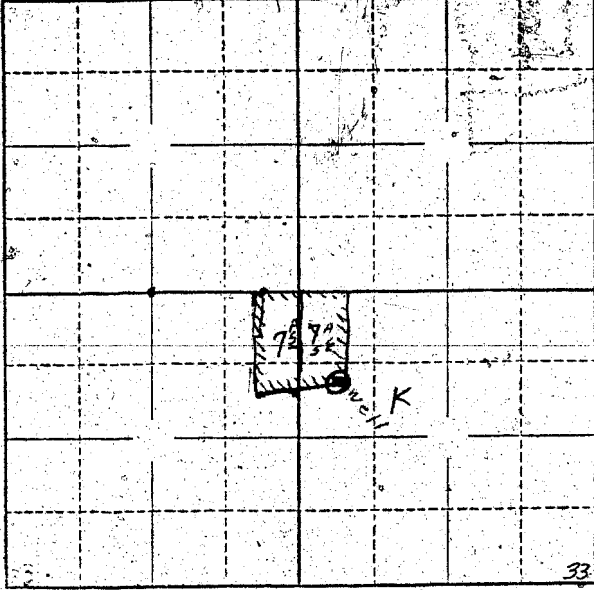

Locate well and acreage of irrigated land on plat. 33 34
Scale: 4 - 1 Mile 3

STATE OF OREGON }
County of Marion } ss.

I, Archie Harris, being first duly sworn, do hereby certify that I have read the foregoing Registration Statement and that all of the items therein contained are true to the best of my knowledge and belief.

[Signature]
(Signature of Registrant)

Subscribed and sworn to before me this 14 day of September, 1958.

My commission expires Sept 5, 1959 [Signature]
(Notary Public)

(SEAL)

CERTIFICATE OF REGISTRATION

STATE OF OREGON }
County of Marion } ss.

This is to certify that the foregoing Registration Statement was received in the office of the State Engineer on the 1 day of August, 1958, at 8:00 o'clock A. M. and has been duly recorded in said office in Book No. 15 of Registration Statements on page GR-3633

Witness my hand this 15th day of September, 19 59

[Signature]
(State Engineer)

\$15.00

By [Signature]
(Deputy)