

Registration Statement

OF CLAIMANT OF RIGHT TO APPROPRIATE GROUND WATER

TO THE STATE ENGINEER OF OREGON:

I, DOROTHY WERNER and DWAYNE WERNER

of RT. 1, Box 103, Brooks County of MARION

State of OREGON, do hereby make application for a certificate of registration as evidence of a right to appropriate ground water.

1. Source from which water is withdrawn is PUMP WELL
(Flowing well, pump well, infiltration trench, or tunnel)

2. Location is: 5 MILES WEST OF MOUNT HAZEL
(Approximate distance and direction from nearest city or town)

and is more particularly described as follows:

(a) FROM COMMON CORNER OF Sec. 7-18: SOUTH 5 CHAIN; WEST 9 CHAINS
(Give distance and bearing to corner of section or other legal subdivision)

being within NW 1/4 of NW 1/4 of Sec. 18, Twp. 6 S, Rge. 1 W
(Smallest legal subdivision) (N. or S.) (E. or W.)

or (b) within limits of recorded platted property, town or city.

in Lot _____, Block _____ of _____
(Name of plat or addition)

County of _____
(If within city or town, give name)

3. Construction Work was begun on NOT KNOWN; was completed on NOT KNOWN
(Date) (Date)

and the ground water claimed was first used for the purposes set out below on FEED E 1951
(Date)

since which time the water has been used INTERMITTENTLY
(Continuously or Intermittently)

from 1951 to PRESENT
(Date) (Date)

4. Quantity of water claimed and used is 70 (?) gallons per minute; 16 (?) acre feet per year.

5. Purpose or Purposes for which water is used IRRIGATION

(Domestic, irrigation, municipal, manufacturing, industrial, etc.)

6. Description of Well: Depth 106 feet. Type DRILLED
(Dug or drilled)

diameter 8 inches. Elevation of ground at well site 170 FT (?) feet, mean sea level.
(As near as known)

Depth to water table NOT KNOWN feet.

7. Capacity of Well: NOT KNOWN g.p.m. with _____ feet drawdown.

_____ g.p.m. with _____ feet drawdown.

Date of test _____

If Flowing Well: Measured discharge _____ g.p.m. on _____
(Date)

Shut-in pressure at ground surface _____ lbs. per sq. in. on _____
(Date)

Water is controlled by _____
(Cap, valve, etc.)

COUNTY ROAD

WELL

Township 6 S. Range 1 W. W.M. North

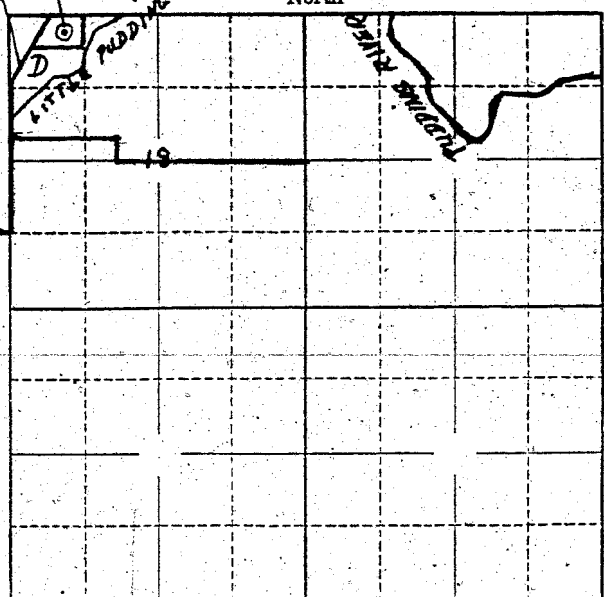

Locate well and acreage of irrigated land on plat.
Scale: 2" = 1 Mile

STATE OF OREGON

County of Marion } ss.

I, Dwayne Hermer, being first duly sworn, do hereby certify that I have read the foregoing Registration Statement and that all of the items therein contained are true to the best of my knowledge and belief.

Dwayne Hermer
(Signature of Registrant)

Subscribed and sworn to before me this 12th day of August, 1958

My commission expires June 4 1962 Arthur A. Hunt
(Notary Public)

(SEAL)

CERTIFICATE OF REGISTRATION

STATE OF OREGON

County of Marion } ss.

This is to certify that the foregoing Registration Statement was received in the office of the State Engineer on the 4th day of August, 1958, at 8.00 o'clock A. M. and has been duly recorded in said office in Book No. 15 of Registration Statements on page GR 3530

Witness my hand this 15th day of September, 1959

LEWIS A. STANLEY
(State Engineer)

By _____
(Deputy)

GR 3530