

Registration Statement

OF CLAIMANT OF RIGHT TO APPROPRIATE GROUND WATER

(Under Chapter 708, Oregon Laws 1955.)

TO THE STATE ENGINEER OF OREGON:

I, Dames Bros.

of Silverton County of Wasco

State of Oregon, do hereby make application for a certificate of registration as evidence of a right to appropriate ground water.

1. Source from which water is withdrawn is pump well
(Flowing well, pump well, infiltration trench, or tunnel)

2. Location is: 3 1/2 miles south of Silverton on Strouton Hwy.
(Approximate distance and direction from nearest city or town)

and is more particularly described as follows:

(a) 700 feet west and 920 feet north from E 1/4 corner section 16
(Give distance and bearing to corner of section or other legal subdivision)

being within SE 1/4 of NE 1/4 of Sec. 16, Twp. 7S, Rge. 1W
(Smallest legal subdivision) (N. or S.) (E. or W.)

or (b) within limits of recorded platted property, town or city:

in Lot _____, Block _____ of _____
(Name of plat or addition)

_____ County of _____
(If within city or town, give name)

3. Construction Work was begun on July 1946; was completed on Aug 1946
(Date) (Date)

and the ground water claimed was first used for the purposes set out below on Aug 1946
(Date)

since which time the water has been used Continuously
(Continuously or intermittently)

from Aug 1946 to Jan 1956
(Date) (Date)

4. Quantity of water claimed and used is 150 gallons per minute; _____ acre feet per year.

5. Purpose or Purposes for which water is used Domestic and irrigation

(Domestic, irrigation, municipal, manufacturing, industrial, etc.)

6. Description of Well: Depth 92 feet. Type Drilled
(Dug or drilled)

diameter 8 inches. Elevation of ground at well site 330 feet, mean sea level.
(As near as known)

Depth to water table 4.5 feet.

7. Capacity of Well: 150 g.p.m. with _____ feet drawdown.

_____ g.p.m. with _____ feet drawdown.

Date of test Fall 1946

If Flowing Well: Measured discharge _____ g.p.m. on _____
(Date)

Shut-in pressure at ground surface _____ lbs. per sq. in. on _____
(Date)

Water is controlled by _____
(Cap, valve, etc.)

Township 7 S Range 1 W, W.M.
North

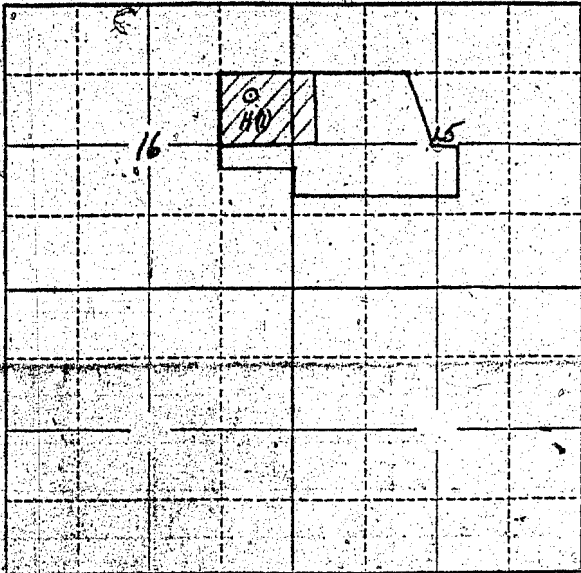

Locate well and acreage of irrigated land on plat.
Scale: 2" = 1-Mile

STATE OF OREGON

County of Marion } ss.

I, Richard L. Barnes, being first duly sworn, do hereby certify that I have read the foregoing Registration Statement and that all of the items therein contained are true to the best of my knowledge and belief.

Richard L. Barnes
(Signature of Registrant)

Subscribed and sworn to before me this 8th day of March, 1957.

My commission expires Sept 8, 1960 Chas. J. White
(Notary Public)

(SEAL)

CERTIFICATE OF REGISTRATION

STATE OF OREGON

County of Marion } ss.

This is to certify that the foregoing Registration Statement was received in the office of the State Engineer on the 8th day of March, 1957, at 11:00 o'clock A. M. and has been duly recorded in said office in Book No. 3 of Registration Statements on page GR-376 C.

~~Construction shall be completed by X-X-X-X-X-X-X-X-X-X and the water completed, X-X-X-X-X-X-X-X-X-X by X-X-X-X-X-X-X-X-X-X, 19-X-X-X~~

Witness my hand this 30th day of April, 1957
Lewis A. Stanley
(State Engineer)

By _____
(Deputy)

GR 376 C