

15⁰⁰ State Eng
Sales One

Registration No. GR-3903

Certificate No. GR-4003

Registration Statement

OF CLAIMANT OF RIGHT TO APPROPRIATE GROUND WATER

RECEIVED
MAR 1 1960
STATE ENGINEER
SALES SECTION

TO THE STATE ENGINEER OF OREGON:

I, J. C. & Ruth A. Lewis

of Rte #2, Box 440, Troutdale County of Multnomah

State of Oregon, do hereby make application for a certificate of registration as evidence of a right to appropriate ground water.

1. Source from which water is withdrawn is Pump well
(Flowing well, pump well, infiltration trench, or tunnel)

2. Location is: 3 miles West Troutdale
(Approximate distance and direction from nearest city or town)

and is more particularly described as follows:

(a) N. 23° 45' W SE cor Sec 29, 550'
(Give distance and bearing to corner of section or other legal subdivision)

being within SE 1/4 SE 1/4 of Sec. 29, Twp. 1N, Rge. 3E
(Smallest legal subdivision) (N. or S.) (E. or W.)

or (b) within limits of recorded platted property, town or city:

in Lot _____, Block _____ of _____
(Name of plat or addition)

County of _____
(If within city or town, give name)

3. Construction Work was begun on Jan. 1930; was completed on Jan. 1930
(Date) (Date)

and the ground water claimed was first used for the purposes set-out below on Jan. 1930
(Date)

since which time the water has been used intermittently continuously
(Continuously or intermittently)
from 1930 to 1957
(Date) (Date)

4. Quantity of water claimed and used is 10 gallons per minute; _____ acre feet per year.

5. Purpose or Purposes for which water is used irrigation stock Rabbit farm
(Domestic, irrigation, municipal, manufacturing, industrial, etc.)

6. Description of Well: Depth 48 feet. Type Drilled
(Dug or drilled)
diameter unknown inches. Elevation of ground at well site _____ feet, mean sea level.
Depth to water table unknown feet.
(As near as known)

7. Capacity of Well: _____ g.p.m. with _____ feet drawdown;
_____ g.p.m. with _____ feet drawdown.

Date of test No test

If Flowing Well: Measured discharge _____ g.p.m. on _____
(Date)

Shut-in pressure at ground surface _____ lbs. per sq. in. on _____
(Date)

Water is controlled by _____
(Cap. valve, etc.)

Township 1N Range 3E, W.M.
North

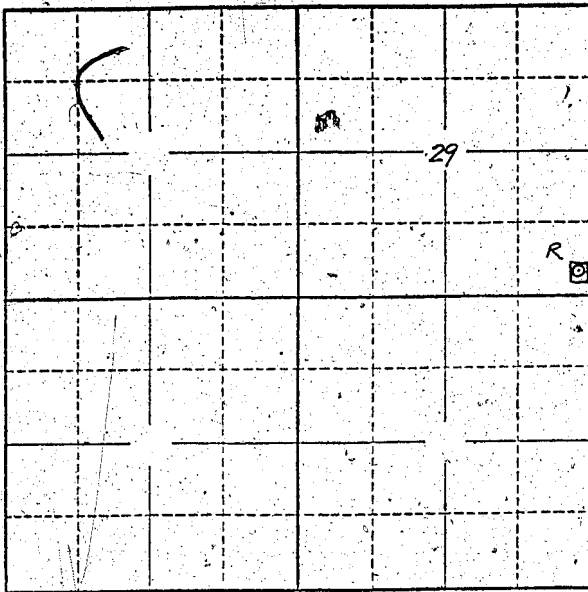

Locate well and acreage of irrigated land on plat.
Scale: 2" = 1 Mile

STATE OF OREGON

County of Washington } ss.

I, John R. ..., being first duly sworn, do hereby certify that I have read the foregoing Registration Statement and that all of the items therein contained are true to the best of my knowledge and belief.

[Signature]
(Signature of Registrant)

Subscribed and sworn to before me this 1st day of Aug, 1958

NOTARY PUBLIC FOR OREGON
MY COMMISSION EXPIRES JAN. 9, 1961
[Signature]
(Notary Public)

(SEAL)

CERTIFICATE OF REGISTRATION

STATE OF OREGON }
County of Marion } ss.

This is to certify that the foregoing Registration Statement was received in the office of the State Engineer on the 27th day of August, 1958, at 1:00 o'clock A. M. and has been duly recorded in said office in Book No. 16 of Registration Statements on page GR-4003

Witness my hand this 15th day of March, 1960

[Signature]
(State Engineer)

By _____
(Deputy)

GR. 4003

\$15.00