

# Registration Statement

## OF CLAIMANT OF RIGHT TO APPROPRIATE GROUND WATER

TO THE STATE ENGINEER OF OREGON:

I, JAMES W MERWIN, DOROTHY E MERWIN  
of 501 RIVER AVE. EUGENE ORE County of LONE  
(Mailing address)

State of OREGON, do hereby make application for a certificate of registration as evidence of a right to appropriate ground water.

1. Source from which water is withdrawn is Pump well  
(Flowing well, pump well, infiltration trench, or tunnel)

2. Location is: 3 mi North of Eugene, Ore  
(Approximate distance and direction from nearest city or town)

and is more particularly described as follows: 630 ft South of the NW corner of Lot H of Lone County Survey # 686 & Thence East 231 ft to the well  
(a) (Give distance and bearing to corner of section or other legal subdivision)

being within Potters Survey of Sec. 13, Twp. 17S, Rge. R4W  
(Smallest legal subdivision) (N. or S.) (E. or W.)

or (b) within limits of recorded platted property, town or city: Lone County Survey # 686  
in Lot H, Block --- of Potters Survey  
(Name of plat or addition)

County of Lone  
(If within city or town, give name)

3. Construction Work was begun on May 1935; was completed on May 1935  
(Date) (Date)

and the ground water claimed was first used for the purposes set out below on May 1935  
(Date)

since which time the water has been used Intermittently  
(Continuously or Intermittently)

from May 1935 to Present  
(Date) (Date) (20gpm)

4. Quantity of water claimed and used is 1200 gallons per hour; 22.5 acre feet per year.

5. Purpose or Purposes for which water is used Irrigation  
(Domestic, irrigation, municipal, manufacturing, industrial, etc.)

6. Description of Well: Depth 21 feet. Type Drilled  
(Dug or drilled)  
diameter 4" inches. Elevation of ground at well site 200 feet, mean sea level.  
(As near as known)  
Depth to water table 12 feet.

7. Capacity of Well: --- g.p.m. with --- feet drawdown.  
--- g.p.m. with --- feet drawdown.

Date of test 11.1 Test

If Flowing Well: Measured discharge --- g.p.m. on ---  
(Date)

Shut-in pressure at ground surface --- lbs. per sq. in. on ---  
(Date)

Water is controlled by ---  
(Cap, valve, etc.)





Township 17S Range 4W, W.M.  
North

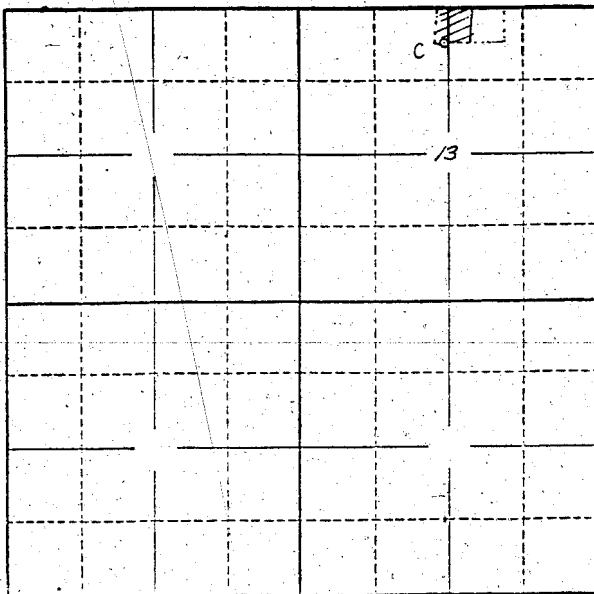

Locate well and acreage of irrigated land on plat.  
Scale: 2" = 1 Mile

STATE OF OREGON }  
County of Marion } ss.

I, JAMES W. MERWIN, being first duly sworn, do hereby certify that I have read the foregoing Registration Statement and that all of the items therein contained are true to the best of my knowledge and belief.

James W. Merwin  
(Signature of Registrant)

Subscribed and sworn to before me this 22 day of July, 1959

My commission expires Feb 11 1961 Walter G. Gray  
(Notary Public)

(SEAL)

**CERTIFICATE OF REGISTRATION**

STATE OF OREGON }  
County of Marion } ss.

This is to certify that the foregoing Registration Statement was received in the office of the State Engineer on the 17 day of August, 1959, at 12 o'clock A.M. and has been duly recorded in said office in Book No. 15 of Registration Statements on page GR:3550

Witness my hand this 15<sup>th</sup> day of September, 1959

Elvira A. Stanley  
(State Engineer)

\$1500

By \_\_\_\_\_ (Deputy)

GR 3550