

Registration Statement

OF CLAIMANT OF RIGHT TO APPROPRIATE GROUND WATER

TO THE STATE ENGINEER OF OREGON:

I, FRANK BARTHOLOMEW

of RTE 1, BOX 38, SPRINGFIELD

County of LANE

State of OREGON

, do hereby make application for a certificate of registration as evidence of a right to appropriate ground water.

1. Source from which water is withdrawn is PUMP WELL
(Flowing well, pump well, infiltration trench, or tunnel)

2. Location is: 4 MILES NORTHEAST OF SPRINGFIELD
(Approximate distance and direction from nearest city or town)

and is more particularly described as follows: 3,399.05 FT NORTH & 1,333.30 FT EAST

(a) OF SOUTHWEST CORNER OF FELIX SCOTT, JR. D. L. C. 451
(Give distance and bearing to corner of section or other legal subdivision)

being within SE¹/₄, SE¹/₄ & NE¹/₄, SE¹/₄ of Sec. 24, Twp. 17 S, Rge. 3 W
(Smallest legal subdivision) (N. or S.) (E. or W.)

or (b) within limits of recorded platted property, town or city:

in Lot _____, Block _____ of _____
(Name of plat or addition)

County of _____
(If within city or town, give name)

3. Construction Work was begun on SUMMER 1945; was completed on SUMMER 1945
(Date) (Date)

and the ground water claimed was first used for the purposes set out below on SUMMER 1945
(Date)

since which time the water has been used CONTINUOUSLY DURING SUMMERS (GROWING SEASON)
(Continuously or Intermittently)

from 1945 to 1952
(Date) (Date)

4. Quantity of water claimed and used is 90 gallons per minute; _____ acre feet per year. 12 RAINBIRD SPRINKLERS, 7 1/2 GALS/MINUTE/SPRINKLER

5. Purpose or Purposes for which water is used

CROP IRRIGATION

(Domestic, irrigation, municipal, manufacturing, industrial, etc.)

6. Description of Well: Depth 22 feet. Type DRIVEN
(Dug or drilled)

diameter 2 inches. Elevation of ground at well site 450 feet, mean sea level.
(As near as known)

Depth to water table 18 feet.

7. Capacity of Well: _____ g.p.m. with _____ feet drawdown.

_____ g.p.m. with _____ feet drawdown.

Date of test _____

If Flowing Well: Measured discharge _____ g.p.m. on _____

(Date)

Shut-in pressure at ground surface _____ lbs. per sq. in. on _____

(Date)

Water is controlled by _____

(Cap, Valve, etc.)

If log of well is not available, give name and address of driller.

11. Infiltration Trench: Covered or open

Dimensions: Length ft. Minimum depth ft. Maximum depth ft.

Bottom width ft. Discharge g.p.m. Date of test

12. Tunnel: Type of lining

Dimensions:

(Length, course, and cross sectional size)

Position of water bearing stratum with reference to portal of tunnel

Log of tunnel: (Preceding table for log of well may be used, if desired. Give footage from portal and character of materials, as pertinent.)

13. Pumping Equipment:

(a) Pump FAIRBANKS-MORSE Capacity g.p.m.

(Make, type and size)

(b) Motor FAIRBANKS-MORSE $7\frac{1}{2}$ HP

(Type and horsepower)

14. Location of area irrigated or to be irrigated, or place of use if for purposes other than irrigation.

Township North or South	Range E. or W. of Willamette Meridian	Section	Forty-acre Tract	Number Acres To Be Irrigated	Date of Reclamation
17 S	3 ^d W	24	NE $\frac{1}{4}$, SE $\frac{1}{4}$	6.71	1945
17 S	3 W	24	SE $\frac{1}{4}$, SE $\frac{1}{4}$	5.27	"
				<u>11.98</u>	
			TOTAL	11.98	

15. If the ground water supply is supplemental to an existing water supply, identification of any application for a permit, permit, certificate or adjudicated right to appropriate water made or held by the registrant.

Township 17 S Range 3 W, W.M.
North

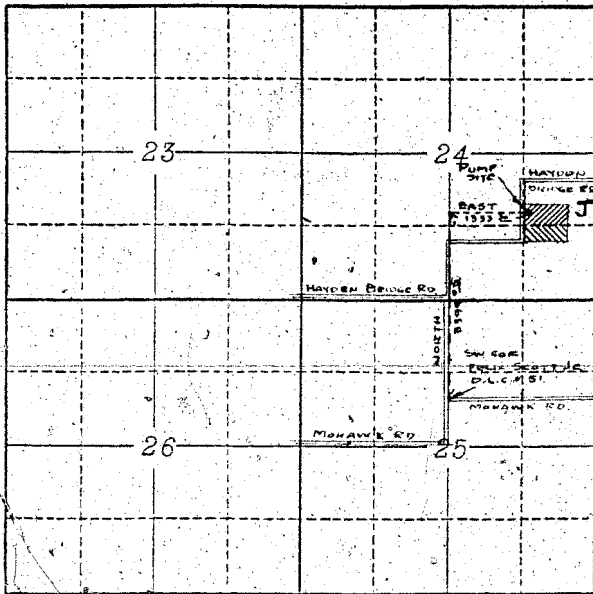

Locate well and acreage of irrigated land on plat.
Scale: 2" = 1 Mile

STATE OF OREGON

County of LANE } ss.

I, FRANK BARTHOLOMEW, being first duly sworn, do hereby certify that I have read the foregoing Registration Statement and that all of the items therein contained are true to the best of my knowledge and belief.

Frank W. Bartholomew
(Signature of Registrant)

Subscribed and sworn to before me this 1st day of AUGUST, 19 58.

My commission expires AUGUST 23, 1960 A. Margaret Hutchinson
(Notary Public)

(SEAL)

CERTIFICATE OF REGISTRATION

STATE OF OREGON

County of Marion } ss.

This is to certify that the foregoing Registration Statement was received in the office of the State Engineer on the 4th day of August, 1958, at 8:00 o'clock A. M. and has been duly recorded in said office in Book No. 15 of Registration Statements on page GR-3556

Witness my hand this 15th day of September, 19 59.

Clara A. Atkinson
(State Engineer)

By _____
(Deputy)

\$ 15.00

GR. 3556