

Registration Statement

OF CLAIMANT OF RIGHT TO APPROPRIATE GROUND WATER

TO THE STATE ENGINEER OF OREGON:

I, Bunnell Olson
of Star Route, Newberg County of Marion
State of Oregon do hereby make application for a certificate of registration as evidence
of a right to appropriate ground water.

1. Source from which water is withdrawn is # 2 Well
(Flowing well, pump well, infiltration trench, or tunnel)

2. Location is: 4 miles south of Newberg
(Approximate distance and direction from nearest city or town)

and is more particularly described as follows:

(a) 1000' S & 200' E from NW 1/4 corner Section 6
(Give distance and bearing to corner of section or other legal subdivision)
being within NW 1/4 NE 1/4 of Sec. 6, Twp. 4S Rge. 2W
(Smallest legal subdivision) (N. or S.) (E. or W.)

or (b) within limits of recorded platted property, town or city:
in Lot _____, Block _____ of _____
(Name of plat or addition)

_____ County of _____
(If within city or town, give name)

3. Construction Work was begun on March, 1952; was completed on April, 1952
(Date) (Date)
and the ground water claimed was first used for the purposes set out below on June, 1952
(Date)
since which time the water has been used Intermittently
(Continuously or Intermittently)
from June 1 to Oct 31
(Date) (Date)

4. Quantity of water claimed and used is 2.00 gallons per minute; _____ acre
feet per year.

5. Purpose or Purposes for which water is used Irrigation of crops
(Domestic, irrigation, municipal, manufacturing, industrial, etc.)

6. Description of Well: Depth 36 feet. Type Drill
(Dug or drilled)
diameter 10 inches. Elevation of ground at well site _____ feet, mean sea level.
(As near as known)
Depth to water table 3 feet.

7. Capacity of Well: 2.00 g.p.m. with 2.0 feet drawdown.
_____ g.p.m. with _____ feet drawdown.

Date of test July, 1952

If Flowing Well: Measured discharge _____ g.p.m. on _____
(Date)

Shut-in pressure at ground surface _____ lbs. per sq. in. on _____
(Date)

Water is controlled by _____
(Cap, valve, etc.)

If log of well is not available, give name and address of driller.

11. Infiltration Trench: Covered or open

Dimensions: Length ft. Minimum depth ft. Maximum depth ft.
 Bottom width ft. Discharge g.p.m. Date of test

12. Tunnel: Type of lining

Dimensions:
(Length, course, and cross sectional size)
 Position of water bearing stratum with reference to portal of tunnel

Log of tunnel: (Preceding table for log of well may be used, if desired. Give footage from portal and character of materials, as pertinent.)

13. Pumping Equipment:

(a) Pump Fairbanks-Morse Centrifugal Capacity 250 g.p.m.
(Make, type and size)
 (b) Motor Fairbanks-Morse 10 Horsepower
(Type and horsepower)

14. Location of area irrigated or to be irrigated, or place of use if for purposes other than irrigation.

Township North or South	Range E. or W. of Willamette Meridian	Section	Forty-acre Tract	Number Acres To Be Irrigated	Date of Reclamation
4S	2W	6	NE 1/4 NE 1/4	15	1952
"	"	6	NW 1/4 NE 1/4	20	"
				35	"

15. If the ground water supply is supplemental to an existing water supply, identification of any application for a permit, permit, certificate or adjudicated right to appropriate water made or held by the registrant.

Township 3445 Range 2W, W.M.
North

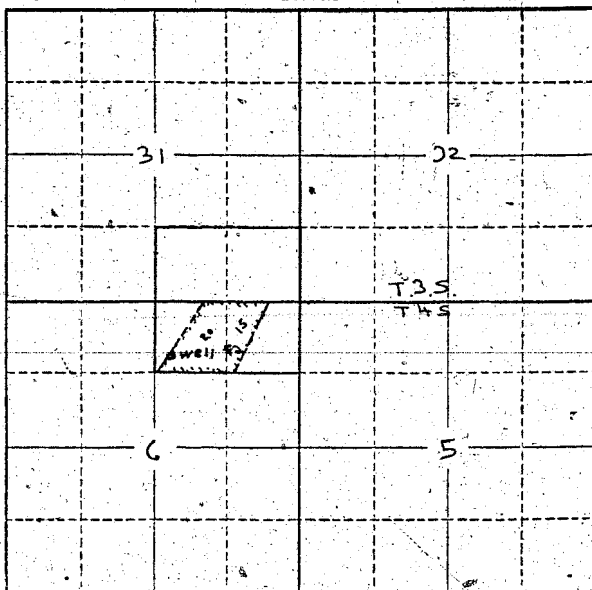

Locate well and acreage of irrigated land on plat.

Scale: 2" = 1 Mile

STATE OF OREGON

County of Marion } ss.

I, Burnell Olson, being first duly sworn, do hereby certify that I have read the foregoing Registration Statement and that all of the items therein contained are true to the best of my knowledge and belief.

Burnell Olson
(Signature of Registrant)

Subscribed and sworn to before me this 1st day of August, 1958

My commission expires Feb 6, 1959

Raymond S. Smith
(Notary Public)

(SEAL)

CERTIFICATE OF REGISTRATION

STATE OF OREGON

County of Marion } ss.

This is to certify that the foregoing Registration Statement was received in the office of the State Engineer on the 4th day of August, 1958, at 9:00 o'clock A.M. and has been duly recorded in said office in Book No. 15 of Registration Statements on page GR-3567

Witness my hand this 15th day of September, 1959

\$15.75

Stuart A. Stanley
(State Engineer)

By _____ (Deputy)

GR 3567