

RECEIVED
STATE ENGINEER

Registration Statement

OF CLAIMANT OF RIGHT TO APPROPRIATE GROUND WATER

TO THE STATE ENGINEER OF OREGON:

I, CECIL M. CHASE
of R+2 Bx 379 SPRINGFIELD County of LANE
(Mailing address)
State of ORE, do hereby make application for a certificate of registration as evidence of a right to appropriate ground water.

1. Source from which water is withdrawn is PUMP WELL
(Flowing well, pump well, infiltration trench, or tunnel)

2. Location is: one mile west of water table
(Approximate distance and direction from nearest city or town)

and is more particularly described as follows: 400 ft. South & 300 ft. east from N 1/4 corner Section 29.

(a) SEE MAP FOR FIGURES
(Give distance and bearing to corner of section or other legal subdivision)

being within NW 1/4 of NE 1/4 of Sec. 29, Twp. 17 S, Rge. 1 W
(Smallest legal subdivision) (N. or S.) (E. or W.)

or (b) within limits of recorded platted property, town or city:

in Lot _____, Block _____ of None
(Name of plat or addition)

County of LANE
(If within city or town, give name)

3. Construction Work was begun on July 1952; was completed on July 1952
(Date) (Date)

and the ground water claimed was first used for the purposes set out below on July 1952
(Date)

since which time the water has been used _____
(Continuously or intermittently)

from MAY to Oct.
(Date) (Date)

4. Quantity of water claimed and used is 36 gallons per minute; 2.5 acre feet per year.

5. Purpose or Purposes for which water is used _____

IRRIG

(Domestic, irrigation, municipal, manufacturing, industrial, etc.)

6. Description of Well: Depth 20 feet. Type DROVE
(Dug or drilled)

diameter 2 inches. Elevation of ground at well site 520 feet, mean sea level.
(As near as known)

Depth to water table 12 feet.

7. Capacity of Well: _____ g.p.m. with _____ feet drawdown.

_____ g.p.m. with _____ feet drawdown.

Date of test NO TEST

If Flowing Well: Measured discharge _____ g.p.m. on _____ (Date)

Shut-in pressure at ground surface _____ lbs. per sq. in. on _____ (Date)

Water is controlled by _____
(Cap, valve, etc.)

Township 17 S Range 1 W W.M.
North

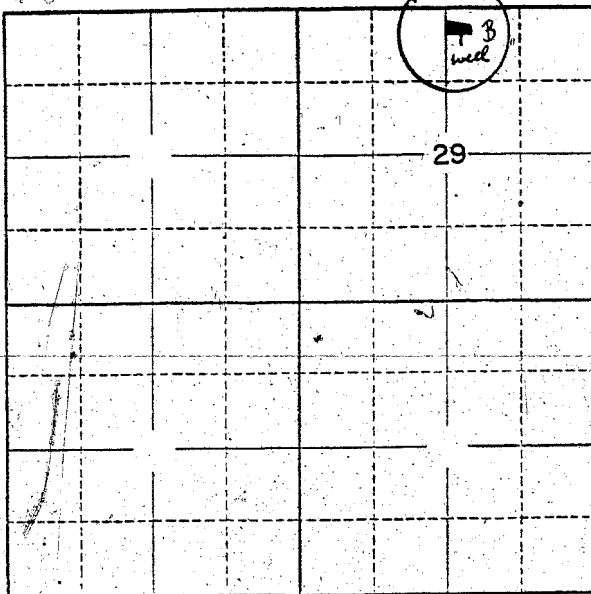

Locate well and acreage of irrigated land on plat.

Scale: 2" = 1 Mile

all land except where building are located

STATE OF OREGON

County of Lane } ss.

I, Cecil M. Chase, being first duly sworn, do hereby certify that I have read the foregoing Registration Statement and that all of the items therein contained are true to the best of my knowledge and belief.

Cecil M. Chase
(Signature of Registrant)

Subscribed and sworn to before me this 31 day of July, 1958

My commission expires May 14 - 1960
Harvey R. Wilton
(Notary Public)

(SEAL)

CERTIFICATE OF REGISTRATION

STATE OF OREGON

County of Marion } ss.

This is to certify that the foregoing Registration Statement was received in the office of the State Engineer on the 4 day of August, 1958, at 8:00 o'clock A. M. and has been duly recorded in said office in Book No. 15 of Registration Statements on page GR-3571

Witness my hand this 15th day of September, 1959.

Lewis A. Stanley
(State Engineer)

\$15.00

By _____
(Deputy)