

HOUSE #1
2295

Registration No. GR 3976

Certificate No. GR 3591

Registration Statement

OF CLAIMANT OF RIGHT TO APPROPRIATE GROUND WATER

TO THE STATE ENGINEER OF OREGON:

I, V.O. WEATHERS

of RT. 1 Box 57 INDEPENDENCE County of POLK

State of OREGON do hereby make application for a certificate of registration as evidence of a right to appropriate ground water.

1. Source from which water is withdrawn is PUMP WELL
(Flowing well, pump well, infiltration trench, or tunnel)
2. Location is: 7 MI SOUTH EAST OF INDEPENDENCE
(Approximate distance and direction from nearest city or town)

and is more particularly described as follows:

(a) 0.22 chains N. 24° 18' E. from S.W. CORNER SECTION 6
(Give distance and bearing to corner of section or other legal subdivision)

being within SW 1/4 - SW 1/4 of Sec. 6, Twp. 2 S., Rge. 3W
(Smallest legal subdivision) (N. or S.) (E. or W.)

or (b) within limits of recorded platted property, town or city:

in Lot _____, Block _____ of _____
(Name of plat or addition)

County of POLK
(If within city or town, give name)

3. Construction Work was begun on 1940; was completed on 1940
(Date) (Date)

and the ground water claimed was first used for the purposes set out below on 1940
(Date)

since which time the water has been used intermittently during season
(Continuously or intermittently)

from 1940 to 1958
(Date) (Date)

4. Quantity of water claimed and used is 750 gallons per minute; _____ acre feet per year.

5. Purpose or Purposes for which water is used

IRRIGATION
(Domestic, irrigation, municipal, manufacturing, industrial, etc.)

6. Description of Well: Depth 38 feet. Type DRILLED
(Dug or drilled)

diameter 10 inches. Elevation of ground at well site _____ feet, mean sea level.
(As near as known)

Depth to water table _____ feet.

7. Capacity of Well: 750 g.p.m. with 6 feet drawdown.

_____ g.p.m. with _____ feet drawdown.

Date of test July 19 1957

If Flowing Well: Measured discharge _____ g.p.m. on _____
(Date)

Shut-in pressure at ground surface _____ lbs. per sq. in. on _____
(Date)

Water is controlled by _____
(Cap. valve, etc.)

Township 9S Range 3W W.M. North

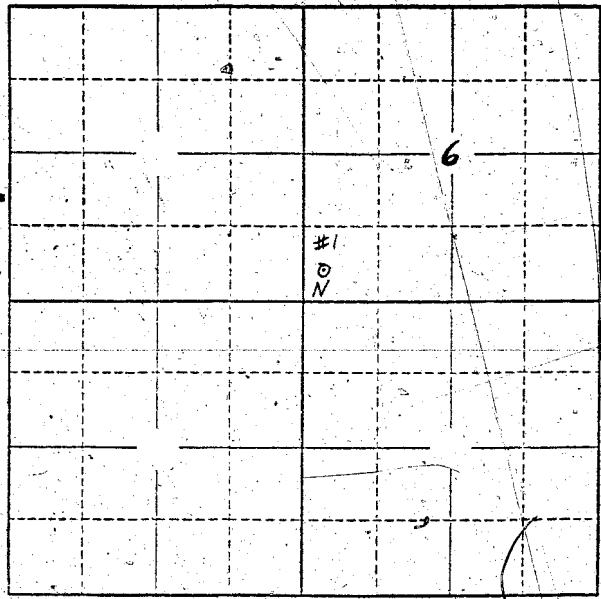

Locate well and acreage of irrigated land on plat.
Scale: 2" = 1 Mile

STATE OF OREGON }
County of Marion } ss.

I, V. O. Weathers, being first duly sworn, do hereby certify that I have read the foregoing Registration Statement and that all of the items therein contained are true to the best of my knowledge and belief.

V. O. Weathers
(Signature of Registrant)

Subscribed and sworn to before me this 4th day of August, 19 58

My Commission Expires May. 25, 1959

~~My~~ commission expires

Robert L. ...
(Notary Public)

(SEAL)

CERTIFICATE OF REGISTRATION

STATE OF OREGON }
County of Marion } ss.

This is to certify that the foregoing Registration Statement was received in the office of the State Engineer on the 4 day of August, 1958, at 11:45 o'clock A.M. and has been duly recorded in said office in Book No. 15 of Registration Statements on page GR-3591

Witness my hand this 15th day of September, 19 59

Lewis A. Stanley
(State Engineer)

\$ 22.95

By _____
(Deputy)

GR 3591