

Registration No. GR-3987

Certificate No. GR-3598

Registration Statement

OF CLAIMANT OF RIGHT TO APPROPRIATE GROUND WATER

TO THE STATE ENGINEER OF OREGON:

I, Ired A. Battorff
 of PROSSER RFD #1 County of BENTON
(Mailing address)
 State of WASHINGTON, do hereby make application for a certificate of registration as evidence of a right to appropriate ground water.

1. Source from which water is withdrawn is PUMP WELL
(Flowing well, pump well, infiltration trench, or tunnel)
2. Location is: 3 mi. N.N.W. MILTON-FREE WATER
(Approximate distance and direction from nearest city or town)

and is more particularly described as follows:

(a) 70' E (East) of Southeast corner NW NE NE
(Give distance and bearing to corner of section or other legal subdivision)
 being within 40 acres of Sec. 33, Twp. 6 N, Rge. 35 E
(Smallest legal subdivision) (N. or S.) (E. or W.)
 or (b) within limits of recorded platted property, town or city:
 in Lot _____, Block _____ of _____
(Name of plat or addition)
 County of Umatilla
(If within city or town, give name)

3. Construction Work was begun on 1924; was completed on 1925
(Date) (Date)
 and the ground water claimed was first used for the purposes set out below on 1925
(Date)
 since which time the water has been used Continuously
(Continuous or Intermittently)
 from 1925 to 1953
(Date) (Date)

4. Quantity of water claimed and used is 200 gallons per minute; 160 acre feet per year.

5. Purpose or Purposes for which water is used Irrigation of farm land
(Domestic, irrigation, municipal, manufacturing, industrial, etc.)

6. Description of Well: Depth 27 feet. Type Dug and drilled
(Dug or drilled)
 diameter 9" 8" 24" inches. Elevation of ground at well site _____ feet, mean sea level.
(As near as known)
 Depth to water table 40 feet.

7. Capacity of Well: 200 g.p.m. with 21 feet drawdown.
 _____ g.p.m. with _____ feet drawdown.

Date of test _____

If Flowing Well: Measured discharge _____ g.p.m. on _____
(Date)

Shut-in pressure at ground surface _____ lbs. per sq. in. on _____
(Date)

Water is controlled by _____
(Cap. valve, etc.)

8. Casing: (Give diameter, commercial specifications and depth below ground surface of each casing size.)

..... inch diameter from to feet
 inch diameter from to feet
 inch diameter from to feet
 inch diameter from to feet

Describe and show depth of shoe, plug, adapter, liner or other details:

.....

9. Perforated Casings or Screens:

..... from to
(Number per foot and size of perforations, or describe screen)
 from to
 from to
 from to

10. Log of Well: (Describe each stratum or formation clearly, indicate if water bearing, and give thickness and depth as indicated.)

MATERIAL	Thickness (Feet)	Depth to Bottom (Feet)

If log of well is not available, give name and address of driller. _____

this information

11. Infiltration Trench: Covered or open _____

Dimensions: Length _____ ft. Minimum depth _____ ft. Maximum depth _____ ft.

Bottom width _____ ft. Discharge _____ g.p.m. Date of test _____

12. Tunnel: Type of lining _____

Dimensions: _____
(Length, course, and cross sectional size)

Position of water bearing stratum with reference to portal of tunnel: _____

Log of tunnel: (Preceding table for log of well may be used, if desired. Give footage from portal and character of materials, as pertinent.)

13. Pumping Equipment:

(a) Pump *Worthington 3HP CENTRIFUGAL* Capacity *200* g.p.m.
(Make, type and size)

(b) Motor *U. S. Electric - 3 HP*
(Type and horsepower)

14. Location of area irrigated or to be irrigated, or place of use if for purposes other than irrigation.

Township North or South	Range E. or W. of Wilmamette Meridian	Section	Forty-acre Tract	Number Acres To Be Irrigated	Date of Reclamation
<i>6N</i>	<i>35E</i>	<i>33</i>	<i>10 acres NW NE NE</i>	<i>20 acres</i>	<i>Sept 14 12 - 1920</i>

15. If the ground water supply is supplemental to an existing water supply, identification of any application for a permit, permit, certificate or adjudicated right to appropriate water made or held by the registrant.

Plant

Township 6N Range 35E W.M.
North

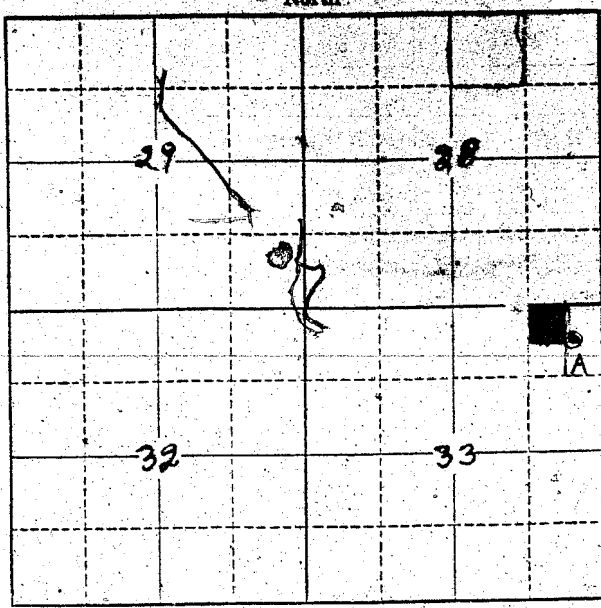

Locate well and acreage of irrigated land on plat.
Scale: 2" = 1 Mile

STATE OF OREGON

County of Washington } ss.

I, Ired O. Battorff, being first duly sworn, do hereby certify that I have read the foregoing Registration Statement and that all of the items therein contained are true to the best of my knowledge and belief.

Ired Battorff
(Signature of Registrant)

Subscribed and sworn to before me this 1st day of August, 1958

My commission expires Oct 4, 1960
W. J. Peterson
(Notary Public)

(SEAL)

CERTIFICATE OF REGISTRATION

STATE OF OREGON

County of Marion } ss.

This is to certify that the foregoing Registration Statement was received in the office of the State Engineer on the 4th day of August, 1958, at 2:00 o'clock A. M. and has been duly recorded in said office in Book No. 15 of Registration Statements on page 2-3598

Witness my hand this 15th day of September, 1959

Lewis A. Stanley
(State Engineer)

By _____
(Deputy)

\$15.00